

LAT. 3, SUB. 18, S. S. NO. 22
 W. B. CARTER CONST. CO. INC.
 PROJ. NO. C 27-12 BK U. K. # 8
 AUG. 4, 1967

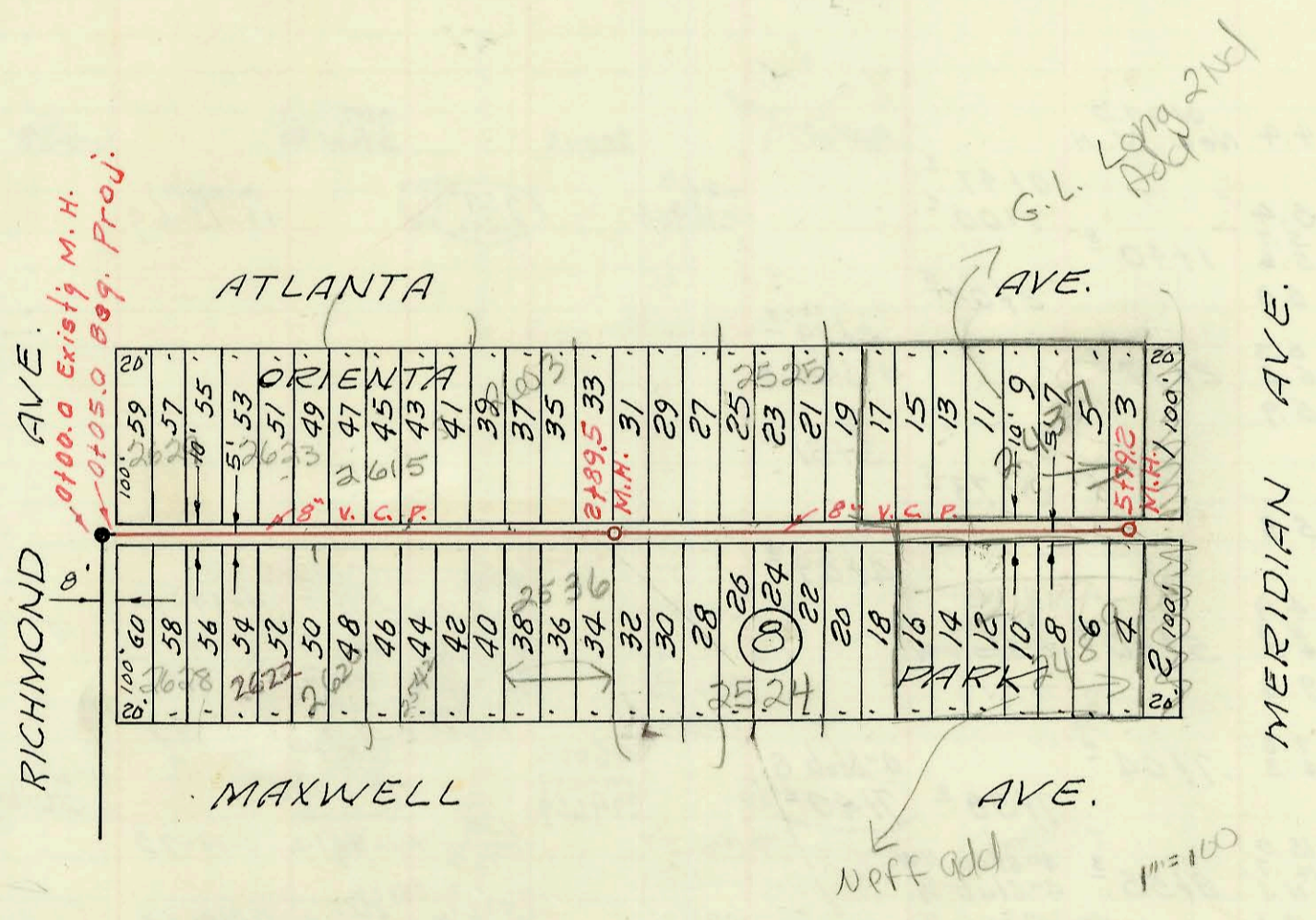

LAT. 1, SUB. 18, S. S. NO. 22
 W. B. CARTER CONST. CO. INC.
 PROJ. NO. C 27-10 BK U. K. # 2
 AUG. 7, 1967

SER 2001 01194 5115161 2615 w Atlanta - Right way Plg:

CONSTRUCTION RECORD

SERVICE RECORD

STATION	ELEVATION		Depth	MANHOLE	4-INCH "Y" BRANCHES		No. of Permit		House Number		DATE OF PERMITS	
	Ground	Grade			North West	South East	North West	South East	North West	South East	North West	South East
0+00 0+05 ^e	100.8	96.35	4.4	0+00.0 Exist'g M.H.								
	Beq.	PROJ.										
1+00	100.8	96.55	4.2		0+54 ^e 0+97 ^e		102463 24109	3541	2625 Crawford	2628 Dallas	1-23-81 7-25-67	6-23-81
2+00	100.8	96.75	4.0		1+77 ^e 2+26 ^e 2+75 ^e		21426 108410 22388		2623 Crawford 2622 Dallas		9-7-88	9-18-80
3+00	100.6 100.7	96.93 96.95	3.7 3.7	2+89 ^e	3+10.6 ^e 3+56 ^e 3+84.6 ^e		3540		2611 Crawford 2601 Dallas		5-21-68	1-11-89
4+00	100.6	97.15	3.4		4+30 ^e 4+43 ^e 4+79 ^e		4065	22322	2577 Crawford	2520 Dallas	9-2-81	12-30-88
5+00	101.1	97.35	3.7		5+21.9 ^e 5+40 ^e		4969	4969	2523 Crawford 2512 Dallas		9-22-67	12-28-81
	100.7	97.53	3.2	5+89 ^e			4969	4969	2509 Crawford 2507 Dallas	2515 Dallas	7-13-77	12-28-81
0+00 0+05 ^e	101.8	98.32	3.5	0+00.0 Exist'g MH								
	Beq.	PROJ.										
1+00	101.6	98.47	3.1		0+29 ^e 0+64.5 ^e 0+79 ^e		270104	270103	2629 Atlanta	2628 Maxwell	1-12-79	1-12-79
2+00	101.9	98.62	3.3		1+17 ^e 1+71 ^e 2+00 ^e 2+34 ^e 2+78 ^e		20105	2052 2838 13414	2623 Atlanta	2620 Maxwell	1-13-79	7-15-83
3+00	101.8	98.76	3.0	2+89 ^e			23591		2603 Atlanta		12-24-89	4-8-85
4+00	101.9	98.92	3.0		3+22 ^e 3+82 ^e 3+93.3 ^e 4+50 ^e		49823		2528 Maxwell		6-24-70	
5+00	102.1	99.07	3.0		5+15 ^e 5+23.6 ^e 5+66 ^e		11799		2524 Maxwell		7-26-79	7-26-79
	102.2	99.19	3.0	5+79 ^e			45527 19929 4577		2437 Maxwell	2438 Maxwell	4-5-85 11-5-88	8-17-84

N/C 2001-01194-5/15/01-2615 WATLANTA-Right Way Pibg-4"SCH40-4" CITY TAP-165' E of MH 0100(1+65) Trap installed

LAT. 1, SUB. 18, S. S. NO. 22

2601 Crawford was Never connected
19973-2618 W. Dallas - 11-30-87 4" SDR 35 city tap 24.6 ft E of W. Prop line No other cd.