

Ext. of S.S. #23 in 29th St.  
Built by Mid-States Const. Co.  
Booked 1-2-74 from I.H. 82  
Proj. No. DBKJ 573032  
on map

Scale 1"=150'

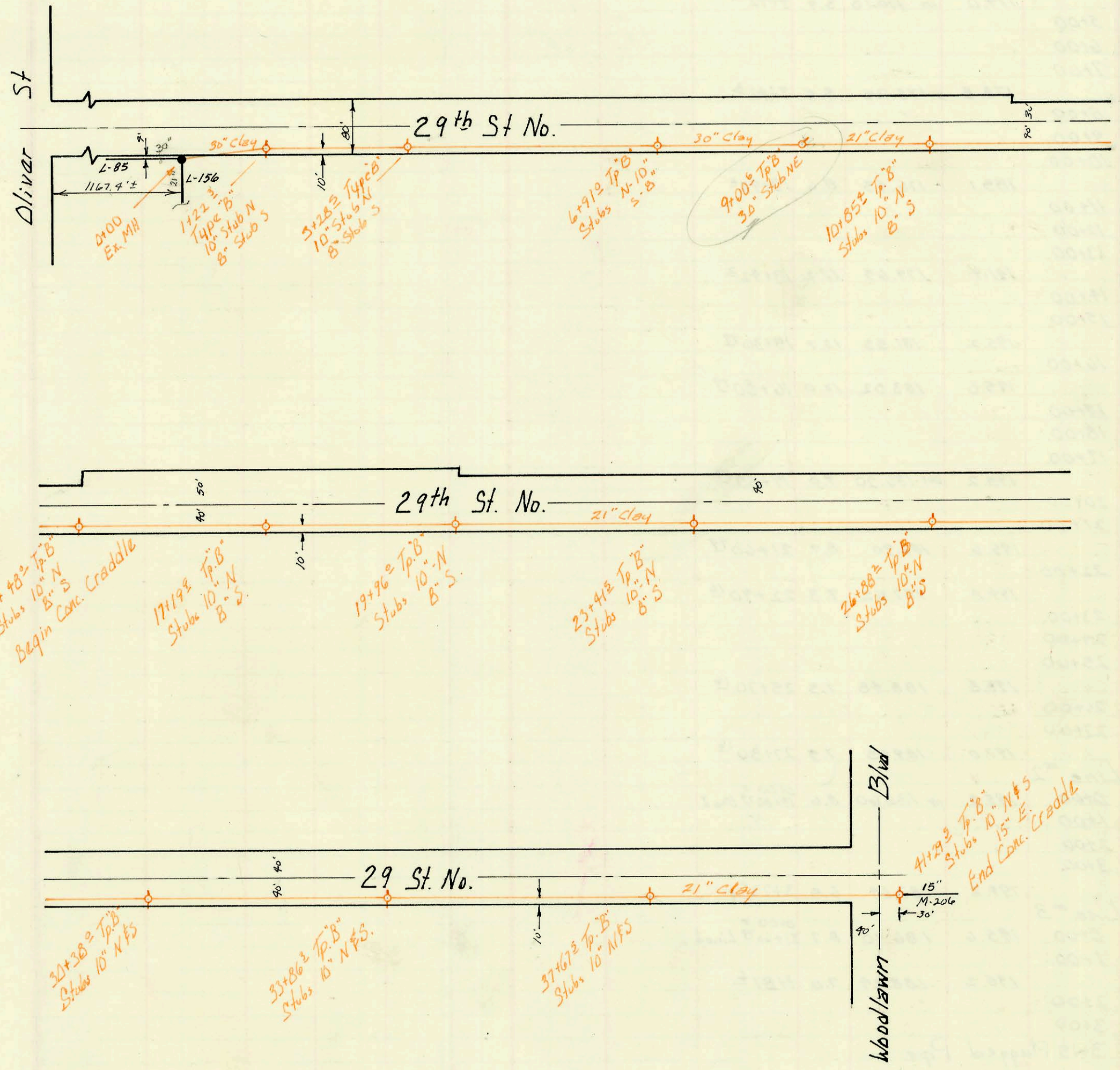

N/C 5015 E 29th N - Released by Tony DeLiceo before plans in  
 our office. No Record of Connection - 1/3/91 - 6" main PVC;  
 4-6" C.O. w/tees; M.H. Stub in front; Tee into gypm 1-4" line,  
 North  
 285' S Tee on 17.6 ft soft CO - S.E. lin  
 C Tee on 6ft N of CO - N.E. lin

CONSTRUCTION RECORD					SERVICE RECORD							
STATION	ELEVATION		Depth	MANHOLE	4-INCH "Y" BRANCHES		No. of Permit		House Number		DATE OF PERMITS	
	Ground	Grade			North West	South East	North West	South East	North West	South East	North West	South East
<i>Extension of S.S. #23 in 29th St</i>												
0+00	160.5	143.45	17.0	Exist								
1+00	160.3	143.65	16.6									
	160.5	In 143.69 Out 143.79	16.8 16.7	1+22 <sup>3</sup>								
2+00	159.6	143.95	15.6									
3+00	161.2	144.15	17.0									
	161.0	144.21	16.8	3+28 <sup>E</sup>								
4+00	160.2	144.35	15.8									
5+00	160.5	144.55	15.9									
6+00	161.8	144.75	17.0									
	162.3	144.94	17.4	6+91 <sup>2</sup>								
7+00	162.4	144.95	17.4									
8+00	162.6	145.15	17.4									
9+00	163.5	145.35	18.1									
	163.0	out 149.05	13.9	9+00 <sup>4</sup>								
10+00	164.0	149.21	14.8									
	165.1	149.35	15.7	10+85 <sup>E</sup>								
11+00	165.3	149.37	15.9									
12+00	166.1	149.53	16.6									
13+00	167.4	149.69	17.7									
14+00	168.7	149.85	18.8									
	169.5	149.92	19.6	14+48 <sup>2</sup>								
15+00	171.2	150.01	21.2									
16+00	171.9	150.17	21.7									
17+00	172.8	150.33	22.5									
	173.0	150.36	22.6	17+19 <sup>2</sup>								
18+00	173.8	150.49	23.3									
19+00	174.6	150.65	23.9									
	175.6	150.80	24.8	19+96 <sup>2</sup>								
20+00												
21+00	176.4	150.96	25.4									
22+00	176.6	151.13	25.5									
23+00	177.1	151.29	26.8									
	177.5	151.36	26.1	23+41 <sup>E</sup>								
24+00	177.7	151.45	26.2									
25+00	178.0	151.61	26.4									
26+00	178.5	151.77	26.7									
	179.4	151.91	27.5	26+88 <sup>2</sup>								
27+00												
28+00	180.1	152.09	28.0									
29+00	179.7	152.25	27.4									
30+00	180.4	152.41	28.0									
	179.9	152.47	27.4	30+38 <sup>2</sup>								
31+00	179.4	152.57	26.8									
32+00	179.5	152.73	26.8									
33+00	179.6	152.89	26.7									
	179.4	153.03	26.4	33+86 <sup>3</sup>								
34+00												
35+00	178.9	153.21	25.7									
36+00	178.4	153.37	25.0									
37+00	177.7	153.53	24.2									
	177.2	153.64	23.6	37+67 <sup>E</sup>								
38+00	177.4	153.69	23.7									
39+00	176.9	153.85	23.0									
40+00	175.5	154.01	21.5									
41+00	174.3	154.17	22.1									
	175.2	154.22	21.0	41+29 <sup>E</sup>								
<i>Cont. From page M-210</i>												
<i>Lat 31 Main SA WIS</i>												
<i>Line 6</i>												
0+00	174.0	164.43	9.6									
	172.5	164.72	7.8	1+05 <sup>2</sup>								
2+00	172.8	164.91	7.9									
3+00	173.1	165.11	8.0									
	out 172.6 in 172.8	165.20 165.30	7.4 7.5	3+45 <sup>2</sup>								
4+00	172.4	165.47	6.9									
5+00	172.3	165.77	6.5									
6+00	173.1	166.07	7.0									
	173.0	166.21	6.8	6+46 <sup>E</sup>								
<i>Private San. Sew. Phillips Petroleum (on M-210)</i>												
0+00		158.56		0+00 Exist								
1+00	167.6	158.96	8.6									
2+00	167.1	159.36	7.7									
	166.9	out 157.47 in 157.57	7.4	2+27 <sup>2</sup>								
	166.9	159.69	7.2	2+55 <sup>2</sup>								
<i>50 C46629 - Imp. Sewer Conn. 141 S. Rock Rd. - 9/12/74</i>												

175 454 C64644 115 Rock Rd 11-16-77

mt Jap C42564 141 S. Rock Rd 12-4-73

1+12.5 C60979 7700 S. (6000 ft) Kellogg (6000 ft) 5-4-77

Std out of mt C42879C65957 7960 F 7900 S Kellogg Kellogg 12-27-73 4-11-78

Cont. From page M-210

Private San. Sew.

50 C46629 - Imp. Sewer Conn. 141 S. Rock Rd. - 9/12/74