

LAT. 38, MAIN 1, S.W. INTERCEPTOR, SEWER  
 PROJ. NO. DBKL575001  
 BUILT BY W. B. CARTER CONST. CO.  
 BOOKED 9-23-75 BOOK NO. 256-Y

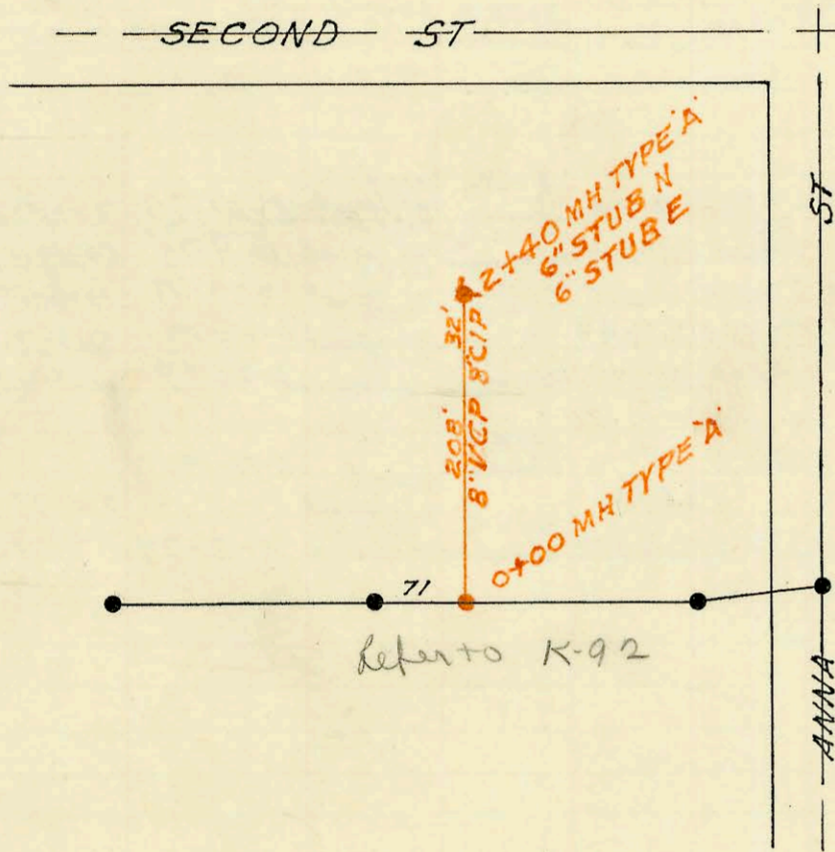

DODGE SCHOOL SAN SEWER  
 BUILT BY: MID STATES CONST. CO.  
 PROJ. N<sup>o</sup> DBKW 705030  
 BOOKED 9-30-75 FROM PLAN

SCALE 1"=150'

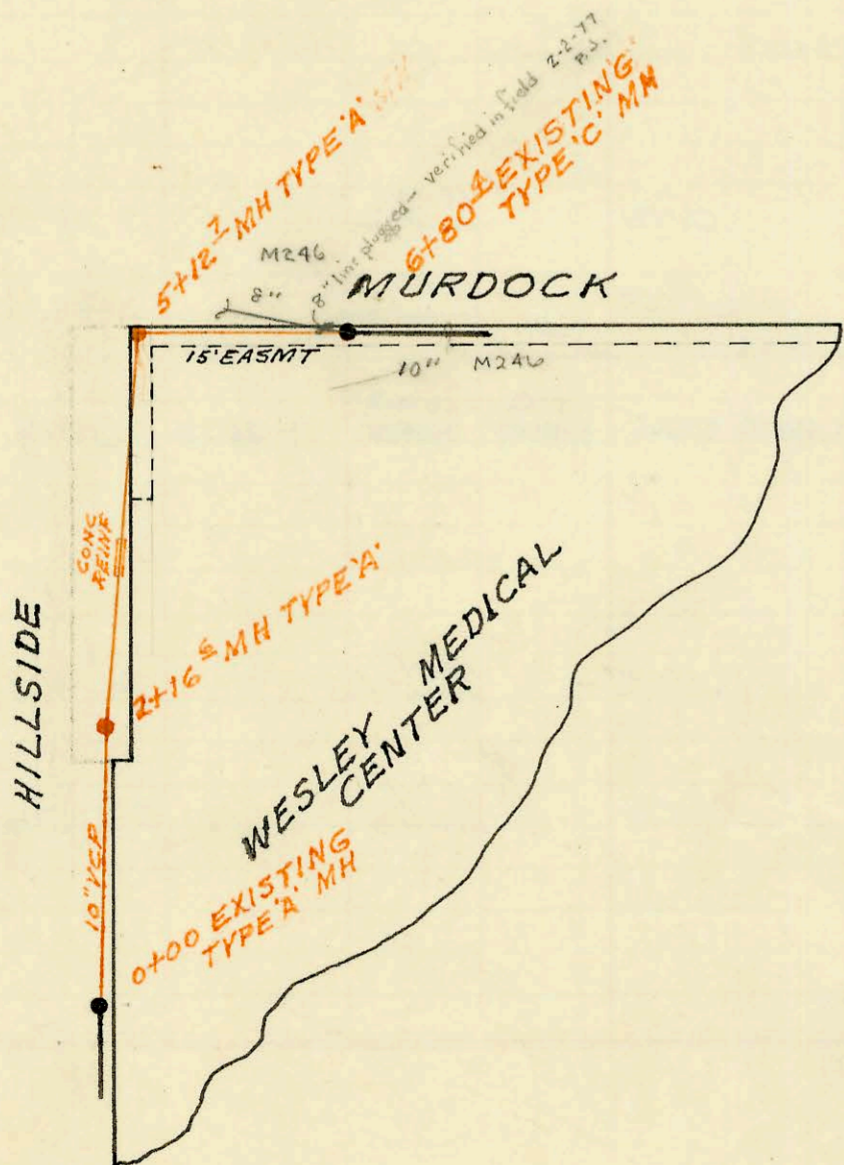

LAT 2 WESLEY INTERCEPTOR SEWER  
 BUILT BY: UTILITY CONT. INC.  
 PROJ. N<sup>o</sup> DBKL574082  
 BOOKED 10-1-75 FROM 1H72

SCALE 1"=150'

