

LATERAL 345, SOUTHWEST INTERCEPTOR SEWER
 PROJECT NO. 468-82462 (742247)
 BUILT BY UTILITY CONTRACTORS
 BOOKED 10/27/95 PER PLAN

SCALE: 1" = 100'

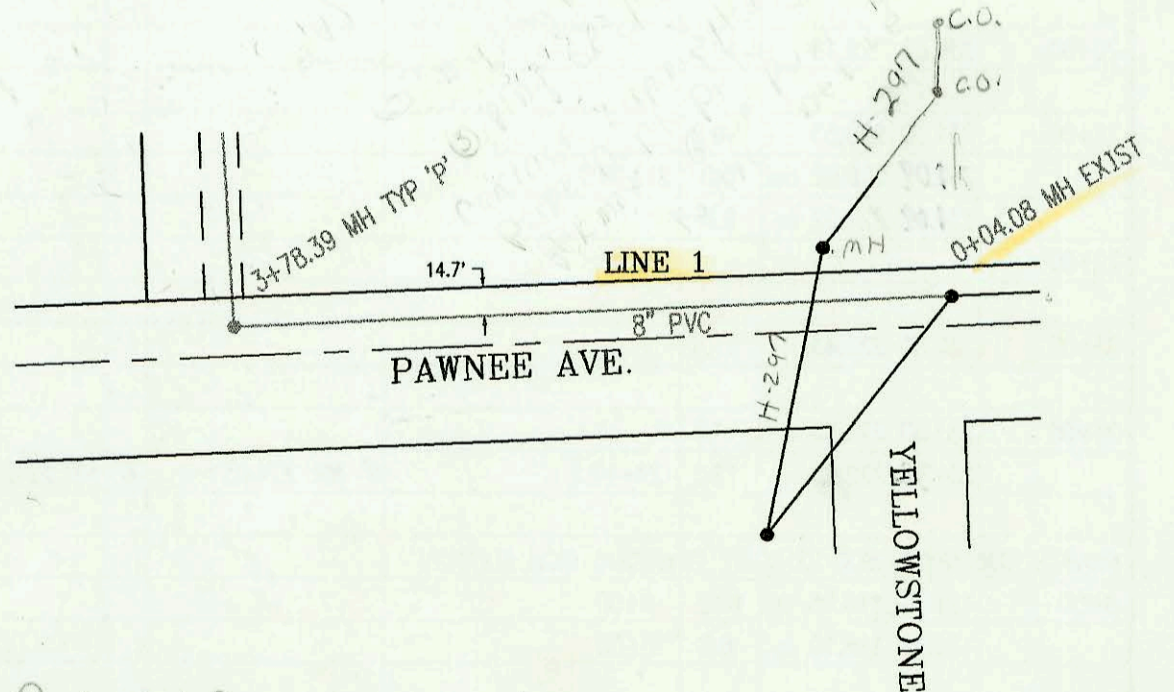

Drainlayer must

16010 w Pawnee

1. Contact Larry Hoetmer, Park Dept. 268-4179 48 hrs before digging.
2. Service line must cross in private easement. Provided
3. Equity Fee 500.00 Must be paid to water Dept
4. IN Lieu Fee Main Lat 3,697.92 must be paid in OCT
5. Drainlayer must avoid 6" locust tree. If tree harmed, homeowner must replace.
6. Plug has been brought up to code by Lic. plumber.

Private Easement
 See film 10/15/95

10122 must extend
 Refer to Julianne
 10106 must extend
 Fee in lieu of main & lateral Ass'ps 3,697.92 Paid 12/12/00
 20' UTILITY EASEMENT BY SEPARATE INSTR.

10010
 Fee in lieu of main & lateral Ass'ps 3,697.92 Paid 12/12/00
 20' UTILITY EASEMENT BY SEPARATE INSTR.

CONSTRUCTION RECORD						SERVICE RECORD						
STATION	ELEVATION		DEPTH	MANHOLE	4-INCH "Y" BRANCHES		No. of Permit		House Number		DATE OF PERMITS	
	GROUND	GRADE			North West	South East	North West	South East	North West	South East	North West	South East
LAT 345, SOUTHWEST INTERCEPTOR												
LINE 1	0+04.08	119.00	109.01	10.0	0+04.08 EXIST							
	1+00	118.90	109.39	9.5								
	2+00	119.50	109.79	9.7								
	3+00	120.80	110.19	10.6								
		124.80	110.51	out 14.3	3+78.39							
	4+00	124.80	110.61	in 14.2								
		124.50	110.69	13.8								
	5+00	125.00	111.09	13.9								
		125.70	111.42	out 14.3	5+80.49							
	6+00	125.70	111.52	in 14.2								
		125.70	111.59	14.1		(at 87.0) 4" SDR 35	4" SDR 40 DL 6+R TAP	2000-02700	10025 Prairie Woods	10010 W Burnee	7-10-96	12-12-00
	7+00	129.00	111.99	17.0		7+00 4" NE 117.5		96-1890-7	10021 W Prairie Woods		6-2-96	
		131.50	112.36	out 19.1	7+90.55							
	8+00	131.50	112.46	in 19.0								
		131.50	112.61	out 18.9	8+28.48							
	9+00	131.50	112.71	in 18.8								
		130.70	113.01	out 17.7	9+03.32 = 0+00 L-2	4" SDR 35	8+50 4" E 120.00	96-1740-7	10017 Prairie Woods		10-9-96	
	10+00	130.70	113.11	in 17.6								
		130.00	113.50	16.5			94+50 4" E 120	96-5254-7	10013 Prairie Woods		4-15-96	
	11+00	129.60	113.90	15.7								
		129.60	113.90	15.7			10+20 4" E 119.00	96-9125-7	10009 W Prairie Woods Ct		6-11-96	
	12+00	128.80	114.30	14.5								
		128.80	114.30	14.5			10+90 4" E 119.00	96-9122-7	10005 W Prairie Woods Ct		6-11-96	
	13+00	128.80	114.70	13.3								
		128.00	114.75	out 13.3	13+11.81	8" N, 114.85	4" SDR 35	12+45 4" E 119.00	96-5261-7	10000 Haskell		4-15-96
	14+00	128.00	114.85	in 13.2								
		127.00	115.20	11.8			14+28.7 4" SDR 35	97-2483-7	10101 Haskell	10102 Prairie Woods	2-12-97	9-24-96
	15+00	128.50	115.60	12.9								
		130.00	115.93	out 14.1	15+81.28		14+86.3 4" SDR 35	97-2481-7	10105 Haskell	10106 Prairie Woods	2-12-97	11-13-96
	16+00	130.00	116.03	in 14.0								
		129.70	116.10	13.6			15+70.7 4" SDR 35	97-20498-7	10109 Haskell	10110 Prairie Woods	11-12-97	
	17+00	130.80	116.50	14.3								
		130.80	116.50	14.3			16+35 4" N 120.00	97-13971-7	10113 Haskell	10114 Prairie Woods	9-17-97	9-24-96
	18+00	132.00	116.90	15.1								
		133.10	117.23	15.9	18+82.42	4" N	17+15 4" N 120.00	97-20495-7	10117 Haskell		11-12-97	
	19+00	133.10	117.33	15.8								
		133.10	117.33	15.8			17+95 4" N 122.00	97-20497-7	10201 Haskell	10118 Prairie Woods	11-12-97	9-24-96
	20+00	132.00	116.90	15.1								
		133.10	117.23	15.9	18+82.42	4" N	18+05 4" S 122.00	95-20527-7	10222 Prairie Woods		12-14-95	
	20+00	133.10	117.33	15.8								
		133.10	117.33	15.8			19+40 4" N 123.50	97-20496-7	10209 Haskell	10206 Prairie Woods	11-12-97	12-14-95
	20+00	134.00	117.80	16.2								
		135.00	118.02	17.0	20+56.01	8" N, 118.12	20+20 4" N 124.50	97-9614-7	10215 Haskell	10210 Prairie Woods	6-10-97	12-14-95
	0+00 L-2	135.00	118.02	17.0								
		130.70	113.11	17.6	0+00 L-2 = 9+03.32 L-1	4" NW, 122.50	4" SW, 122.50	96-15991-7	10214 Prairie Woods		9-24-96	
	1+00	130.40	117.18	put 13.2	0+61.51							
		130.40	117.28	in 13.1								
	2+00	131.60	117.42	out 14.2	1+71.51=0+00 L-3 & 4	4" NW, 119.8	4" SW, 119.8	96-19129-7	2314 Crestline		11-13-96	
		131.60	117.82	in 13.8								
	3+00	132.50	117.93	14.6								
		132.50	117.93	14.6			2+01.0 4" SDR 35	96-17318-7	2310 Crestline		10-9-96	
	4+00	133.70	118.33	15.4								
		134.50	118.49	out 16.0	3+39.51							
	4+00	134.50	118.59	in 15.9								
		134.30	118.71	out 15.6	3+69.51							
	5+00	134.30	118.81	in 15.5								
		134.40	118.93	15.5			TAP 3+97.5 4" SDR 35	96-17315-7	2305 S Crestline	2304 Crestline	10-9-96	11-3-96
	5+00	134.60	119.29	out 15.3	4+89.51 = 0+00 L-5	8" N, 119.39	4+00 4" S 122.50	96-19108-7				
		134.60	119.39	in 15.2		4" NW, 121.39	4" S, 121.39	96-21190-7	2313 Crestline		12-23-96	
	5+00	134.60	119.39	in 15.2								
		134.60	119.39	in 15.2			5+38.5 4" SDR 35	95-20526-7	10201 Prairie Woods		12-14-95	
	5+00	134.60	119.39	in 15.2								
		134.60	119.39	in 15.2			5+60 4" S 125.00	96-16999-7	2317 Crestline		9-24-96	
	CONT. ON N-188											