

# GENERAL NOTES:

The Contractor shall comply with all applicable safety regulations. All construction shall be completed following current City Standard Specifications and Special Provisions.

Contractor will be required to provide notice to utility companies a minimum of seventy-two (72) hours prior to any excavation, as follows:

Kansas One-Call 687-2470

The Contractor must notify the following in case of an emergency:

AT&T 1-800-246-8464  
 Black Hills Energy 1-800-694-8989  
 City of Wichita Water & Sewer 1-316-219-8921  
 City of Wichita Stormwater 1-316-268-4090  
 City of Wichita Traffic 1-316-268-4034  
 Cox Communications 1-888-249-3530  
 Kansas Gas Service 1-888-482-4950  
 Eergy 1-800-544-4857

Utility service lines, poles, etc. are to be adjusted as necessary by others prior to construction unless the plans specifically call for their adjustment by the Contractor or unless the plans specifically identify a utility to be adjusted by its owner during construction. Existing utilities and their location, as shown on the plans, represent the best information obtainable for design. The Contractor will be required to work around existing utilities within the right-of-way which do not conflict with proposed construction.

Rubble from the removal of miscellaneous structures and excess excavation which is to be wasted shall be disposed of on sites to be provided by the Contractor. These sites shall be approved by the Engineer as to suitability, appearance and site location. Locations, in the opinion of the Engineer, that will leave an unsightly appearance will not be approved. All disposal sites must be approved by the Kansas Department of Health and Environment. Material either stockpiled or disposed of in a flood plain will require a Kansas State Board of Agriculture permit. Any material dumped in waters of the United States or wetlands is subject to U.S. Corps of Engineers permitting regulations. Any material buried or stockpiled beyond approved construction limits will require additional archaeological investigations unless buried in a previously approved borrow location.

Trees and shrubs in public right-of-way which are in direct conflict with proposed new construction shall be removed by the Contractor with the City Engineer's approval. Trees and shrubs which are not in direct conflict with proposed new construction shall be saved and protected from damage.

The Contractor shall give all property owners and/or tenants of developed property abutting the construction of this project a minimum of ten (10) days notice prior to start of construction.

The Contractor shall be responsible for preserving property irons. The Contractor will be required to re-establish any property irons which are damaged or destroyed by his construction operations. Such irons shall be re-established by a licensed land surveyor in accordance with state laws.

8. The Engineering Division shall field locate water valves one time during construction when requested by the Contractor. It shall be the Contractor's responsibility to preserve such field locations during the construction process. Water valves, valve boxes or fire hydrants damaged during construction shall be repaired by Contractor at his own expense. Valve boxes and water meters within the project limits shall be adjusted to match final grades by the contractor.

9. The Contractor shall notify the inspecting engineer and Dawnita Reinhardt at 316-268-4574 with the City of Wichita with the anticipated construction start date and notify them of project completion.

10. If traffic will be impacted by construction, a traffic control plan must be submitted and approved by the City Traffic Engineer, Mike Armour at [marmour@wichita.gov](mailto:marmour@wichita.gov) before construction can begin. The Contractor shall be responsible for all traffic control measures to facilitate construction. All construction zone markings and signage shall conform to the latest version of the Manual on Uniform Traffic Control Devices (MUTCD) as published by the US Dept. of Transportation, Federal Highway Administration. All costs associated with construction markings and signage shall be the Contractors responsibility.

11. All elevations shown are NAVD 88.

12. All areas disturbed during construction that will not be under proposed pavement shall be restored to match existing conditions.

## Benchmarks

BM #1: "□" Cut in face of curb inlet near SE corner of Lot 30, Block C, Gray's 5th Add. Elev. = 1297.86 NAVD88

BM #2: "□" Cut in top of curb on east side of Flora, ±10' north of south property line of Gray's 5th Add. Elev. = 1302.40 NAVD88

BM #4: "□" Cut in top of curb on east side of Flora, adjacent to common lot line of Lots 3&4, Block C, Gray's 5th Add. Elev. = 1305.32 NAVD88

- Any sidewalk, drive approach, curb, or street pavement removed to construct project must have a pavement cut permit and be replaced by the City contractor. Permits can be obtained by calling 316-268-4501 or 316-268-4480.
- All applicable fees (tap, equity, in lieu of & main benefit) must be paid before any connections can be made on this project. Quotes can be obtained on fees by calling 316-268-4555.
- City Maintenance of sanitary sewer mains ends at last structure within the easement or right-of-way.
- All stubs and capped pipes shall be located with green plastic tape in the same manner as risers.
- Connecting to Existing Manholes: Prior to laying sewer lines using existing stubs in existing manholes, the Contractor shall expose and verify the elevation, grade and alignment of existing stubs and notify the Engineer of any deviation from the plans. Where the stub is unusable due to elevation grade or alignment, the Contractor shall remove the stub and plug the hole, and reshape the existing manhole invert to provide smooth flow. Where connecting to an existing manhole that does not have an existing stub, the Contractor shall core cut into existing manhole wall to make connection using approved water stop gasket, and reshape the existing manhole invert to provide smooth flow. The cost to connecting to existing manholes is incidental to the project.
- Contractor shall limit the extent of trench open overnight and weekends to less than 50 feet.
- Contractor shall provide positive drainage away from all manhole covers.
- The Contractor shall prevent any construction debris from entering the existing sanitary sewer during construction.
- The Contractor shall be responsible for maintaining continuous flow of sewage through construction. Contractors proposed method for maintaining sewage flow shall be submitted and approved by the Sewer Maintenance Division (316-268-4073) prior to starting and by-passing of sewage flows.
- Any over excavation from manhole and pipe removal shall be backfilled with AB-3 compacted to 90-95% ASTM D698.
- The Contractor shall protect from damage and support existing utilities through construction as approved by the utility owner and the Engineer at the contractors expense.

DEVELOPER:  
 Michael Brand  
 Brand Investments, LLC  
 2418 S. Hoover Rd  
 Wichita, KS 67215  
 (316)945-3527

**WORK ORDER 2022-004367**

## SANITARY SEWER IMPROVEMENTS

to serve

# TRINITY POINT ADDITION-PHASE II

Lots 19 through 32, Block B; Lots 5-13, Block C

## CITY OF WICHITA, KANSAS

Gary Janzen, P.E. City Engineer  
 Project Number: 2021-085469PPS  
 Org. #: 53030982

## AS-BUILT PLANS

Contractor: Mies Costruction Co.  
 Inspector: Larry Powell  
 Baughman Company, P.A.  
 As-Builts By: Larry Powell  
 Date: April 21, 2022

**5142C  
 Basin: SWI-03**

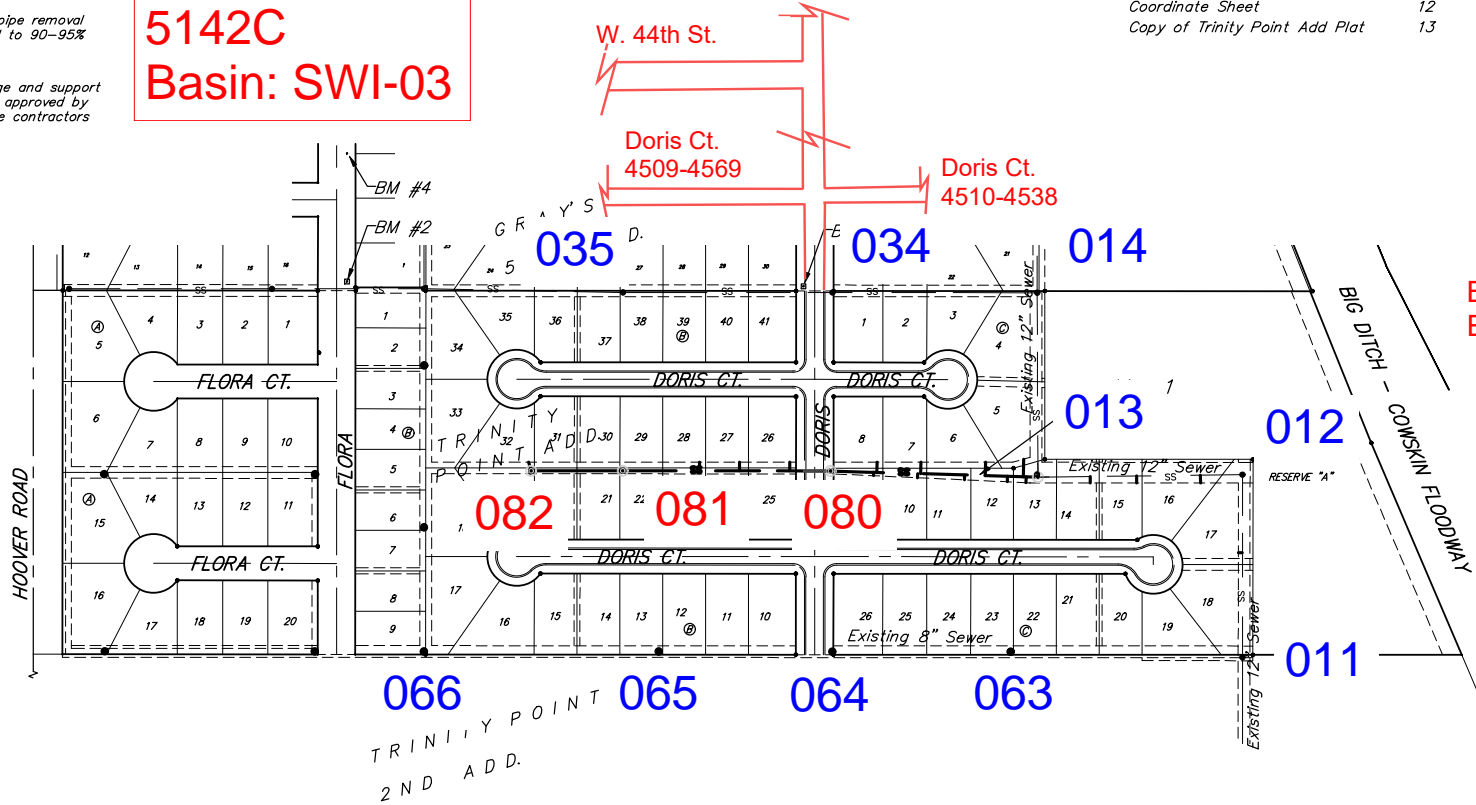

**8" SS PVC PIPE = PIPELIFE JET STREAM.  
 4" SCH. 40 PIPE = NORTHERN PIPE PRODUCTS.  
 PVC BENDS & FITTINGS = GPK.**

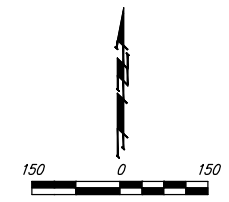
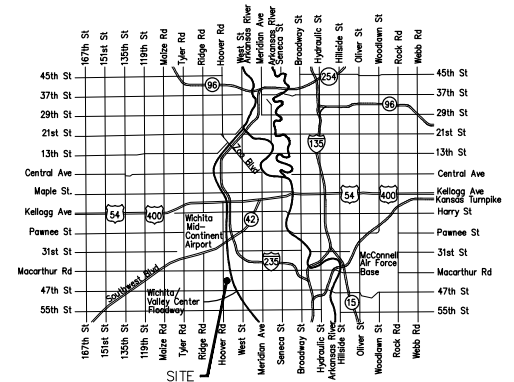

## Sheet Index

Title Sheet	1
Line 1	2
Precast SS Manhole Detail	3
Manhole Frame & Cover Detail	4
Vertical Riser Detail	5
Erosion Control Plan	6
Erosion Control BMP Details	7-11
Coordinate Sheet	12
Copy of Trinity Point Add Plat	13

APPROVED AS NOTED  
 BY WICHITA PUBLIC WORKS  
 ENGINEERING DIVISION

Engineering	S.M.	02/24/2022
Utilities	D.A.	02/24/2022

NOTE TO CONTRACTORS

Inspection and testing for this project is to be provided by a Licensed Consulting Engineering Firm under contract with the Owner/Developer. Said inspection to be in accordance with the City of Wichita standard construction engineering practices and certified by a Licensed Professional Engineer in the state of Kansas. No work shall be performed by the Contractor without such inspection nor shall any work be commenced without written authorization by City Engineering. All Construction and Materials shall comply with the current City of Wichita Specifications and Standards and Special Provisions. (on file and available at Wichita.gov).

An approved copy of these plans signed by City staff are required on-site.

**BEGIN: MARCH 8, 2022 (SS WORK).  
 END: APRIL 6, 2022 (TV WORK).**

**D. Reinhardt - City of Wichita, Inspector  
 Stubs & Risers  
 Release Date: 5/18/2022  
 : apr 5/24/2022**

**Baughman Job #: 22-02-E124**



November 2021



Baughman Company, P.A. 315 Ellis St. Wichita, KS 67211 P 316-262-7271 F 316-262-0144  
 ENGINEERING | SURVEYING | PLANNING | LANDSCAPE ARCHITECTURE





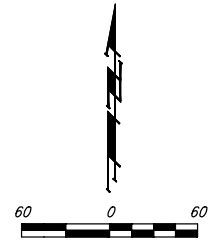
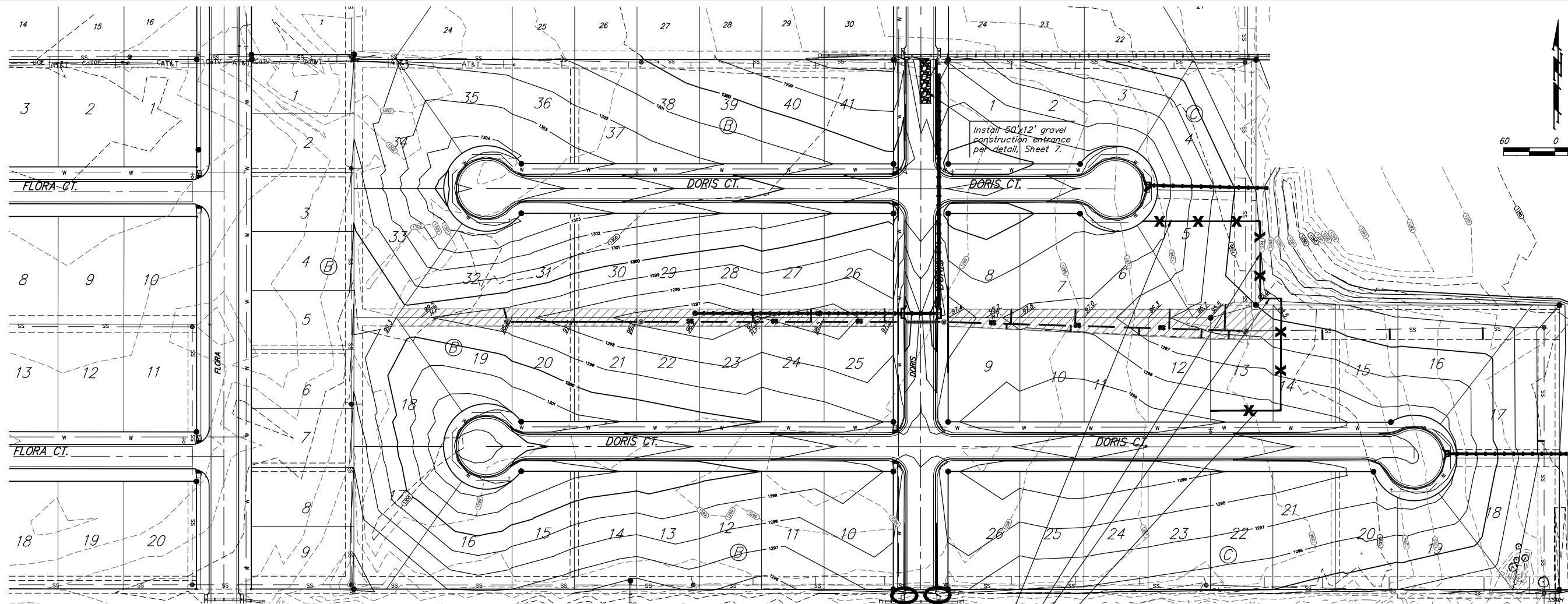

**EROSION CONTROL PLAN LEGEND**  
(Installation Details Found in the SMP2 Plan)

- DROP INLET PROTECTION
- CURB INLET PROTECTION
- DITCH CHECKS
- SILT FENCING
- EROSION CONTROL BERM
- BACK OF CURB PROTECTION
- EROSION CONTROL MAT
- TEMPORARY DITCH

NO SCALE

EROSION CONTROL MEASURE	INSTALL	MAINTAIN	REMOVE
BACK OF CURB PROTECTION (LF)	0	0	0
CONSTRUCTION ENTRANCE (EA)	1	0	0
CURB INLET BARRIER (EA)	0	2	0
DITCH CHECK (EA)	0	0	0
DROP INLET PROTECTION (EA)	0	0	0
EROSION CONTROL (LS)	0	0	0
EROSION CONTROL BERM (LF)	0	0	0
SILT FENCE (LF)	466	0	0
EROSION CONTROL MAT (SY)	0	0	0

QUANTITIES ARE FOR INFORMATION ONLY! CONTRACTOR SHALL VERIFY QUANTITIES PER FINAL BID QUANTITY SHEET.

\* ALL EXISTING BMPs INCLUDING CONSTRUCTION ENTRANCE, SEDIMENT BARRIERS, SILT FENCE, EROSION CONTROL BERM, AND EROSION CONTROL MAT SHALL BE MAINTAINED AND REPAIRED IF NECESSARY. REPLACEMENT OR REMOVAL OF EROSION CONTROL MEASURES TO BE PAID FOR BY L.S. BID ITEM "MAINTAIN EXISTING EROSION CONTROL BMPs"

Maintain curb inlet sediment barriers per detail, Sheet 7.

449'

Install 466 L.F. silt fence per detail, Sheet 9.

= 1,022 L.F. Easements To Be Graded

Approximate Easement Grading Quantities:  
(Unadjusted. For Information Only)  
Excavation: 86.3 C.Y.  
Fill: 77 C.Y.

The contractor shall grade the easements as shown to the elevations given on the easement grading plan. All costs for grading shall be incidental to the Easement Grading Bid Item.

The contractor shall 'straight' grade the easements between the elevations given. Where a callout designates 'Match', the contractor will grade to the existing ground elevation.

All excess excavation from easement grading and from construction of Sanitary Sewer shall remain on site and be spread evenly on lots adjacent to easements outside of easements & right of ways.

All easements have been graded prior to construction with the mass grading project, however, easements with "matching" shall be fine graded as indicated on this sheet. All other easements disturbed by construction shall be restored to preconstruction existing grade. All cost associated with the fine grading shall be included in the lump sum bid item "Easement Grading".

3-16-22: Contractor told to Grade to Drain. LDP

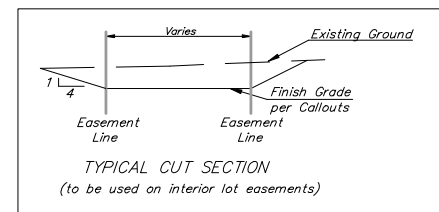

--- 1300 --- Existing Grade  
— 1300 — Proposed Grade

SANITARY SEWER

Point Table			
Point #	Northing	Easting	Raw Description
20000	21262.36	31712.99	Sta 0+00, Line 1-Connect To Exist. MH
20001	21272.91	31362.15	Sta 3+52, Line 1-Prop 4' MH
20002	21273.09	31005.15	Sta 7+06, Line 1-Prop 4' MH
20003	21273.16	30849.15	Sta 8+62, Line 1-Prop 4' MH

PROPERTY IRONS

Point Table			
Point #	Northing	Easting	Raw Description
10000	20959.57	32079.43	PROP_COR
10002	20959.94	31300.43	PROP_COR
10003	20960.25	30669.40	PROP_COR
10004	21580.25	30669.69	PROP_COR
10005	21579.94	31300.72	PROP_COR
10006	21579.91	31364.72	PROP_COR
10007	21579.74	31724.75	PROP_COR
10008	21292.74	31724.62	PROP_COR
10009	21292.57	32079.59	PROP_COR
10010	21097.67	31862.12	PROP_COR
10011	21155.67	31882.39	PROP_COR
10012	21097.91	31364.49	PROP_COR
10013	21155.91	31364.52	PROP_COR
10014	21155.94	31300.52	PROP_COR
10015	21097.94	31300.49	PROP_COR
10016	21098.15	30865.19	PROP_COR
10017	21156.15	30865.22	PROP_COR
10018	21400.15	30865.34	PROP_COR
10019	21458.15	30865.37	PROP_COR
10020	21399.94	31300.64	PROP_COR
10021	21399.91	31364.64	PROP_COR
10022	21457.91	31364.67	PROP_COR
10023	21457.94	31300.67	PROP_COR
10024	21399.84	31518.91	PROP_COR
10025	21457.84	31518.93	PROP_COR
10026	21580.25	30669.69	PROP_COR

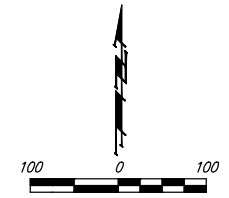

TRINITY POINT ADDITION-PHASE II  
**COORDINATE POINTS**  
 SANITARY SEWER IMPROVEMENTS

**Baughman Company, P.A.**  
 115 Elm St., Wichita, KS 67211 P: 316-262-2771 F: 316-262-0149  
 Kansas Licensed Professional Engineer License #081202010  
 Kansas Licensed Professional Engineer License #081202010  
 www.baughman.com