



alloyarchitecture.com

165 S. ROCK ISLAND, SUITE 200  
WICHITA, KS 67202  
P: 316.634.1111

PROJECT NUMBER  
520009

The drawing and all information herein is the exclusive property of Alloy Architecture and is not to be copied or used in any way without the express written consent of Alloy Architecture. All drawings, specifications, notes, designs and arrangements appearing herein constitute the original and unpublished work of the architect.

Copyright © 2021  
Alloy Architecture



Page Southland Paper, Inc.  
370 17th Street, 56th Floor  
Denver, CO 80202  
pagethink.com

TEL: 303.595.0491  
FAX: 303.595.0282



PROFESSIONAL ENGINEERING CONSULTANTS, P.A.  
303 South Topeka  
Wichita, Kansas 67202  
www.pec1.com

TEL: 316.262.2691



STRUCTURAL ENGINEERS  
230 Laura, Suite 200  
Wichita, Kansas 67211-1514  
www.dwa.com

TEL: 316.263.7591

Department of Administration  
Office of Facilities & Property Management  
700 Harrison, Suite 1200  
Topeka, Kansas 66603  
Phone: 785.226.5689  
Fax: 785.226.5699

WICHITA STATE UNIVERSITY  
NATIONAL INSTITUTE FOR DIGITAL  
TRANSFORMATION  
Wichita, Kansas 67260-0904  
BUILDING: BAKER  
DATE: 08/11/2021 DRAWN BY: RFT

PPS TITLE SHEET

A-014063

CU5.0

FOR CONSTRUCTION

### GENERAL NOTES

- THE CONTRACTOR SHALL COMPLY WITH ALL APPLICABLE SAFETY REGULATIONS. ALL CONSTRUCTION SHALL BE COMPLETED FOLLOWING CURRENT CITY STANDARD SPECIFICATIONS AND SPECIAL PROVISIONS.
- CONTRACTOR WILL BE REQUIRED TO PROVIDE NOTICE TO UTILITY COMPANIES A MINIMUM OF SEVENTY-TWO (72) HOURS PRIOR TO ANY EXCAVATION, AS FOLLOWS:  
  
KANSAS ONE-CALL 687-2470  
  
THE CONTRACTOR MUST NOTIFY THE FOLLOWING IN CASE OF AN EMERGENCY:  
  
AT&T 1-800-246-8464  
BLACK HILLS ENERGY 1-800-694-8989  
CITY OF WICHITA WATER & SEWER 1-316-219-8921  
CITY OF WICHITA STORMWATER 1-316-268-4090  
CITY OF WICHITA TRAFFIC 1-316-268-4034  
COX COMMUNICATIONS 1-888-249-3530  
KANSAS GAS SERVICE 1-888-482-4950  
EVERGY 1-800-544-4857
- UTILITY SERVICE LINES, POLES, ETC. ARE TO BE ADJUSTED AS NECESSARY BY OTHERS PRIOR TO CONSTRUCTION UNLESS THE PLANS SPECIFICALLY CALL FOR THEIR ADJUSTMENT BY THE CONTRACTOR OR UNLESS THE PLANS SPECIFICALLY IDENTIFY A UTILITY TO BE ADJUSTED BY ITS OWNER DURING CONSTRUCTION. EXISTING UTILITIES AND THEIR LOCATION, AS SHOWN ON THE PLANS, REPRESENT THE BEST INFORMATION OBTAINABLE FOR DESIGN. THE CONTRACTOR WILL BE REQUIRED TO WORK AROUND EXISTING UTILITIES WITHIN THE RIGHT-OF-WAY WHICH DO NOT CONFLICT WITH PROPOSED CONSTRUCTION.
- RUBBLE FROM THE REMOVAL OF MISCELLANEOUS STRUCTURES AND EXCESS EXCAVATION WHICH IS TO BE WASTED SHALL BE DISPOSED OF ON SITES TO BE PROVIDED BY THE CONTRACTOR. THESE SITES SHALL BE APPROVED BY THE ENGINEER AS TO SUITABILITY, APPEARANCE AND SITE LOCATION. LOCATIONS, IN THE OPINION OF THE ENGINEER, THAT WILL LEAVE AN UNSIGHTLY APPEARANCE WILL NOT BE APPROVED. ALL DISPOSAL SITES MUST BE APPROVED BY THE KANSAS DEPARTMENT OF HEALTH AND ENVIRONMENT. MATERIAL EITHER STOCKPILED OR DISPOSED OF IN A FLOOD PLAIN WILL REQUIRE A KANSAS STATE BOARD OF AGRICULTURE PERMIT. ANY MATERIAL DUMPED IN WATERS OF THE UNITED STATES OR WETLANDS IS SUBJECT TO U.S. CORPS. OF ENGINEERS PERMITTING REGULATIONS. ANY MATERIAL BURIED OR STOCKPILED BEYOND APPROVED CONSTRUCTION LIMITS WILL REQUIRE ADDITIONAL ARCHAEOLOGICAL INVESTIGATIONS UNLESS BURIED IN A PREVIOUSLY APPROVED BORROW LOCATION.
- TREES AND SHRUBS IN PUBLIC RIGHT-OF-WAY WHICH ARE IN DIRECT CONFLICT WITH PROPOSED NEW CONSTRUCTION SHALL BE REMOVED BY THE CONTRACTOR WITH THE CITY ENGINEER'S APPROVAL. TREES AND SHRUBS WHICH ARE NOT IN DIRECT CONFLICT WITH PROPOSED NEW CONSTRUCTION SHALL BE SAVED AND PROTECTED FROM DAMAGE.
- THE CONTRACTOR SHALL GIVE ALL PROPERTY OWNERS AND/OR TENANTS OF DEVELOPED PROPERTY ABUTTING THE CONSTRUCTION OF THIS PROJECT A MINIMUM OF TEN (10) DAYS NOTICE PRIOR TO START OF CONSTRUCTION.
- THE CONTRACTOR SHALL BE RESPONSIBLE FOR PRESERVING PROPERTY IRONS. THE CONTRACTOR WILL BE REQUIRED TO RE-ESTABLISH ANY PROPERTY IRONS WHICH ARE DAMAGED OR DESTROYED BY HIS CONSTRUCTION OPERATIONS. SUCH IRONS SHALL BE RE-ESTABLISHED BY A LICENSED LAND SURVEYOR IN ACCORDANCE WITH STATE LAWS.
- THE ENGINEERING DIVISION SHALL FIELD LOCATE WATER VALVES ONE TIME DURING CONSTRUCTION WHEN REQUESTED BY THE CONTRACTOR. IT SHALL BE THE CONTRACTOR'S RESPONSIBILITY TO PRESERVE SUCH FIELD LOCATIONS DURING THE CONSTRUCTION PROCESS. WATER VALVES, VALVE BOXES OR FIRE HYDRANTS DAMAGED DURING CONSTRUCTION SHALL BE REPAIRED BY CONTRACTOR AT HIS OWN EXPENSE. VALVE BOXES AND WATER METERS WITHIN THE PROJECT LIMITS SHALL BE ADJUSTED TO MATCH FINAL GRADES BY THE CONTRACTOR.
- THE CONTRACTOR SHALL NOTIFY THE INSPECTING ENGINEER AND TOM MASON AT 316-268-4374 WITH THE CITY OF WICHITA WITH THE ANTICIPATED CONSTRUCTION START DATE AND NOTIFY THEM OF PROJECT COMPLETION. STAKING AND INSPECTION FOR THIS PROJECT WILL BE THE RESPONSIBILITY OF THE CONTRACTOR.
- IF TRAFFIC WILL BE IMPACTED BY CONSTRUCTION, A TRAFFIC CONTROL PLAN MUST BE SUBMITTED AND APPROVED BY THE CITY TRAFFIC ENGINEER, MIKE ARMOUR AT TRAFFIC@WICHITA.GOV BEFORE CONSTRUCTION CAN BEGIN. THE CONTRACTOR SHALL BE RESPONSIBLE FOR ALL TRAFFIC CONTROL MEASURES TO FACILITATE CONSTRUCTION. ALL CONSTRUCTION ZONE MARKINGS AND SIGNAGE SHALL CONFORM TO THE LATEST VERSION OF THE MANUAL ON UNIFORM TRAFFIC CONTROL DEVICES (MUTCD) AS PUBLISHED BY THE US DEPT. OF TRANSPORTATION, FEDERAL HIGHWAY ADMINISTRATION. ALL COSTS ASSOCIATED WITH CONSTRUCTION MARKINGS AND SIGNAGE SHALL BE THE CONTRACTORS RESPONSIBILITY.
- ALL ELEVATIONS SHOWN ARE NAVD 88.
- ALL AREAS DISTURBED DURING CONSTRUCTION THAT WILL NOT BE UNDER PROPOSED PAVEMENT SHALL BE RESTORED TO MATCH EXISTING CONDITIONS.
- ANY SIDEWALK, DRIVE APPROACH, CURB, OR STREET PAVEMENT REMOVED TO CONSTRUCT PROJECT MUST HAVE A PAVEMENT CUT PERMIT AND BE REPLACED BY THE CITY CONTRACTOR. PERMITS CAN BE OBTAINED BY CALLING 316-268-4501 OR 316-268-4480.
- ALL APPLICABLE FEES (TAP, EQUITY, IN LIEU OF & MAIN BENEFIT) MUST BE PAID BEFORE ANY CONNECTIONS CAN BE MADE ON THIS PROJECT. QUOTES CAN BE OBTAINED ON FEES BY CALLING 316-268-4555.
- CITY MAINTENANCE OF SANITARY SEWER MAINS ENDS AT LAST STRUCTURE WITHIN THE EASEMENT OR RIGHT-OF-WAY.

# SANITARY SEWER to serve WICHITA STATE UNIVERSITY NATIONAL INSTITUTE FOR DIGITAL TRANSFORMATION 1845 FAIRMOUNT CITY OF WICHITA, KANSAS 67260

Gary Janzen, P.E. City Engineer

Project Number  
2021-029572 PPS (184011) (53030982)

5749A  
SS23-02

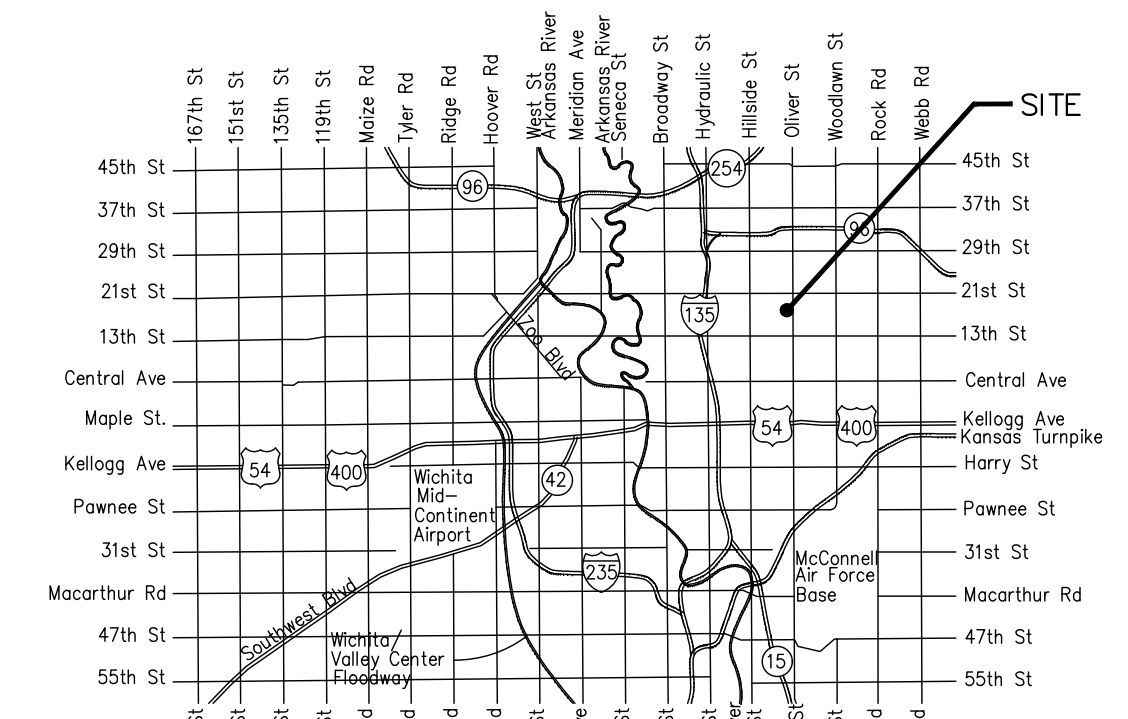

Vicinity Map

**AS BUILTS**

Contractor: <b>Ewertz Excavation</b>  777/2022	Project Inspector: <b>John Schuller</b>  <b>KEMILLER ENGINEERING PA</b> 117 E. Lewis, Wichita, KS 67202 (316)264-0242
---	---

D. Reinhardt - COW, Inspector  
Release Date 08/29/2022  
: apr 08/31/2022

Contractor reused ring and lid.

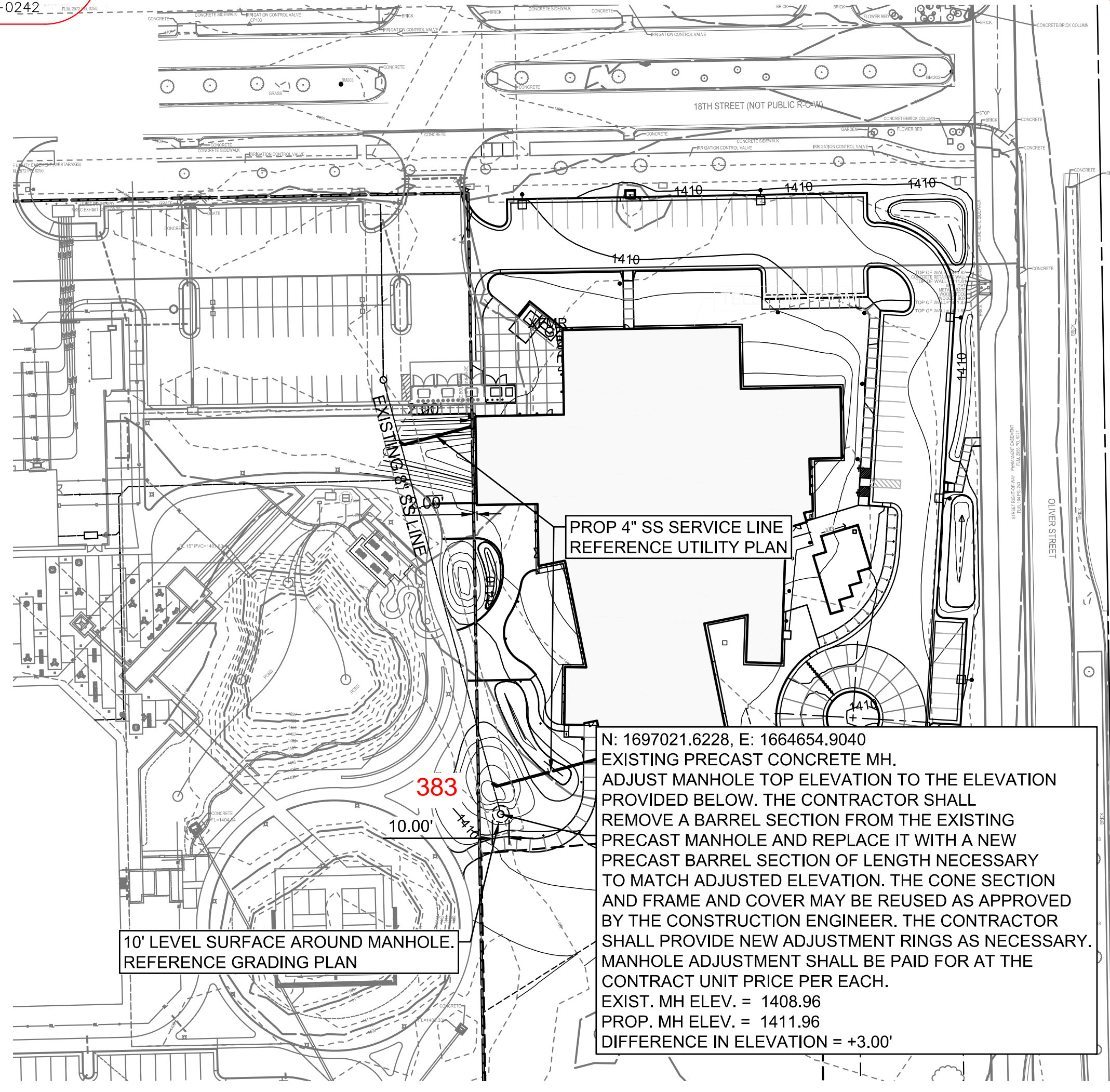

### CONTROL POINTS

- N: 1696923.2506 E: 1664958.6056  
MAG NAIL SET IN SIDEWALK JOINT NEAR THE EAST EDGE OF SIDEWALK ON THE WEST SIDE OF OLIVER NEAR THE PC OF THE BACK OF CURB AND BETWEEN 17TH STREET N AND 18TH STREET N.
- 23.7' SSE TO A GAS PIPELINE TEST LEAD.
  - 18.3' E TO THE WEST BACK OF CURB ALONG OLIVER.
  - 61.1' NNE TO THE SOUTHWEST CORNER OF THE CURB INLET LID.
- N: 1697554.4073 E: 1664938.5314  
MAG NAIL SET IN SIDEWALK JOINT NEAR THE WEST EDGE OF SIDEWALK ON THE WEST SIDE OF OLIVER AND NORTH OF 18TH STREET N.
- 15.5' E TO THE WEST BACK OF CURB ALONG OLIVER.
  - 56.4' S TO THE NORTH BACK OF CURB ALONG 18TH STREET N.
  - 39.1' SSE TO THE BASE OF THE STREET SIGN POST.

### BENCHMARKS

- BM-201: SQUARE CUT ON THE WEST BACK OF CURB ALONG OLIVER AND NEAR THE SOUTHEAST CORNER OF THE CURB INLET NORTH OF THE RIGHT TURN LANE FOR 17TH STREET N.  
Elev. = 1409.31 NAVD88
- BM-202: SQUARE CUT ON THE TOP BACK OF CURB AT THE EAST END OF THE CURB ISLAND IN THE MIDDLE OF 18TH STREET N AND WEST OF OLIVER.  
Elev. = 1410.61 NAVD88
- BM-203: SQUARE CUT ON THE TOP OF THE EAST SIDE OF THE CONCRETE BASE OF THE LIGHT POLE ON THE EAST END OF THE CURB ISLAND IN THE MIDDLE OF 18TH STREET N AND SOUTH OF THE NETAPP BUILDING.  
Elev. = 1409.78 NAVD88

SEPTEMBER 2021



PROFESSIONAL ENGINEERING CONSULTANTS, P.A.  
303 SOUTH TOPEKA WICHITA, KS 67202  
316-262-2691 www.pec1.com

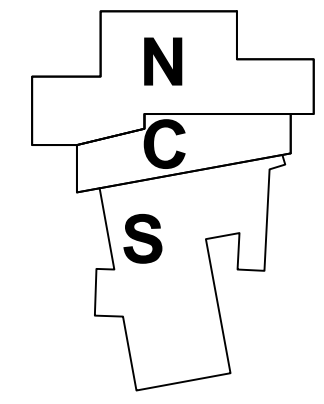

KEYPLAN  
NORTH N.T.S.

A PPS TITLE SHEET  
1" = 20'

Scale: 12'-0"=1' 12/08/14 PM by: BDT/CHMS  
Plot Scale: 11'-0"=1' 12/08/2021 1:26:57 PM by: BDT  
C:\wchita-facil\2020\200347001\MumDrawings\200347-001-CU5.0