

DATA SHEET

MAP- 5243A
 Neighborhood Assn- Southwest Village NA
 Township- Waco
 Z- 3266
 SCZ-
 CU-
 DR-
 DP-
 Amend:
 Case Filed: 12/8/97
 Associated Case DP-138#1
 CPO(4): 1/8/98
 MAPC Hearing Date: 1/15/98

APPLICATION DATA:

General Location: West side of Meridian between 33rd St. S. & I-235 Highway.

Request: Zone change from LC to GC

APPLICANTS: Builder's Inc. PHONE: 685-9661
 1801 S. Glendale
 Wichita, KS 67218

AGENT: Dean Sellers PHONE: 684-9600
 Mid-Kansas Engineering Consultants, Inc.
 411 N. Webb Rd.
 Wichita, KS 67206

AREA DATA: 14.69 acres

Adjoining Zoning: N "SF-6" S "SF-6" E "B, LC, SF-6 & TF-3" W "SF-6"

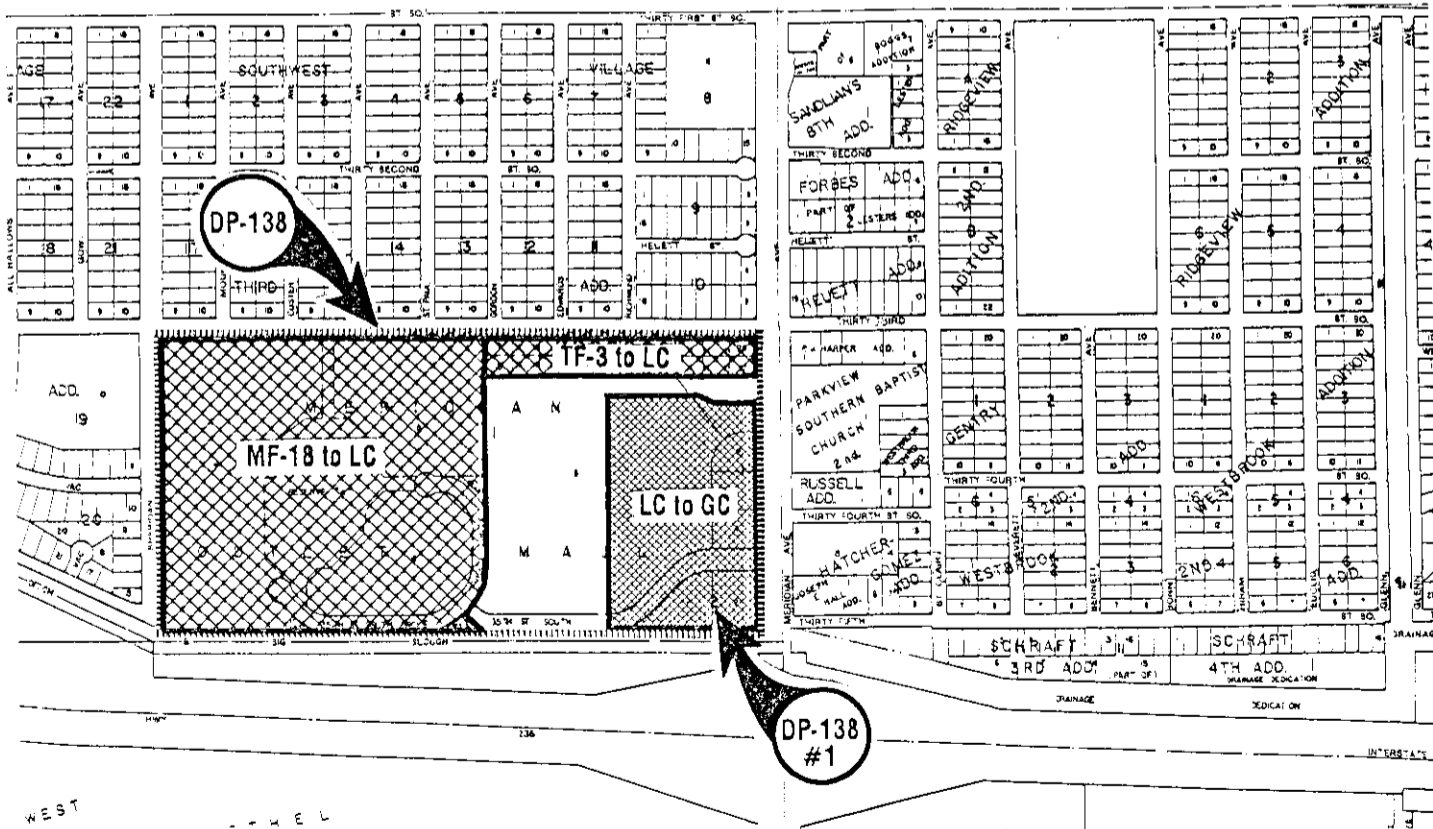

(_____) Published in The Daily Reporter on _____

ORDINANCE NO. _____

AN ORDINANCE CHANGING THE ZONING CLASSIFICATIONS OR DISTRICTS OF CERTAIN LANDS LOCATED IN THE CITY OF WICHITA, KANSAS, UNDER THE AUTHORITY GRANTED BY THE WICHITA-SEDGWICK COUNTY UNIFIED ZONING CODE, SECTION V-C, AS ADOPTED BY CITY OF WICHITA CODE SEC. 28.04.010.

BE IT ORDAINED BY THE GOVERNING BODY
OF THE CITY OF WICHITA, KANSAS.

SECTION 1. That having received a recommendation from the Planning Commission, and proper notice having been given and hearing held as provided by law and under authority and subject to the provisions of The Wichita-Sedgwick County Unified Zoning Code, Section V-C, as adopted by City of Wichita Code Sec 28.04.010, the zoning classification or districts of the lands legally described hereby are changed as follows:

Case No. Z-3266

Zone change request from "MF-18" Multi-Family Residential District (37.23 acres) and "TF-3" Two-Family Residential District (4.84 acres) to "LC" Limited Commercial District, described as:

Lots 1-4, Block 1, YMCA South Addition, Wichita, Sedgwick County, Kansas. Generally located on the west side of Meridian between 33rd Street South and I-235 Highway.

SECTION 2. That upon the taking effect of this ordinance, the above zoning changes shall be entered and shown on the "Official Zoning Map" previously adopted by reference, and said official zoning map is hereby reincorporated as a part of the Wichita-Sedgwick County Unified Zoning Code as amended.

SECTION 3. That this Ordinance shall take effect and be in force from and after its adoption and publication in the official City paper.