

BZA 39-87 - Wichita Housing Authority & Cranford Adult Homes requests an exception to permit the establishment of a group home for 5 mentally handicapped adults on property zoned the "RB" Four-family Dwelling District & generally located on the N. side of Carolina Street

200 '14 Sec 10.21-87
Sho 10.22
Record ✓

65A3A

POSTED 8-25-87
01- KX

5543A

ACTION

B.Z.A. 39-87 Approved 9-22-87
DATE

260 1/4 Sec 10-21-87
Shdw 10-22
or Record ✓

5543A

B.Z.A. 39-87 - Wichita Housing Authority & Cranford Adult Homes requests an exception to permit the establishment of a duplex home for 2 mentally handicapped adults on property zoned the R3 (one-family Dwelling District & generally

Map No. 5543A

BZA 39-87
Filed 9-21-87

AREA DATA:

1. Acres: 0.17 (75484) (74 ft. by 102 ft.)
2. Adjoining Zoning: E RB S RB W A N RB
3. Land Use: East S.f. residence South S.f. residence
West " North "
4. Area (is) (is not) platted.
5. CPO 3A Sept. 16

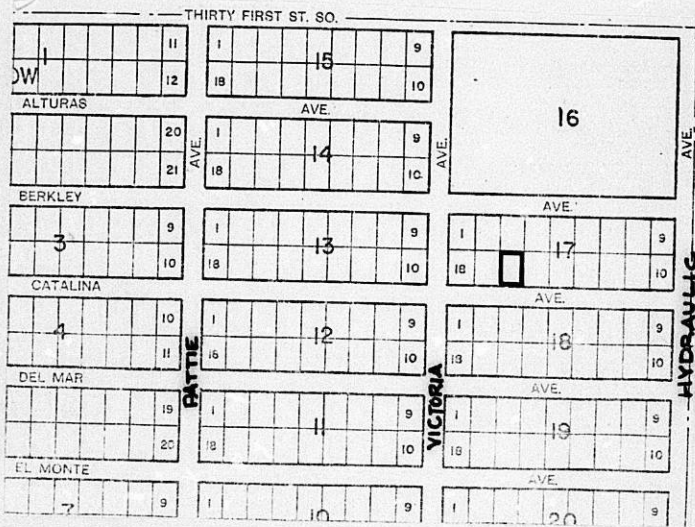

LOS ANGELES COUNTY
REGISTERED PROFESSIONAL SURVEYOR
No. 21533
U.S.A.

Spauld
No. 21533

HASTINGS, SAN JOAQUIN
MCDONOGH, TULLOCH GROVE, CA
U.S.A.

September 22, 1987

Michael Fisher, Director
Wichita Housing Authority
455 North Main
Wichita, Kansas 67202

Re: BZA 39-87 - Exception to permit the establishment of a group home
for five mentally handicapped adults (1514 Catalina)

Dear Mr. Fisher:

Enclosed is a signed copy of the above-referenced BZA Resolution adopted
by the Board of Zoning Appeals on September 22, 1987. This Resolution
reflects the official action of the Board to grant your request and sets out
the conditions of approval. It is forwarded to you for your information
and files.

If you have questions concerning this matter, please call our office.

Sincerely,

Louise Olivarez
Assistant Secretary

LO/lw

Enclosure

cc: Cranford Adult Homes, Inc., Sharon Cranford, Executive Director,
1411 N. Erie, Wichita, KS 67210
Monty Robson, Superintendent of Central Inspection (2)
Dale Rea, Deputy City Clerk

RESOLUTION CASE NO. 39-87

WHEREAS, Wichita Housing Authority, 455 North Main, 11th Floor, Wichita, Kansas 67202 and Cranford Adult Homes, Inc., 1411 North Erie, Wichita, Kansas 67214, pursuant to Section 2.12.590.C, Code of the City of Wichita, requests an exception to permit the establishment of a group home for five mentally handicapped adults on property zoned the "RB" Four-family Dwelling District and legally described as follows:

Lot 16, Block 17, Rainbow Addition, Sedgwick County, Kansas. Generally located on the north side of Catalina in an area west of Hydraulic (1514 Catalina).

WHEREAS, proper notice as required by ordinance and by the rules of the Board of Zoning Appeals has been given; and

WHEREAS, the Board of Zoning Appeals did, at the meeting of September 22, 1987, consider said application; and

WHEREAS, the Board of Zoning Appeals has proper jurisdiction to consider said request for an exception under the provisions of Section 2.12.590.C, Code of the City of Wichita; and

WHEREAS, the Board of Zoning Appeals has authority to permit the establishment of a group home for five mentally handicapped adults on property zoned the "RB" Four-family Dwelling District subject to the conditions outlined in Section 28.04.185.1, Code of the City of Wichita.

NOW, THEREFORE, BE IT RESOLVED by the Board of Zoning Appeals of the City of Wichita, that this application be approved to permit the establishment of a group home for five mentally handicapped adults on property zoned the "RB" Four-family Dwelling District and legally described as follows:

Lot 16, Block 17, Rainbow Addition, Sedgwick County, Kansas. Generally located on the north side of Catalina in an area west of Hydraulic (1514 Catalina).

subject to the following conditions:

1. The facility shall comply with all State and local codes and, prior to remodeling or occupancy, the Health Department, Fire Department and Central Inspection shall approve the facility. The applicant shall secure all necessary permits and licenses.
2. The applicant shall provide not less than two off-street parking spaces, one of which shall be behind the front yard setback.
3. Expansion of the facility to accommodate more than five clients will require a new BZA application.
4. This exception shall only apply to the use of this dwelling for mentally handicapped individuals who do not drive vehicles.

ADOPTED AT WICHITA, KANSAS, this 22nd day of September, 1987.

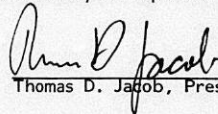
Thomas D. Jacob, President

ATTEST:

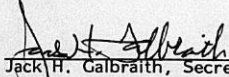

Jack H. Galbraith, Secretary

THE CITY OF WICHITA

OFFICE OF Citizen Participation DATE September 17, 1987

TO Louise Olivarez, Principal Planner

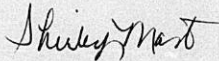
FROM Shirley Mast, Administrative Aide III



SUBJECT BZA 39-87: North side of
Catalina in an area west of
Hydraulic - 1541 Catalina

On Wednesday, September 16, Mid South CPO Council 3A considered the captioned case, a request for an exception to permit the establishment of a group home for five mentally handicapped adults on property zoned the Four Family Dwelling District. Council members were provided the map and notice to adjoining property owners, and the MAPD staff comments. After discussion, the Council voted 9-0 to recommend approval of the requested exception.

Mike Fisher, representing the Wichita Housing Authority and Pat Patterson of Cranford Adult Homes, Inc., were present to describe the request and respond to questions. No adjoining property owners or area residents were present concerning the case.

Please provide the Council's recommendation to the Board of Zoning Appeals when case BZA 39-87 is considered at the September 22 meeting.

SM:dm

SECRETARY'S REPORT

CASE NUMBER: BZA 39-87

OWNER/APPLICANT/AGENT: Wichita Housing Authority (owner/applicant)
Cranford Adult Homes, Inc. (applicant)

REQUEST: Exception pursuant to Section 28.04.185.1 Code of the City of Wichita to permit the establishment of a group home for five mentally handicapped adults

CURRENT ZONING: "RE" Four-family Dwelling District

SITE SIZE: 74 feet by 102 feet (0.17 acre)

LOCATION: North side of Catalina in an area west of Hydraulic (1514 Catalina)

PROPOSED USE: group home

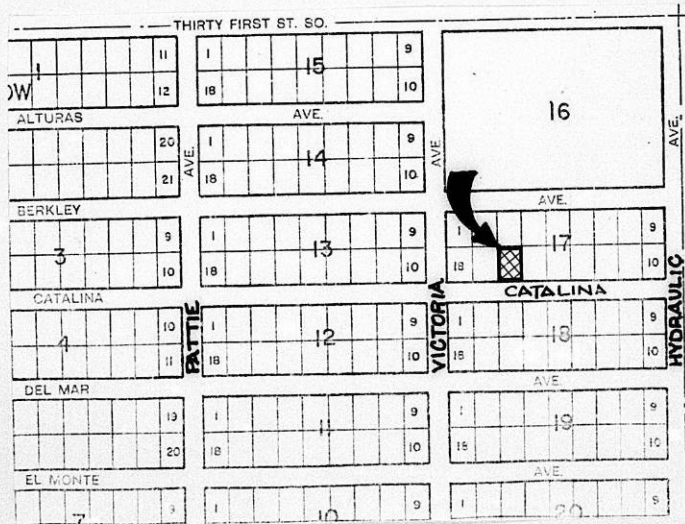

JURISDICTION: The Board has jurisdiction to consider this request under the provisions outlined under Section 2.12.590.C, Code of the City of Wichita. The Board may grant the exception provided the conditions set out in Section 28.04.185.1 can be complied with.

BZA 39-87 SR

BACKGROUND: The applicants are requesting an exception to permit the establishment of a group home for five mentally handicapped adults in an existing 5-bedroom house owned by the Wichita Housing Authority and located at 1514 Catalina. The house would be staffed 24 hours a day by Cranford Homes, Inc. The clients would not be allowed to maintain vehicles on the premises. The present public bus route is just one block to the west on Pattie. The Board approved a similar request at 1621 Catalina last January for eight mentally handicapped adults.

ADJACENT ZONING AND LAND USE:

NORTH	RB	Single-family residence
SOUTH	RB	Single-family residence
EAST	RB	Single-family residence
WEST	A	Single-family residence

RECOMMENDATION: Should the Board determine that the proposed exception is appropriate for this location, then it is the recommendation of the Secretary that the exception be approved subject to the following conditions:

1. The facility shall comply with all State and local codes and, prior to remodeling or occupancy, the Health Department, Fire Department and Central Inspection shall approve the facility. The applicant shall secure all necessary permits and licenses.
2. The applicant shall provide not less than two off-street parking spaces, one of which shall be behind the front yard setback.
3. Expansion of the facility to accommodate more than five clients will require a new BZA application.
4. This exception shall only apply to the use of this dwelling for mentally handicapped individuals who do not drive vehicles.

CITY OF WICHITA
Route Slip
(PLEASE CIRCLE DESTINATION)

- | | | |
|-----------------------------|---------------------------|--------------------------------|
| Administration | Credit Union | Operations/Maint. Dept. |
| Budget & Mgmt. | Emergency Com. | Admin. Research |
| Contracts Admin. | Fire Department | Construction |
| Controller | Health Department | Fleet Maintenance |
| DPI/OA Support | Housing/Econ. Dev. | Flood Control |
| Purchasing | Admin. & Finance | Litter Control |
| Microfilm | Central Inspection | Street Services |
| Print Shop | Energy Resources | Traffic Engineering |
| Stores/Mail Room | Industrial Development | Park Department |
| Ret. & Insurance | Local Housing Authority | Planning Department |
| Treasurer | Human Resources | Design |
| Airport Authority | Admin. Services | Graphics |
| Art Museum | Neighborhood Services | Police Department |
| City Commission | Planning/Evaluation | Water Department |
| City Manager | Law Department | Accounting |
| City Clerk | Library | Engineering |
| Personnel | M.T.A. | Filter Plant |
| Public Affairs | Municipal Court | Mains & Services |
| CPO | | Sewer Maintenance |
| Citizen Rights & Services | | Water Pol. Control |
| Community Facilities | | County Data Processing |
| Building Services | | Court House |
| Century II | | |
| Omnisphere | | |

For Miss O'Leary - 1-101
 For your information _____ For your comments _____

MESSAGE:
J. Bandman 1/28/87
 Signed _____ Date _____
000-013 JAN 84

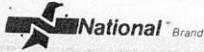

Quicki-Letter® Dennison National Company
Holyoke, MA 01041

FOLD AT (-) FOR WINDOW ENVELOPE

To	Louise Olivarez	From	Michael J. Fisher
	Principal Planner		WHA Director

Subject	South City Information	Date	August 28, 1987
---------	------------------------	------	-----------------

Message Attached is a copy of the letter that was sent to WHA tenants in the South City area and a mailing list of the families and their addresses. Also attached please find the site map indicating lot dimension, setbacks, and driveway dimensions. If additional information is needed, please feel free to call me.

RECEIVED

AUG 31 1987

METROPOLITAN PLANNING

ROUTE _____

SIGNED 

Reply _____ DATE _____

 47-223
Made in USA

THIS COPY FOR PERSON ADDRESSED

THE CITY OF WICHITA



DEPARTMENT OF ECONOMIC DEVELOPMENT
WICHITA HOUSING AUTHORITY
455 North Main
Wichita, Kansas 67202
(316) 264-0331

August 24, 1987

Ms. Debra Bowen WHA #995
1521 DelMar
Wichita, Kansas 67216

Dear Ms. Bowen:

Please be advised that the Wichita Housing Authority is currently working with Cranford Adult Homes, Inc.

The purpose of this project is to place individuals with learning disabilities in a group home environment, which would of course be supervised on a twenty-four hour basis by house parents. No one would be allowed to live in the home if they had drug or alcohol related problems. Most or all of the group home residents do hold jobs.

The WHA is anticipating using the house located at 1514 Catalina into a group home. The maximum number of people for the home will be five in the five bedrooms. If you have any questions or desire any further information with respect to your new neighbors, please feel free to call me or Mike Klingsick at 264-0331.

Sincerely,

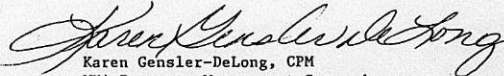
Karen Gensler-DeLong, CPM
WHA Property Management Supervisor

KGD:ns

Ellen Claibourn
1501 Del Mar

Liane Phommarath
1502 Del Mar

Hattie Costello
1506 Del Mar

Kevin Spencer
1507 Del Mar

Minnie Porter
1513 Del Mar

Nettie Williams
1516 Del Mar

Debra Bowen
1521 Del Mar

Joanne Bradley
1522 Del Mar

Nghi Le
1527 Del Mar

Clifton Smith
1528 Del Mar

Barbara Johnson
1601 Del Mar

Myrtle Franklin
1602 Del Mar

Si Van Nguyen
1607 Del Mar

Deborah L. Hayes
1608 Del Mar

Shirley Owens
1613 Del Mar

In T Bui
1614 Del Mar

Bertha Grinage
1620 Del Mar

Shirley Simon
1621 Del Mar

Alverta Phillips
1501 Catalina

Charlene Fields
1502 Catalina

Wynona Vick
1507 Catalina

LaMoine Patterson
1515 Catalina

Binh Pham
1520 Catalina

Evelyn Robinson
1521 Catalina

Thoune Vilaythong
1526 Catalina

Mong Van
1527 Catalina

L.B. Johnson
1601 Catalina

Leellen Kelley
1602 Catalina

Ba Van Pham
1607 Catalina

Leslie Daniels
1608 Catalina

Glynis Ross
1613 Catalina

Lillie Greenley
1614 Catalina

Hung Luong
1620 Catalina

Phat Chung
1501 Berkeley

Willie Laddimore
1507 Berkeley

Melvina Henagan
1515 Berkeley

Thieu Nguyen
1521 Berkeley

Mary Peters
1601 Berkeley

Luong Nguyen
1607 Berkeley

Irene Oliver
1615 Berkeley

Marion Lawson
1621 Berkeley

BZA CASE NO. 39-87

<u> </u>	NOTICES SENT TO APPLICANT/AGENT
<u>14</u>	LEGAL ADVERTISEMENT SENT TO MAPC & BZA
<u> 1</u>	NOTICES SENT TO CPO
<u> 1</u>	NOTICES SENT TO ADJOINING PROPERTY OWNERS
<u> </u>	TOTAL NOTICES SENT <u>8/24/87</u>

(_____) Published in The Daily Record, August 28, 1987

OFFICIAL NOTICE

NOTICE IS HEREBY given that on the 22nd day of September, 1987, the Board of Zoning Appeals of the City of Wichita, Kansas, in the Board Room, First Floor, City Hall, 455 North Main, Wichita, Kansas will consider the following application beginning at 1:30 p.m.:

1. Case No. BZA 39-87 - Wichita Housing Authority, 455 North Main, 11th Floor, Wichita, Kansas 67202 and Cranford Adult Homes, Inc., 1411 North Erie, Wichita, Kansas 67214, pursuant to Section 2.12.590.C, Code of the City of Wichita, requests an exception to permit the establishment of a group home for five mentally handicapped adults on property zoned the "RB" Four-family Dwelling District and legally described as follows:

Lot 16, Block 17, Rainbow Addition, Sedgwick County, Kansas. Generally located on the north side of Catalina in an area west of Hydraulic (1514 Catalina).

As provided in City Ordinances hereinabove described and Section 2.12.560 et. seq., Code of the City of Wichita, Sedgwick County, Kansas, the same will then and there be discussed and considered by the said Board of Zoning Appeals and all persons interested in said matter will be heard at this time concerning their views and wishes in the premises, and any protest against any of the provisions of the exception will be considered by the Board of Zoning Appeals as by law provided.

WITNESS my hand and seal this 27th day of August, 1987.

Thomas D. Jacob, President

ATTEST:

Jack H. Galbraith, Secretary

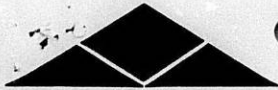

CRANFORD ADULT HOMES, INC.

2673 So. Holyoke • 1411 N. Erie • 2630 E. 13th
Wichita, Kansas 67210
Ph. (316) 697-8965

5/19/87

Mr. Michael Fisher, Director
Wichita Housing Authority
307 Riverview
Wichita Kansas 67203

Dear Mike;

Pursuant to our previously submitted proposal for city housing for the mentally handicapped, I am forwarding updated information re: our request to lease the city owned house located at 1514 Catalina for use as a group home for Cranford Adult Homes, Inc. (CHI).

As you know, CHI consists of four fully licensed group homes which exist to provide residential care and direction to mentally handicapped adults. One of our homes currently in operation is leased from the city of Wichita to accommodate eight clients. CHI is requesting the same arrangement for the aforementioned home at 1514 Catalina:

1. The WHA would lease the vacant five-bedroom dwelling to CHI at 1514 Catalina.
 - a. The lease would be for one year at a time.
 - b. The rental charge would not exceed \$100. per month.
2. CHI would provide insurance, administration and all maintenance.
3. The dwelling would meet local code and zoning regulations prior to occupancy.
 - a. Houses would be brought up to standard rental/living standards prior to occupancy, by the city.
 - b. The city would provide the renovation necessary for live-ability.
4. The house would be staffed 24 hrs. by Cranford Homes, Inc.
5. CHI agrees that the clients would not be allowed to maintain vehicles on the premises.

Fisher called 8-24 to say there would be 5 clients plus a resident manager. I asked him for a site plan and copy of letter to tenants.



CRANFORD ADULT HOMES, INC.

2673 So. Holyoke • 1411 N. Erie • 2830 E. 13th
Wichita, Kansas 67210
Ph. (316) 686-8965

Page 2

We hope that this request can be presented at the next meeting of the Board of Zoning Appeals. Thank You.

Sincerely,

Sharon Cranford, Executive Director

AUG 5 1987

THE CITY OF WICHITA

OFFICE OF WICHITA HOUSING AUTHORITY

DATE August 5, 1987

TO Don E. Anderson, Director, Housing and Economic Development

FROM Michael J. Fisher, WHA Director

244.0331

SUBJECT Group Homes Recap

In response to Marvin Krout's note of concern about group homes in WHA dwelling units, the following is to provide a status of the homes and to clarify the status of current applications.

Currently there are four group homes operating in WHA housing. Three are operated by Pennington Residential Homes and one by Cranford Adult Homes.

Pennington Residential Homes
7015 Frazier Lane ZBA 4586
7028 Frazier Lane ZBA 4486
7031 Frazier Lane ZBA 4686

Cranford Adult Homes
1621 Catalina ZBA 5186

All required ZBA exceptions were coordinated with Planning staff, in particular Glen Lytle. The group homes also required the approval of the Department of Housing and Urban Development. Without their approval a zoning exception would not be needed. Therefore, their approval has been sought prior to a formal application being submitted to the ZBA. In all ZBA cases the property owners of record within the required notification area were sent notices of the proposed exception. Because the WHA is the owner of record, it is not required that the tenants be notified. However, in the case of the three homes located on Frazier Lane the WHA sent letters to all of its tenants in that neighborhood. We did not receive any negative comments, verbal or written.

5543A At the current time the WHA has three pending applications. Cranford Adult Homes has requested to lease 1514 Catalina as their second group home. It is anticipated the exception application will be submitted prior to the August 27 dead-line. Letters will be sent to all WHA tenants in the neighborhood. When the ZBA granted exception for Cranford's first group home at 1621 Catalina, Dr. Cranford asked the Board members what their disposition would be to granting a second request on the same street. They indicated that they would be favorable to one more group home in that area. Dr. Cranford's current application for 1514 Catalina has been developed around that premise. I have discussed this zoning exception with Louise Olivarez of the Planning Department and she has been quite helpful in providing information about current zoning and submittal requirements.

(Note) Ms. Dawson's request is to lease two homes in the twenty-six hundred block of Ash. The proposal has been submitted to HUD for their approval prior to submittal "AA" for ZBA request. 5650D

All applicants, including Ms. Dawson, have been apprised of the submittal requirements for ZBA exception, that they are responsible for the application fee, and that if the request is not approved the fee is not refundable.

Group Homes Recap
Page 2
August 5, 1987

Sedgwick County Mental Health had submitted a proposal to utilize 1621 Catalina as a boarding house. When the application was submitted to staff for consideration by the ZBA, Mental Health had indicated in their proposal that it was not a group home for the mentally ill; but that the residency would be open to low-income individuals desiring a group setting. However, it was initially submitted to the ZBA as a group home for the mentally ill and it was only at the hearing that the discrepancy was brought to light by Mental Health staff. The ZBA exception request was therefore deferred and the co-applicant changed from Mental Health to Cranford Adult Homes.

I would certainly be willing to inform the Planning staff of any proposal at an earlier point in their inception if it will make the entire process easier. The WHA has processed all requests cautiously so that all factors can be identified and appropriately resolved. If additional information is needed please let me know.



Michael J. Fisher
WHA Director

MJF:kdb

WICHITA-SEDGWICK COUNTY

Date: August 4, 1987

METROPOLITAN AREA PLANNING DEPARTMENT

TO: Chris Cherches, City Manager

FROM: Marvin S. Krout, Director of Planning *MSK*

SUBJECT: Group Homes

We were not aware of the Housing Commissioners' approval of a group home application involving several WHA units; I will ask HED to notify us before taking any of these requests to their board in the future. In some cases, we may know of a history of opposition to specific sites and suggest to HED that they not be recommended.

For your information, group homes must be permitted by the Board of Zoning Appeals as "use exceptions" in all residential districts except the "B" district, in which it is permitted "by right." The BZA process provides for individual review of the proposal, and a public hearing with written notice to nearby property owners. That does not guarantee that a group home which is opposed by neighbors will be denied, but it does force the BZA to look very carefully at the proposed facility, the appropriateness of the location, and whether the local area in question is already burdened with these uses. I think this is the most appropriate way to handle this sensitive issue, and I would personally like to see the ordinance amended so that a "use exception" is required in the "B" district as well (includes areas like Midtown, South Market).

The proposed state legislation that was introduced at this session but not passed would preempt local control and allow group homes "by right" in all residential districts (so long as the group home is at least 1000 feet from another group home in an exclusively single family neighborhood). It is opposed by Wichita and by the League of Municipalities.

MSK:rme

PL/1345/2

WICHITA



DEPARTMENT OF HOUSING AND
ECONOMIC DEVELOPMENT
WHA PROPERTIES
(Wichita Housing Authority)
455 NORTH MAIN
WICHITA, KANSAS 67202
(316) 264-0331

July 30, 1987

Office of the City Manager	
<input type="checkbox"/> CEC	<input type="checkbox"/> SH
<input type="checkbox"/> RGF	<input type="checkbox"/> JA
<input type="checkbox"/> RT	<input type="checkbox"/>
JUL 31 1987	
<input type="checkbox"/> Copies To	_____
<input type="checkbox"/> Send To	_____
<input type="checkbox"/> File	_____

Handwritten initials

Ms. Janice Owens, Director
Management Division
Office of Public Housing
US Department of HUD
1103 Grand Avenue
Kansas City, MO 64106-2496

Dear Janice:

RE: Group Home Proposal

At their July 16, 1987, meeting the Board of Housing Commissioners (BOHC) approved a request by Ms. Lonice Dawson to lease two six-bedroom WHA homes. Ms. Dawson proposes to use the houses as group homes for the mentally ill. The BOHC approved the request by a 4-0 vote. They were very favorable to the proposal because Ms. Dawson proposes using two homes in the Northeast quadrant of Wichita, and she is a current tenant who exhibited a lot of initiative and planning in developing her proposal.

The proposed monthly rent per house is \$75. A zoning exception will be required. Though the WHA will be the applicant of record, Ms. Dawson will be required to pay all fees. A copy of her proposal is attached. The lease used with the other group homes will be utilized, and the same insurance requirements.

Your review and approval of the proposal is requested. Thank you in advance for your support of this proposal serving a very special population of Wichita's low income families.

Sincerely,

Handwritten signature of Michael J. Fisher
Michael J. Fisher
WHA Director

MJF:kdb

Attachment

cc: Chris Cherches, City Manager
Don E. Anderson, Director, Housing and Economic Development

BOARD OF ZONING APPEALS

CASE NO. 9-87

CITY OF WICHITA, KANSAS

FILED 8-21-87

APPLICATION FOR EXCEPTION

I. Name of Applicant Wichita Housing Authority *Cranford Adult Homes Inc. 1411 W. Erie 67214*
 Mailing Address 11th Floor, 455 N. Main, Wichita Phone 264-0331
 Name of Authorized Agent Michael J. Fisher, WHA Director
 Mailing Address 11th Floor, 455 N. Main, Wichita Phone 264-0331
 Relationship of applicant to property is that of Owner
 (Owner, Tenant, Lessee, Other)

II. Application is made for an exception as provided in Section 2.12.590.C, Code of the City of Wichita, Kansas, to permit the establishment of a group home for 5 handicapped adults ~~the mentally ill leased to Cranford Homes, Incorporated.~~

(this info from Mike Fisher 8-24-87)
 _____ on property zoned RB
 located 1514 Catalina and legally described as: Lot 16, Block 17 Rainbow Addition

North side of Catalina in an area west of Hydraulic in the City of Wichita.

- III. The applicant herein, or his authorized agent, acknowledges:
- a. That he has received an instruction sheet concerning the filing and hearing of this matter;
 - b. That he has been advised of the fee requirements established by Section 2.12.580 of the Code of the City of Wichita (Ordinance No. 39-285); and that the appropriate fee is here-with tendered;
 - c. That all documents are attached hereto as noted in paragraphs 2, 3, and 4 of the instructions;
 - d. That he has been advised of his right to bring action in the District Court of Sedgwick County to appeal the decision of the Board.

Applicant Wichita Housing Authority
 Authorized Agent *[Signature]*
 Michael J. Fisher
 WHA Director

OFFICE USE ONLY: Received in Office of Secretary, Board of Zoning Appeals, 10 (a.m.p.m.) 8-21- 1987, together with appropriate fee of 200.

Signed *[Signature]*

CITY OF WICHITA
Route Slip
(PLEASE CIRCLE DESTINATION)

Administration Budget & Mgmt. Contracts Admin. Controller DP/OA Support Purchasing Microfilm Print Shop Stores/Mail Room Ret. & Insurance Treasurer	Credit Union Emergency Com. Fire Department Health Department Housing/Econ. Dev. Admin. & Finance Central Inspection Energy Resources Industrial Development Local Housing Authority	Operations/Maint. Dept. Admin. Research Construction Fleet Maintenance Flood Control Litter Control Street Services Traffic Engineering Park Department Planning Department Design Graphics
Airport Authority Art Museum City Commission City Manager City Clerk Personnel Public Affairs CPO Citizen Rights & Services	Human Resources Admin. Services Neighborhood Services Planning/Evaluation Law Department Library M.T.A. Municipal Court	Police Department Water Department Accounting Engineering Filter Plant Mains & Services Sewer Maintenance Water Pol. Control County Data Processing Court House

For Jack Love

(For your information For your comments)

MESSAGE: Please check to see if the attached info is accurate. I will need a print-out only if someone else owns any of these. Thanks

Signed Louise Oliva Date 8-24

#000-013 JAN 84

CITY OF WICHITA
Route Slip
(PLEASE CIRCLE DESTINATION)

Administration Budget & Mgmt. Contracts Admin. Controller DP/OA Support Purchasing Microfilm Print Shop Stores/Mail Room Ret. & Insurance Treasurer	Credit Union Emergency Com. Fire Department Health Department Housing/Econ. Dev. Admin. & Finance Central Inspection Energy Resources Industrial Development Local Housing Authority	Operations/Maint. Dept. Admin. Research Construction Fleet Maintenance Flood Control Litter Control Street Services Traffic Engineering Park Department Planning Department Design Graphics
Airport Authority Art Museum City Commission City Manager City Clerk Personnel Public Affairs CPO Citizen Rights & Services	Human Resources Admin. Services Neighborhood Services Planning/Evaluation Law Department Library M.T.A. Municipal Court	Police Department Water Department Accounting Engineering Filter Plant Mains & Services Sewer Maintenance Water Pol. Control County Data Processing Court House

For Louise Oliva

(For your information For your comments)

MESSAGE: ok

Signed Louise Oliva Date 8-26

#000-013 JAN 84

THE CITY OF WICHITA



DEPARTMENT OF HOUSING AND
ECONOMIC DEVELOPMENT

WHA PROPERTIES
(Wichita Housing Authority)
455 NORTH MAIN
WICHITA, KANSAS 67202
(316) 264-0331

Property Ownership
within 200 feet of 1514 Catalina

The Wichita Housing Authority is the owner of record of all property in Blocks 17 and 18 of Rainbow Addition. It is the owner of record of all property on the north side of Block 19.

Builders Development, Incorporated is the owner of record of Block 16 Rainbow Addition. The mailing address for Builders Development, Incorporated is:

✓ Builders Development, Incorporated
1530 South Oliver
Wichita, Kansas 67218

RECEIVED

AUG 26 1987

METROPOLITAN PLANNING

ROUTE

**MICROFILMED
FROM THE BEST
AVAILABLE COPY**

FORM : 021 PAYMENT NOTICE
City of Wichita

Bldg.	Use of Str.	Code Bks	Copies
Elec	Elev. Insp.	Hae Moving	Lic.
Mech	Boiler Insp.	Pav. Cuts	Cert.
Plbg	Exam Fees	Sewer	Elev.
Signs	Plan Rev. (P.W.)	Cement	M.S.P.
	Planning		

DESCRIPTION	AMOUNT
<i>B2A</i>	<i>42.11</i>
NAME	
ADDRESS	
FUND	DUE DATE
COMMENTS	
DATE	BY