

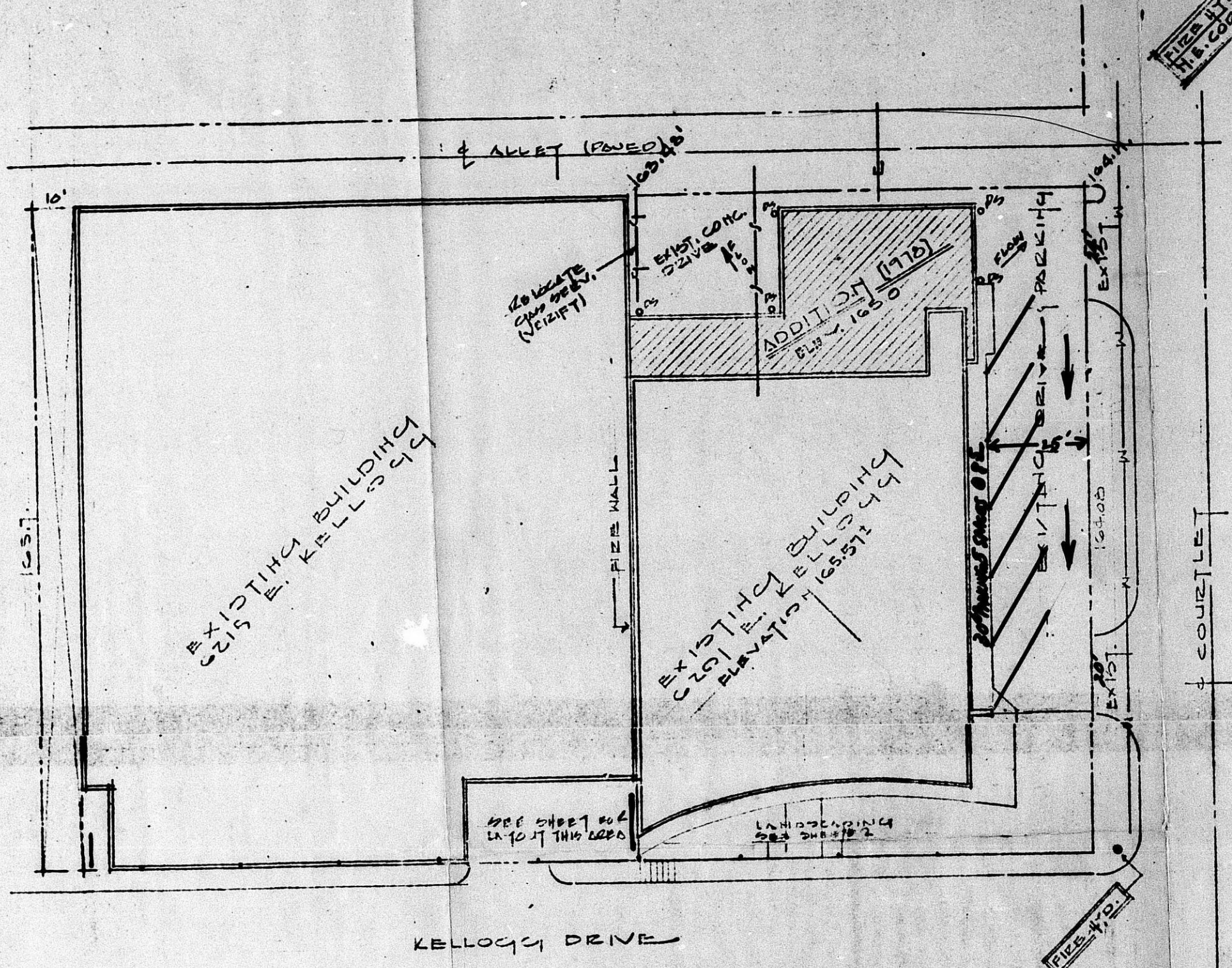

BZA 2-79



SITE PLAN  
1/20/79

BZA 2-79

24 JAN 1979  
APPROVED  
TRAFIL ENGR.

DATA SCHEDULE

<b>SITE</b>	
LEGAL	6201 LOTS 14, 15, 16, 17 BLOCK "A" A.J. CHRISTMAN SEC ADDITION TO WICHITA, KANS.
	6215 LOT 3 EXCEPT EAST 10' AND LOTS 9, 10, 11, 12, 13 BLOCK "A" A.J. CHRISTMAN SEC ADDITION TO WICHITA, KANS.
<b>ZONING</b> "L.O."	
<b>FIRE ZONE</b> "III"	
<b>PARKING</b> EXISTING PARKING TO SOUTH & WEST.	
<b>BUILDING</b>	
AREA	6201 EXISTING 8700 SF. ADDITION 2400 SF. TOTAL 11100 SF.
OCCUPANCY	6201 ADDITION D-1 EXISTING D-2
OCCUP. LOAD	ADDITION 2400 SF @ 1100 = 24 EXISTING 8700 SF @ 1100 = 91 TOTAL 115
<b>BLDG. TYPE</b> EXISTING III ADDITION III	
<b>MECHANICAL</b>	
PLUMBING	EXISTING SEE ATTACHED LETTER RE: EMPLOYEE'S AND EXISTING FIXTURES.
MECHANICAL	EXISTING W/ ONLY UNIT HEATERS IN ADDITION
ELECTRICAL	BY OTHERS.

THERMO DATA

ADDT °K	AREA	U-FAC	ALLOWED	Q-REQ	Q-ALLOWED
ROOF 210	2400 SF	.072	15,496	.083	13,944
WALLS 210	2170 SF	.072	14,278	.300	45,870
FLOOR 150 LF	500		7,500	.346	5,190
TOTAL			37,274		64,704

70° TEMP. DIFF. DESIGN.

DAVIS MOORE  
OLDSMOBILE  
WICHITA, KANSAS

1/10/79  
1/11/79

Munn Building Inc.  
304 NORTH MAIN STREET  
WICHITA, KANSAS 67202  
316-262-0111