

TRAFFIC ENGINEERING DIVISION APPROVED
 Date: 5/11/52
 4A) Parking barriers shall be installed at all locations that are adjacent to public property (so that vehicles will not obstruct public property) and have a minimum length of 6 feet and a minimum cross section of 4" x 4".
 (B) Stall lines shall be painted and 4" or greater in width.
 (C) Proper ingress and egress signs shall be installed at private property at the entrances and exits of the parking facility.

PRESENT PLAN
 CITY WICHITA, KANSAS
 STREET 13" x 60' W.E.B.
 STANDARD
 DIVISION OF ENGINEERING
 1952

B7A 7-32

TRAFFIC ENGINEERING DIVISION APPROVED
 Date: 1/12/62
 (A) Parking barriers shall be installed at all locations that are adjacent to public property (so that vehicles will not obstruct public property) and have a minimum length of 6 feet and a minimum cross section of 4" x 4".
 (B) Stall lines shall be painted and 4" or greater in width.
 (C) Proper ingress and egress signs shall be installed on private property at the entrances and exits of the parking facility.

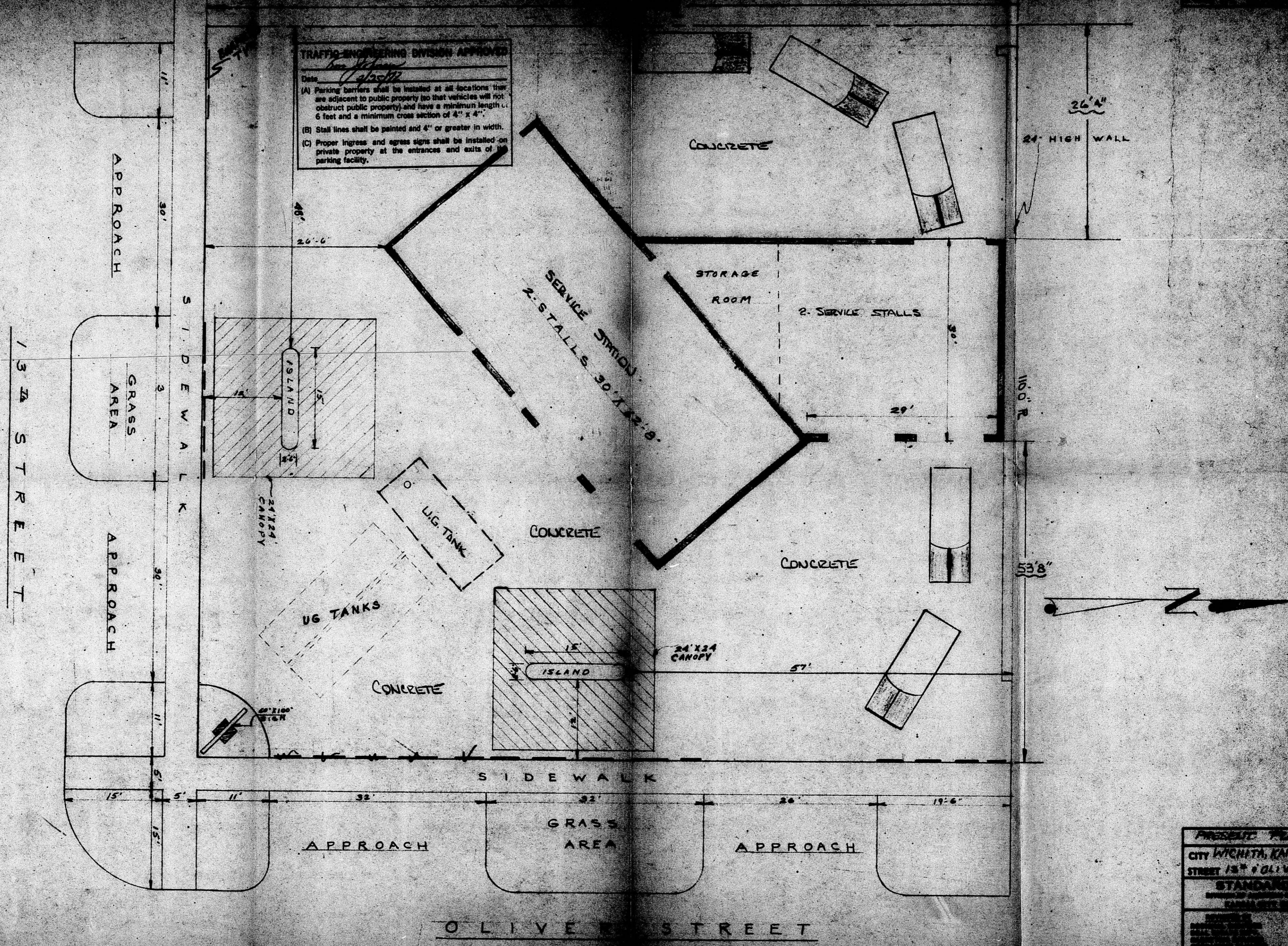

PROPOSED PLAN
 CITY WICHITA, KANSAS
 STREET 13th & OLIVER
 STANDARD OF
 CONSTRUCTION
 1958

DAVID J. [unreadable]