

BZA 11-78

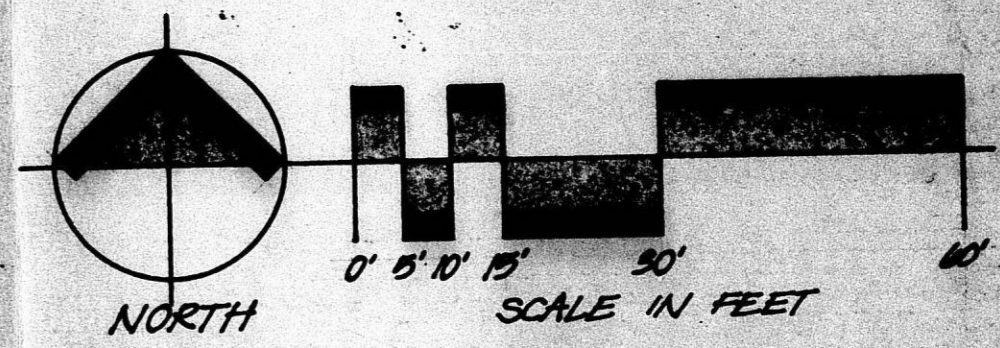
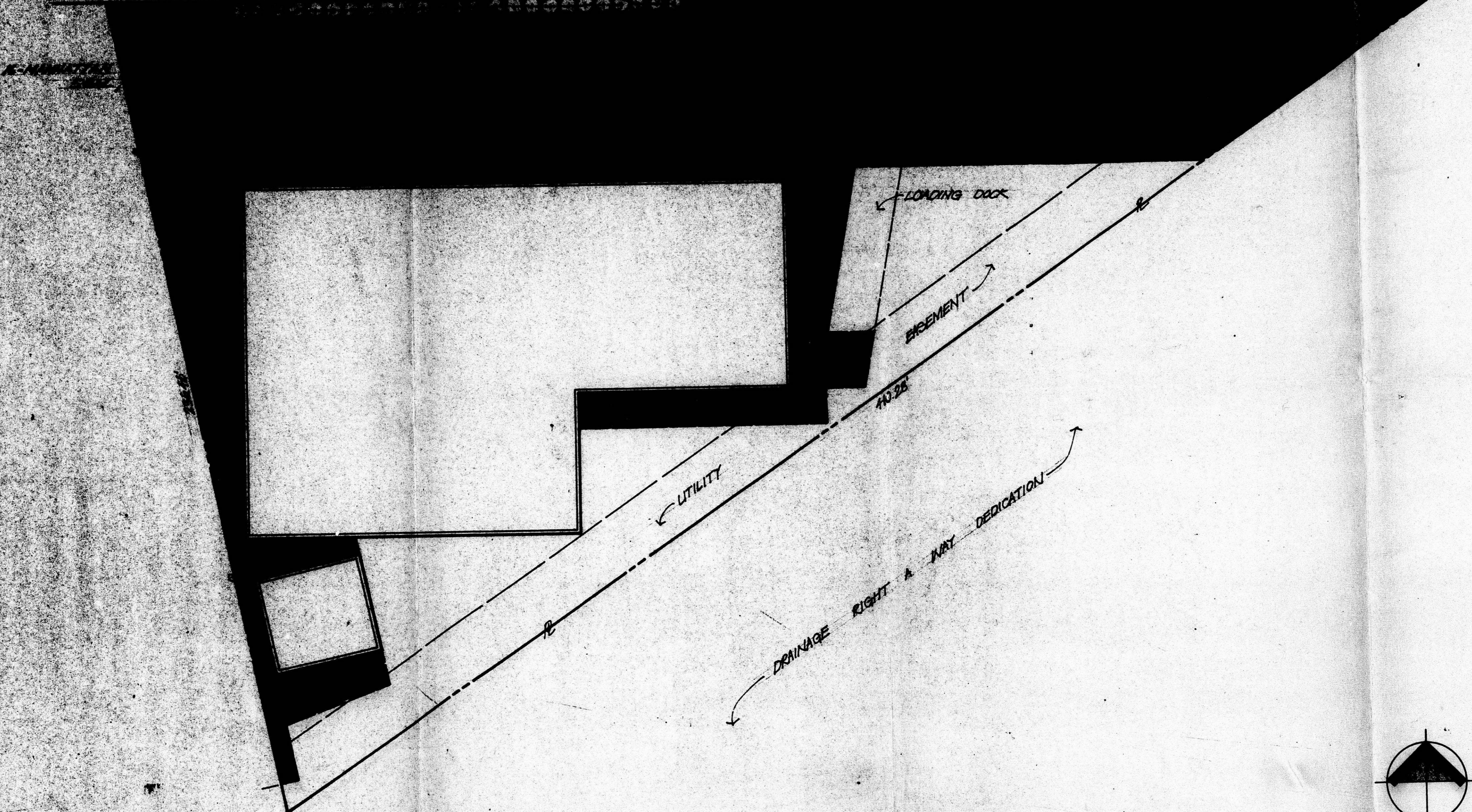
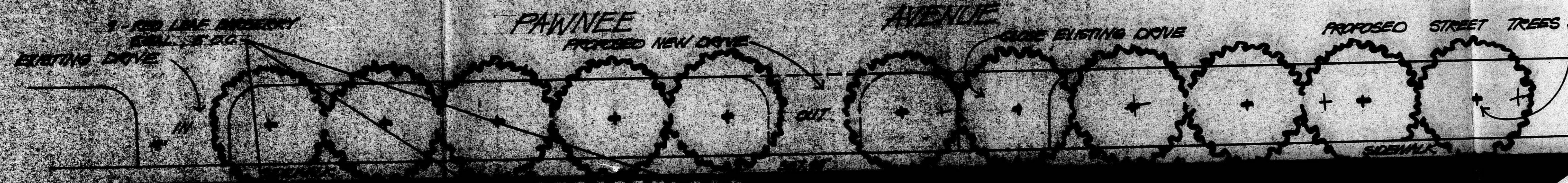

oblinger-smith corporation  
 Drawn  
 Checked  
 Date  
 11-1-78  
 11-1-78  
 11-1-78  
**BZA EXCEPTION & VARIANCE**  
 CASE NO. BZA 12-78 and BZA 15-78  
 LOT 3, BLOCK 3, N.W. QUARTER SECTION 10, T12N, R10E

FILMED FROM THE BEST AVAILABLE COPY

BZA11-78

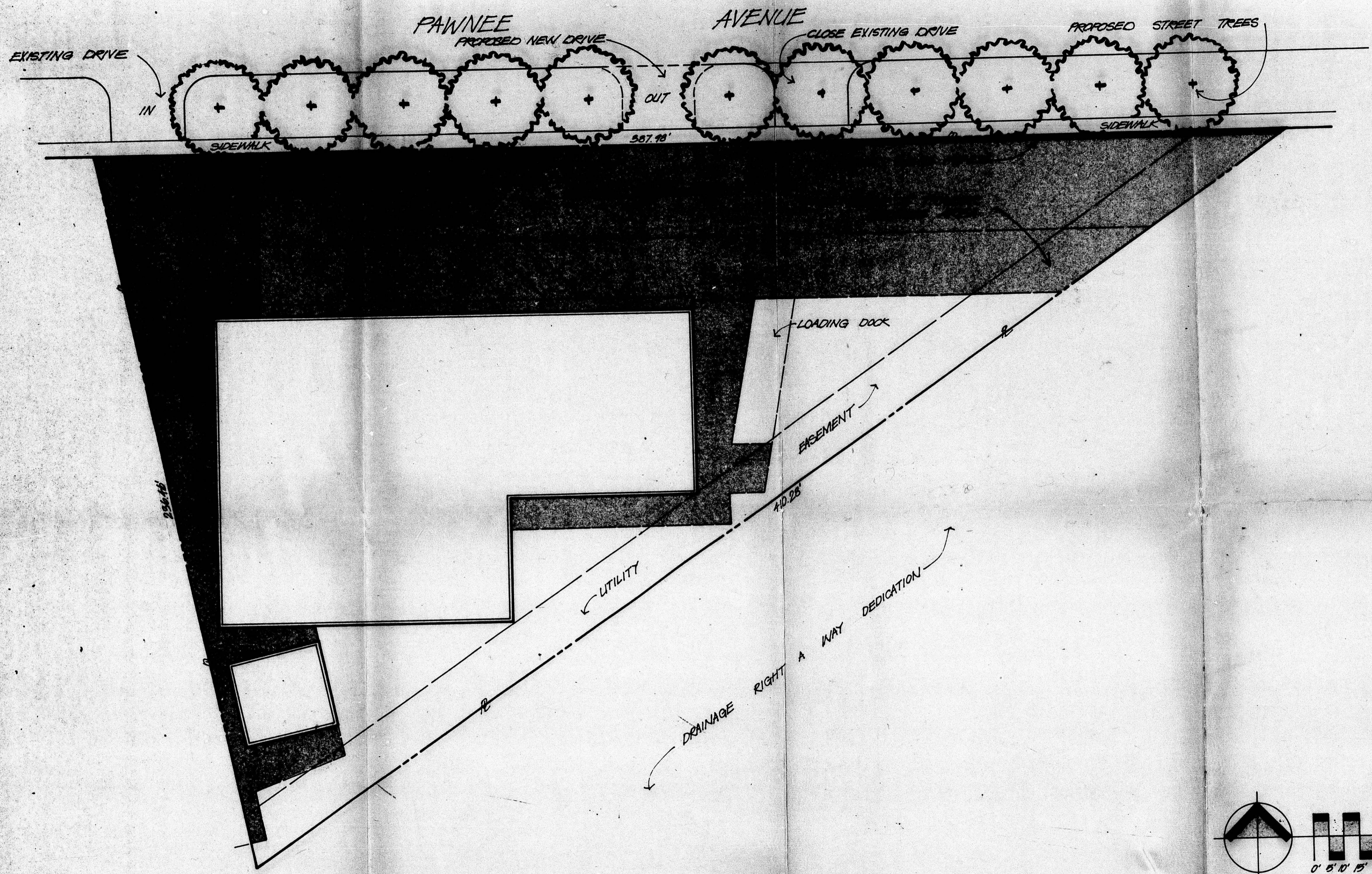

oblinger-smith  
 corporation  
 civil engineers  
 1001 1/2 N. 1st St.  
 Oklahoma City, Okla. 73102

Drawn  
 Checked  
 Revised  
 Date 9-27-78  
 Scale 1" = 50'

**BZA EXCEPTION & VARIANCE**

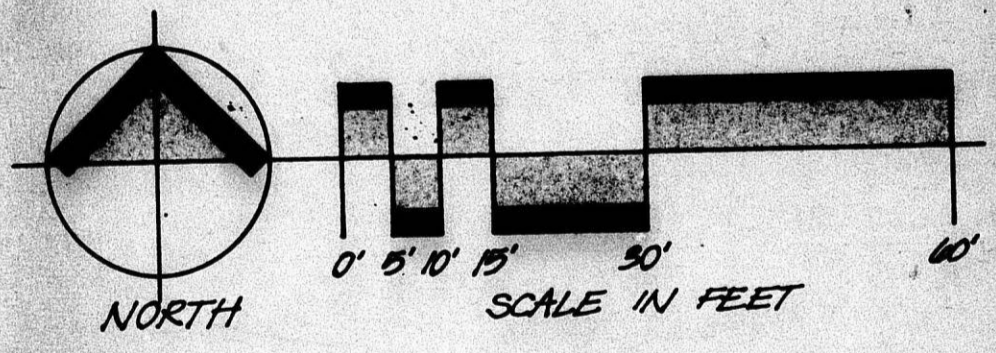

Sheet  
 of

FILMED FROM THE  
 ORIGINAL COPY