

LEGENDS & REFERENCING

Section No. / Sheet No.	BUILDING SECTION
Section No. / Sheet No. / Direction	MECHANICAL SECTION
Schedule No. / Sheet No.	DOOR REFERENCE
Detail No. / Sheet No.	DETAIL REFERENCES
Elev. No. / Sheet No.	ELEVATION REFERENCES
No. No.	ROOM REFERENCES

SHEET SCHEDULE

ARCHITECTURAL

- Site Plan, Project Data, Layouts, Sheet Index
- Foundation Plan, Footing and Column Details
- Roof Framing - 2nd Floor Framing
- Foundation Plan, Footing and Column Details
- Roof Framing - 2nd Floor Framing

MECHANICAL

- Main and Second Floor Mechanical Plans
- Plumbing Plans, Floor Diagrams, Schedules

ELECTRICAL

- Main and Second Floor Reflected Ceiling and Recessed Light Plans
- Panel Schedules and Floor Diagrams

SOIL BORING LOG
 P&R ENGINEERING TESTING CO.
 REPORT DATED 17 JAN 84

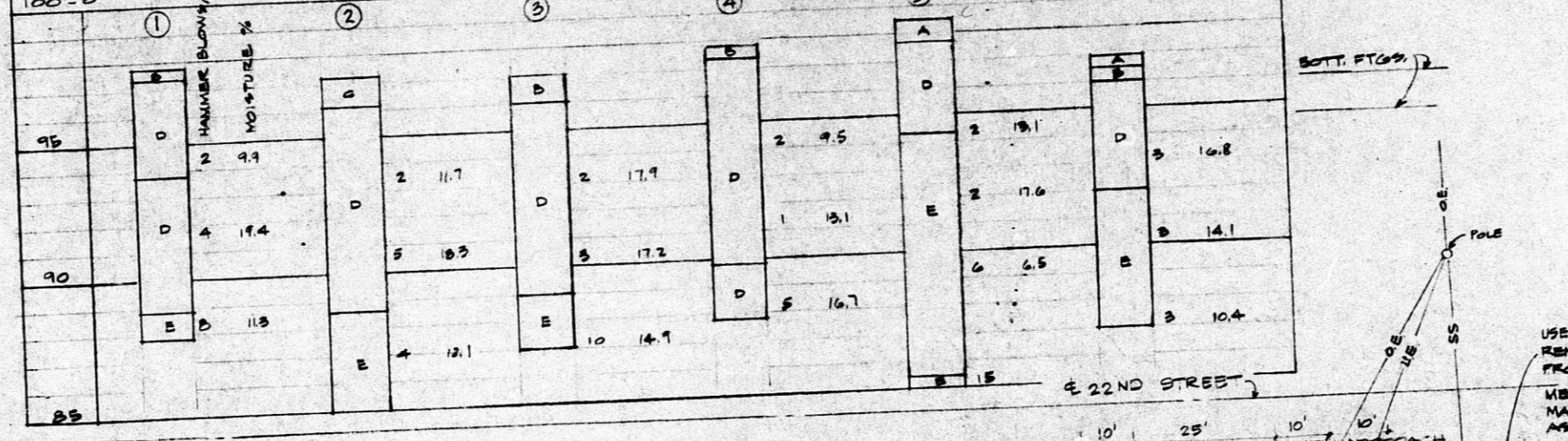

PROJECT DATA

Legal Description: Pleasant Valley Church Addition
 Zoning: M
 Permits: 1/3 Secretary Seating Room, Secretary Seating Room, Existing Permits: 88, Revised Permits: 89, Future Permits: 89 (other)
 Flood Plains: No
 Existing Area: Church/Classrooms: 738 sq. ft., 715 sq. ft., 14,725 sq. ft.
 Type V 1 hr. const., 2-2, A 2.1.
 New Addition Area: First Floor: 857 sq. ft., Second Floor: 223 sq. ft., Ceiling: 688 sq. ft.
 Building Type: V 1 hr.
 Occupancies: A 2.1, A-3
 Area Separation: 2 hr.
 Live Loads: 30 Roof, 40 Floor, etc.
 Occupant Load: Gymnasium: 130, Classrooms: 116 contains, 66 contains = 182
 *R Values: Walls: 0.5 B.U., Roof:
 Plumbing Fixtures Provided:

WC	Bath	Total
15	3	17
UR	2	3
DF	1	3
LV	11	15

 Plumbing Fixtures Required: UPC 102, 2 SINKS, 1 WC, 1 UR, 1 DF, 11 LV
 Automatic Sprinkler: none
 Fire Hydrant: NW CORNER 22ND & POWER ST
 Electric Service: Exist: _____

BUILDING MATERIALS

[Symbol]	Asphalt Paving
[Symbol]	Concrete
[Symbol]	Brick
[Symbol]	Steel
[Symbol]	Metal Stud Pan.
[Symbol]	Block
[Symbol]	Opp. Bd./Snd
[Symbol]	Plywood
[Symbol]	Rough Fining
[Symbol]	Finish Wood Trim
[Symbol]	Rigid Insulation
[Symbol]	Batt Insulation
[Symbol]	Earth
[Symbol]	Gravel

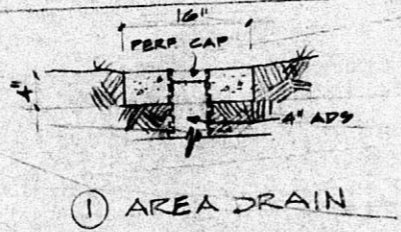
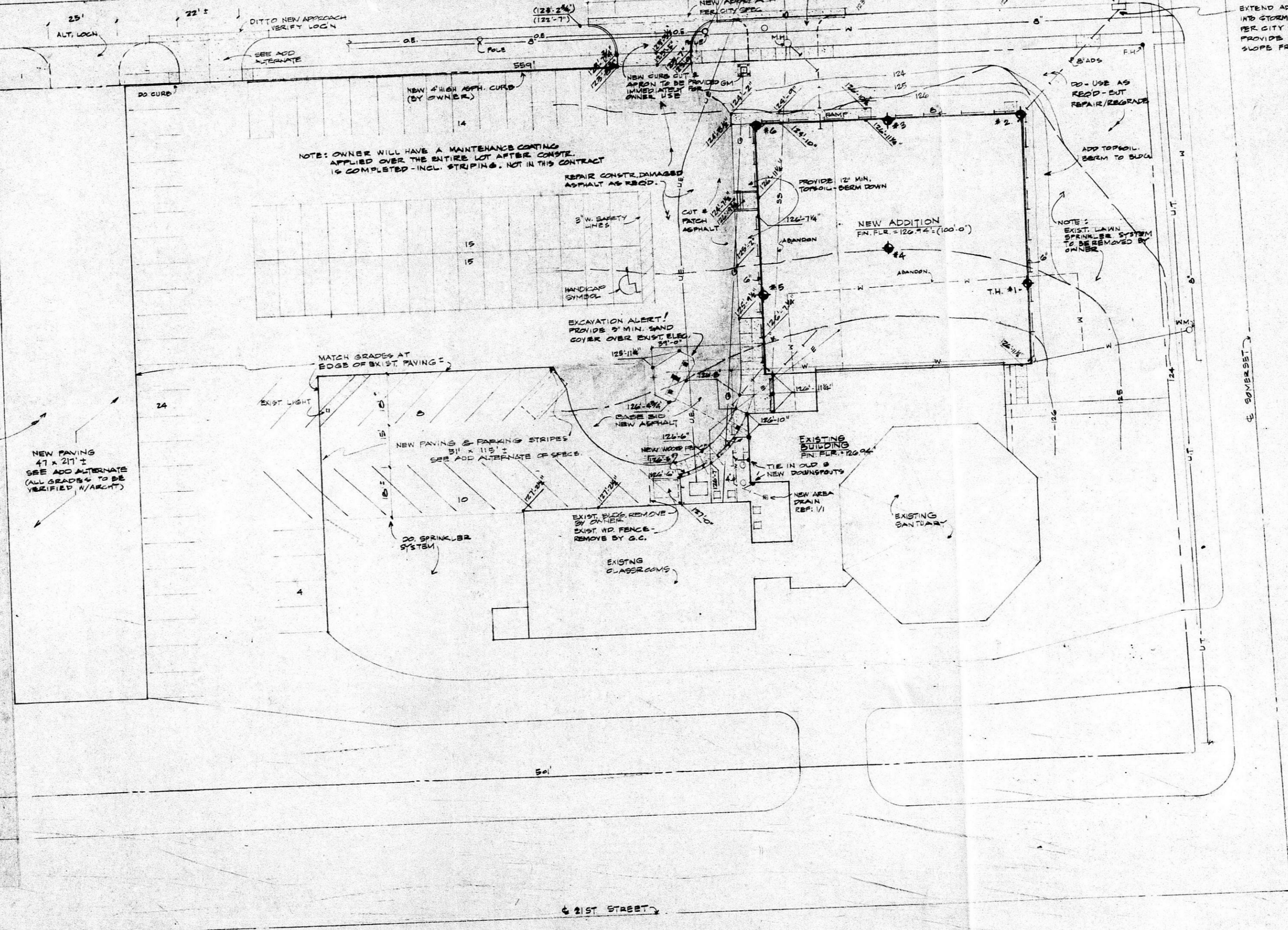

SITE PLAN
 BZA 18-84

BZA 18-84

PARKS & PARKS ARCHITECTS

WICHITA, KANSAS

ADDITION TO THE EVANGEL ASSEMBLY OF GOD

1620 W. 21st STREET