

MAP No. U-1
 SEC. 11
 TWP. 28
 RANGE 7W
 NH'D

DATA SHEET

(CU) U-1-11 - 33
 FILED 4-1-60

APPLICATION DATA: FROM N.A. TO N.A.
 1. APPLICANT CLACINA LEENDERTSE, PETER H. LEENDERTSE & CORNELIA LEENDERTSE
4001 WEST 39TH STREET SOUTH JA 4-3558 TSE
 2. AGENT R. E. RAY - 439 S. MAIN FO 3-7209
 3. LOCATION SOUTH SIDE OF 31st St. BEHIND AND
MILE WEST OF WEST STREET (ADDRESS)
 4. PROPOSED USE SAND PIT

AREA DATA
 1. ACRES 30 (1320 FT. BY 2650 FT.)
 2. ADJOINING ZONING: E E S E W E N E
 3. LAND USE: EAST VACANT SOUTH VACANT
 WEST VACANT NORTH SAND PIT
 4. SKETCH PLAN LAND USE IS FOR Industrial
 5. PRESENT LAND USE IS FOR VACANT
 6. AREA IS IS NOT PLATTED.
 7. ACRES OF PROPOSED ZONING WITHIN NEIGHBORHOOD UNIT.

PHOTO DATA: R. E. Ray DATE 4-29-60 TIME 2 PM
 TAKEN BY

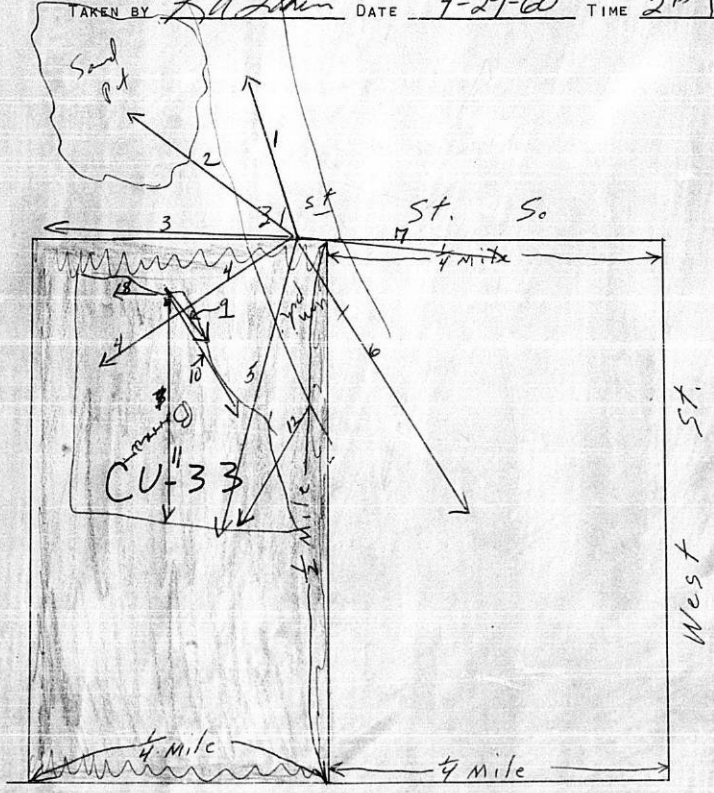

RESOLUTION

*file
Co. CU approved
150110*

COUNTY COMMISSIONERS OF SEDGWICK COUNTY, KANSAS

A RESOLUTION PERMITTING A BORROW PIT AS A CONDITIONAL USE ON THE WEST HALF (W $\frac{1}{2}$) OF THE NORTHEAST QUARTER (NE $\frac{1}{4}$) IN SECTION 11, TOWNSHIP 28 SOUTH, RANGE 1 WEST IN THE AREA ONE-FOURTH ($\frac{1}{4}$) MILE WEST OF WEST STREET AND IMMEDIATELY SOUTH OF 31ST STREET ON THE WEST SIDE OF INTERSTATE 235 RIGHT-OF-WAY, SAID LANDS LOCATED WITHIN THE UNINCORPORATED TERRITORY LYING WITHIN THREE (3) MILES OF THE CITY OF WICHITA, IN SEDGWICK COUNTY, KANSAS, UNDER THE AUTHORITY GRANTED BY SECTION 11 E OF THE ZONING RESOLUTION, AS AMENDED, ADOPTED BY THE BOARD OF COUNTY COMMISSIONERS MARCH 3, 1958, OF SEDGWICK COUNTY, KANSAS.

BE IT RESOLVED by the Board of County Commissioners of Sedgwick County, Kansas:

SECTION I. That upon the recommendation of the Metropolitan Area Planning Commission, after notice and a public hearing as provided by law, and under authority granted by Section 11 E of the Sedgwick County Zoning Resolution, as adopted March 3, 1958, a conditional use of the lands hereinafter legally described is hereby allowed, as follows:

CU-33. Beginning at a point on the half section line 250 feet north of the southwest (SW) corner of the northeast quarter (NE $\frac{1}{4}$) of section eleven (11), Township twenty-eight (28) south, range one (1) west; thence north along the half section line to the northwest (NW) corner of said northeast quarter (NE $\frac{1}{4}$); thence east along the section line to the right-of-way of Interstate Route No. 235; thence southeasterly along said right-of-way of Interstate Route No. 235 to the point where the west side of the right-of-way of the Missouri Pacific railroad intersects with the right-of-way of Interstate Route No. 235; thence south along the west line of the Missouri Pacific Railroad right-of-way to a point on said right-of-way 250 feet north of the south line of said northeast quarter (NE $\frac{1}{4}$); thence west parallel with the south line of said northeast quarter (NE $\frac{1}{4}$) to the point of beginning,

is hereby approved for use as a borrow pit subject to the conditions as follows:

- I. A fifty-eight (58) inch V-mesh fence on no less than seven (7) foot steel posts with the posts at no more than sixteen (16) foot spacing shall be constructed along the property line and may provide for reasonable access gates installed at the height of the fence which shall be kept locked except when in use.

2. Excavation shall not approach nearer than 100 feet to the center line of 31st Street South nor nearer than six feet to the east and west property lines nor nearer than 250 feet to the south property line.
3. Along the north and south boundary lines there shall be installed a shelter belt consisting of two (2) rows of plantings and the installation and composition of said shelter belt shall be in accordance with specifications the Soil Conservation Service.
4. Vegetative cover for slopes should consist of a short perennial, drought-resistant grass or combination of grasses which will permit the establishment of a good sod cover.
5. The side slope of the excavation shall be no more steep than five (5) to one (1) slope.
6. A performance bond shall be presented to cover the maintenance of the shelter belt and in an amount of \$2,500. Such bond to be filed in the office of the County Clerk and to run in favor of the County. This bond shall be kept in full force and effect during the operation of the sand pit and for a period of two years from the cessation of such operation of the sand plant.
7. The applicant shall submit a restrictive covenant satisfactory to County legal Counsel, providing that no foreign matter, such as rubbish, car bodies, etc., be deposited within the excavation area.
8. The natural drainage flow shall be maintained and protected through the area. Any improvements made in the natural drainage or any obstructions or diversions shall be done with the approval of the proper city or county authorities and shall be done according to the restrictions and standards of those authorities.

SECTION II. That upon the taking effect of this resolution the above conditional use shall be permitted.

SECTION III. This resolution shall take effect and be in force from and after its adoption.

Passed and adopted this 26th day of May, 1960.

S/ H. B. Scott
H. B. Scott

ATTEST:

S/ Frank Fisher
Frank Fisher

S/ W. O. Williams
County Clerk

S/ Vernon E. Reed
VERNON E. Reed

(SEAL)

1-1