

6445
 Map No. H-13A & D
 Sec. 38 3/4
 Twp. 27
 Range 2E

DATA SHEET
 (ZONING & CONDITIONAL USE)

Z- _____
 SCZ- _____
 CU- 153
 Filed 7-3-73

APPLICATION DATA: From _____ to _____
 1. Applicant: Frank J. Kutilek, M.D.
 Address 8937 W. Central Phone 722-4258
 2. Agent: John Baird
 Address 707 Brown Bldg. Phone 262-8051
 3. General Location: South side of Harry one-fourth mile west of 159th St.
 Address _____
 4. Proposed Use: institutional home

AREA DATA:
 1. Acres: 5.9 (49% IRREGULAR) ft. by 577 ft.)
 2. Adjoining Zoning: E _____ S _____ W _____ N _____
 3. Land Use: East FARM HOUSE South AGRICULTURE
 West AGRICULTURE North AGRICULTURE
 4. Sketch Plan Land Use is for: _____
 5. Present Land Use is for: UNDEVELOPED
 6. Area ~~is~~ (is not) platted.

PHOTO DATA:
 Taken by _____ Date _____ Time _____

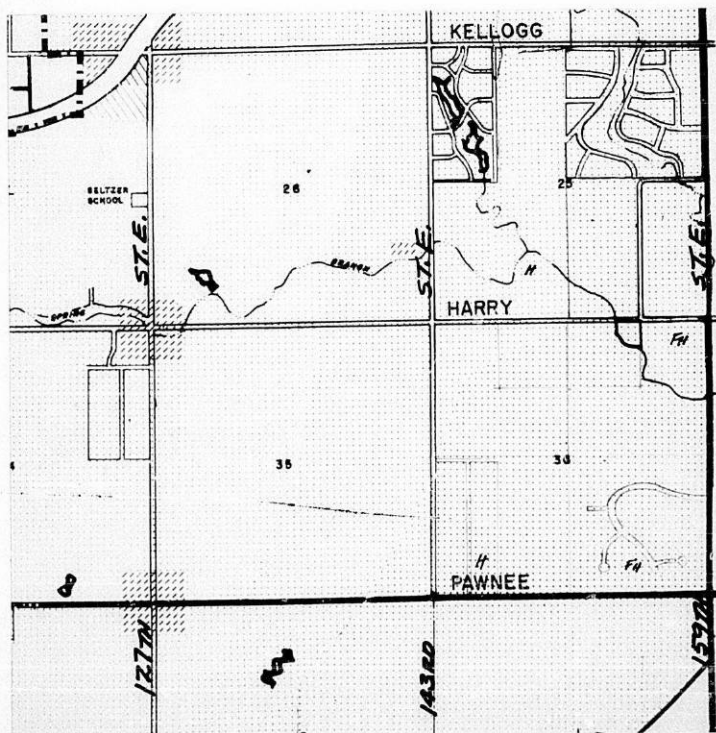

*Do not publish until
plot is recorded.
D.H.D. 8/16/73*

() Published in The Wichita Beacon on _____, 1973

R E S O L U T I O N

CASE NO. CU-153

A RESOLUTION PERMITTING THE ESTABLISHMENT OF AN
INSTITUTIONAL HOME (NURSING HOME) IN THE "AA"
ONE FAMILY DWELLING DISTRICT

ON CERTAIN LANDS LOCATED WITHIN THE UNINCORPORATED TERRITORY LYING WITHIN THREE MILES OF EITHER THE CITY OF WICHITA, THE CITY OF HAYSVILLE, THE CITY OF DERBY, THE CITY OF MULVANE, THE CITY OF VALLEY CENTER, OR THE CITY OF GODDARD, ALL IN SEDGWICK COUNTY, KANSAS, UNDER THE AUTHORITY GRANTED BY SECTION 5.10. g) AND SECTION 11.E OF THE ZONING RESOLUTION ADOPTED BY THE BOARD OF COUNTY COMMISSIONERS OF SEDGWICK COUNTY, KANSAS, ON MARCH 3, 1958, AND SUBSEQUENT AMENDMENTS THERETO.

BE IT RESOLVED BY THE BOARD OF COMMISSIONERS OF SEDGWICK COUNTY, KANSAS:

SECTION I. That after receiving a recommendation from Wichita-Sedgwick County Metropolitan Area Planning Commission and after said Planning Commission has given proper notice and held a public hearing as provided by law, and under authority granted by Section 5.10. g) and Section 11.E of the Zoning Resolution, as amended, a Conditional Use Permit to allow the establishment of an institutional home (nursing home) in the "AA" One Family Dwelling District is hereby approved on the lands legally described as follows:

Beginning at the northeast corner of the northwest quarter of the northeast quarter of Section 36-27S-2E; thence south bearing S. 00° 07' 36" west 577 feet to the centerline of Spring Branch of Fourmile Creek; thence northwesterly along the centerline of said creek to the north line of Section 36-27S-2E; thence east bearing S. 89° 54' 19" east 498 feet to the point of beginning. Generally located on the south side of Harry approximately one-fourth mile west of 159th Street.

SUBJECT TO:

1. The platting of subject property within one year from the date of approval by the Board of County Commissioners; or the application be considered denied and closed.
2. All building construction, modifications or conversions, sanitary facilities and water supply, shall meet all of the requirements of the State Board of Health, the State Fire Marshal's Office and the Wichita-Sedgwick County Health Department. Site plans shall be submitted to the Wichita-Sedgwick County Health Department for their approval.

SECTION II. That upon the taking effect of this Resolution, the notation of such Conditional Use approval shall be entered and shown on the particular sectional zoning map contained in the official zoning atlas on file in the Office of the County Zoning Administrator and in the Office of the Wichita-Sedgwick County Metropolitan Area Planning Department.

SECTION III. That this Resolution shall take effect and be in force from and after its adoption and publication in the official County paper.

PASSED AND ADOPTED at Sedgwick County, Kansas, this 15th day of August, 1973.

Carl E. Ruch
Chairman

Tom Reed
Commissioner

Edward Peters
Commissioner

ATTEST:

Marie Warden
Marie Warden, County Clerk
by Haron Shaving, Deputy
(SEAL)



() Published in The Wichita Beacon on _____, 1973

RESOLUTION

CASE NO. CU-153

A RESOLUTION PERMITTING THE ESTABLISHMENT OF AN
INSTITUTIONAL HOME (NURSING HOME) IN THE "AA"
ONE FAMILY DWELLING DISTRICT

ON CERTAIN LANDS LOCATED WITHIN THE UNINCORPORATED TERRITORY LYING WITHIN THREE MILES OF EITHER THE CITY OF WICHITA, THE CITY OF HAYSVILLE, THE CITY OF DERBY, THE CITY OF MULVANE, THE CITY OF VALLEY CENTER, OR THE CITY OF GODDARD, ALL IN SEDGWICK COUNTY, KANSAS, UNDER THE AUTHORITY GRANTED BY SECTION 5.10. g) AND SECTION 11.E OF THE ZONING RESOLUTION ADOPTED BY THE BOARD OF COUNTY COMMISSIONERS OF SEDGWICK COUNTY, KANSAS, ON MARCH 3, 1958, AND SUBSEQUENT AMENDMENTS THERETO.

BE IT RESOLVED BY THE BOARD OF COMMISSIONERS OF SEDGWICK COUNTY, KANSAS:

SECTION I. That after receiving a recommendation from Wichita-Sedgwick County Metropolitan Area Planning Commission and after said Planning Commission has given proper notice and held a public hearing as provided by law, and under authority granted by Section 5.10. g) and Section 11.E of the Zoning Resolution, as amended, a Conditional Use Permit to allow the establishment of an institutional home (nursing home) in the "AA" One Family Dwelling District is hereby approved on the lands legally described as follows:

Beginning at the northeast corner of the northwest quarter of the northeast quarter of SECTION 36-27S-2E; thence south bearing S.00° 07'36" west 577 feet to the centerline of Spring Branch of Fourmile Creek; thence northwesterly along the centerline of said creek to the north line of Section 36-27S-2E; thence east bearing S. 89°54'19" east 498 feet to the point of beginning. Generally located on the south side of Harry approximately one-fourth mile west of 159th Street.

SUBJECT TO:

1. The platting of subject property within one year from the date of approval by the Board of County Commissioners; or the application be considered denied and closed.
2. All building construction, modifications or conversions, sanitary facilities and water supply, shall meet all of the requirements of the State Board of Health, the State Fire Marshal's Office and the Wichita-Sedgwick County Health Department. Site plans shall be submitted to the Wichita-Sedgwick County Health Department for their approval.

SECTION II. That upon the taking effect of this Resolution, the notation of such Conditional Use approval shall be entered and shown on the particular sectional zoning map contained in the official zoning atlas on file in the Office of the County Zoning Administrator and in the Office of the Wichita-Sedgwick County Metropolitan Area Planning Department.

SECTION III. That this Resolution shall take effect and be in force from and after its adoption and publication in the official County paper.

13th PASSED AND ADOPTED at Sedgwick County, Kansas, this day of August, 1973.

Carl E. Ruch
Chairman

Am. Scott
Commissioner

Elmer Peters
Commissioner

ATTEST:

Marie Warden
Marie Warden, County Clerk
Marie Warden
(SEAL)

