

D-0127 - Louis M. & Mary Mitchell
dedicate portion of R/W for Mt.
Vernon between Bluff and Clifton

*Posted
6-18-59*

ACTION

DATE

7-9-59

COMMITTEE

Accept

M.A.P.C.

"

7-16-59

B.C.C./B. CO. C.

Appel

7-28-59

VACATION OR DEDICATION
CHECK LIST

CASE NO. D-0127 RECEIVED 6-16-59 BY B

S/D 7-9-59 MAP NO. H-7

MAPC ACTION _____

BCC ACTION _____

ORDINANCE NO. _____ CONSIDERED BY BCC _____ PUBLISHED _____

D-0127
D-0128
D-0129
Case Number D-0129 Map Number H-7 Change requested _____

S/D Meeting Date 7/9/59 Date Pictures taken _____ Planner _____

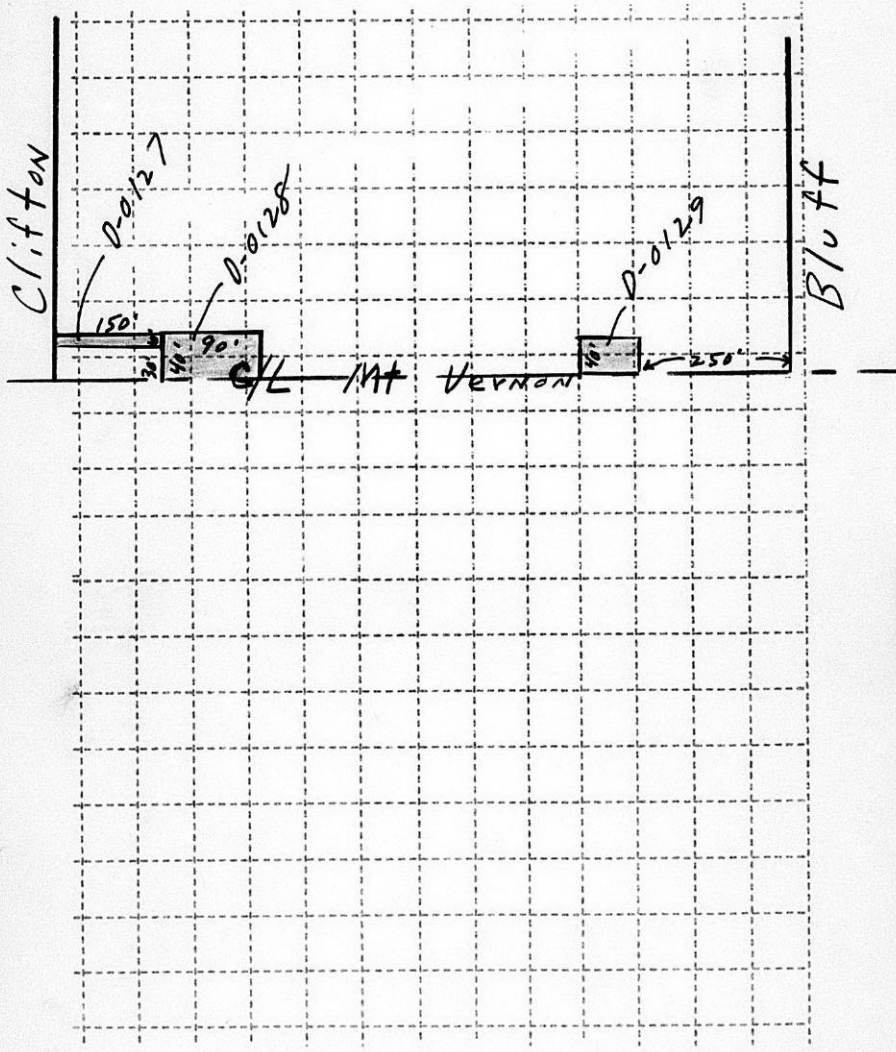

BCC
app
7-28-59

July 20, 1959

Board of City Commissioners
City Building
Wichita, Kansas

Gentlemen:

Re: D-0127, D-0128 and D-0129 -
Dedications for portion of
Mt. Vernon in an area between
Bluff and Clifton

At the regular meeting of the Metropolitan Area Planning Commission held on July 16, 1959, the above dedications were considered. These dedications are legally described as follows:

D-0127 - Dedication from Louis M. and Mary Mitchell for the south 10 feet of a tract beginning 30 feet north and 30 feet east of the southwest corner of the E $\frac{1}{2}$ of NW $\frac{1}{4}$ of Section 35, Township 27 South, Range 1 East, thence north 99.83 feet; thence east 150 feet; thence south 99.83 feet, thence west 150 feet to the point of beginning.

D-0128 - Dedication from E. R. and Ruby L. Lord for the south 40 feet of a tract beginning 180 feet east of the southwest corner of the E $\frac{1}{2}$ of the NW $\frac{1}{4}$ of Section 35, Township 27 South, Range 1 East; thence north 327.83 feet; thence east 90 feet; thence south 327.83 feet; thence west 90 feet to point of beginning.

D-0129 - Dedication from Ralph S. and Janice M. Brack for the south 40 feet of a tract beginning 294 feet east of the southwest corner of the east one-half of the south 10 acres of the east half of the NW $\frac{1}{4}$ of Section 35, Township 27 South, Range 1 East; thence north to the north line of said south 10 acres; thence east 74 feet; thence south to the south line of said south 10 acres; thence west to point of beginning.

It was moved, seconded and carried unanimously that the Planning Commission recommend to the Board of City Commissioners that the above dedications be approved.

Respectfully submitted,

LLL:LRE:ber

L. L. Little
Director of Planning