

M.A.P.C.

Appears 6-6-63

~~B.C.C./B-CO-C.~~

Appears 6/18/63

Closed

D-0242 - Doless Bros. Co. offers
W₁ of Amidon bet. Arkansas River
and 21st Street

POSTED
5-19-63

ACTION

		DATE
5/D COMMITTEE	<u>Approved</u>	5/29/63
M.A.P.C.	<u>Approved</u>	6-6-63
B.C.C./B. CO. C.	<u>Approved</u>	6/18/63

Closed

D-0242 - Dolise Bros. Co. offers
1/2 of Amidon Det. Arkansas River
and 21st Street

DEDICATION REPORT AND PROGRESS

MAP No. 0-3
 SEC. No. 7
 TWP. No. 27
 RANGE 1E

CASE No. D - 0242

I. OFFER TO DEDICATE: W $\frac{1}{2}$ of Amidon
 GENERALLY LOCATED: Between Arkansas River and 21st Street

LEGALLY DESCRIBED AS:

Beg. at the NE corner of the NW $\frac{1}{4}$ of Section 7-27S-1E of the 6th P.M.; thence S along the E line of said NW $\frac{1}{4}$ to the left bank of the Arkansas River; thence NWly along said left bank to a point 50 feet W of the E line of said NW $\frac{1}{4}$; thence N parallel to said E line to the N line of said NW $\frac{1}{4}$; thence E 50 feet to the point of beginning. (See application for dedication of access rights)

DEDICATED BY: Dolese Bros. Co.

AGENT:

ADDRESS: _____ PHONE _____

PURPOSE OF DEDICATION:

Street purposes.

II. SKETCH.

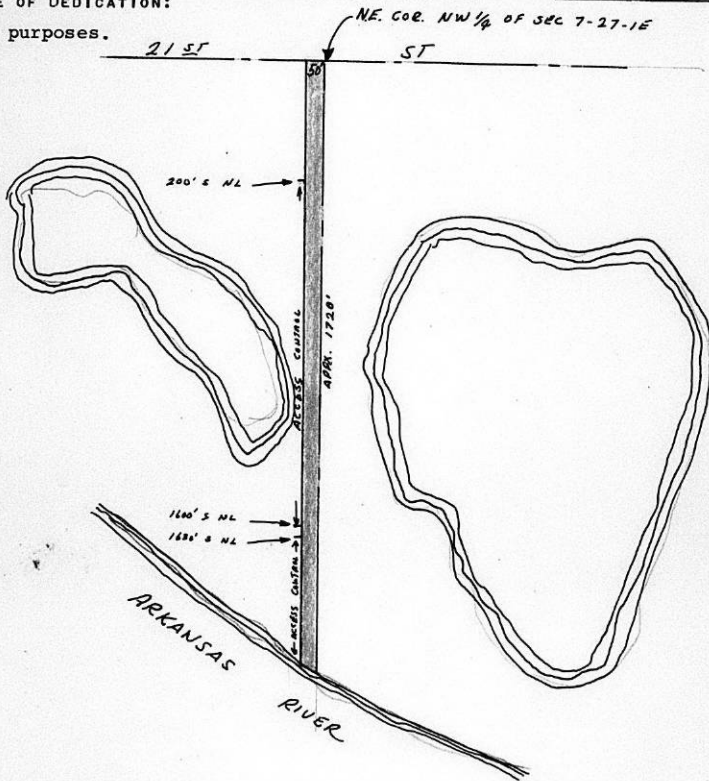

III. OFFER RECEIVED 5-13-63
 POSTED TO ATLAS 5-19-63
 *S/D COMM. ACTION 5-29-63 Approved
 *M.A.P.C. ACTION 6-1-63 Approved

*B.C.C. ACTION 6-18-63 Approved

PLACED ON RECORD _____
 CITY CLERKS No. _____

W. R. Spaulding
Notary Public

DEDICATION

KNOW ALL MEN BY THESE PRESENTS:

That for and in consideration of the sum of One Dollar (\$1.00 and other good and valuable considerations, the receipt of which is hereby acknowledged, the undersigned, Dolese Bros. Co., a Delaware corporation, being the owners of the following described real estate in Sedgwick County, Kansas, to wit:

Beginning at the northeast corner of the Northwest Quarter of Section 7, Township 27, South, Range 1 East of the 6th P. M.; thence south along the east line of said Northwest Quarter to the left bank of the Arkansas River; thence northwesterly along said left bank to a point fifty (50) feet west of the east line of said Northwest Quarter; thence north parallel to said east line to the north line of said Northwest Quarter; thence east fifty (50) feet to the point of beginning.

Also, all abutter's rights of access to or from Amidon Avenue across the following described lines:

Beginning at a point fifty (50) feet west and two hundred (200) feet south of the northeast corner of the Northwest Quarter of Section 7, Township 27, South, Range 1, East of the 6th P. M.; thence south parallel to the east line of said Northwest Quarter to a point one thousand six hundred (1600) feet south of the north line of said Northwest Quarter;

Beginning at a point fifty (50) feet west and one thousand six hundred thirty (1630) feet south of the northeast corner of the Northwest Quarter of Sec 7, Township 27, South, Range 1, East of the 6th P. M.; thence south parallel to the east line of said Northwest Quarter to the left bank of the Arkansas River;

does hereby dedicate the above described real estate to the public for street purposes, provided, however, that this dedication is made expressly subject to the following conditions:

1. Dolese Bros. Co. owns and operates a sand plant upon property adjacent to and west of the property hereinabove dedicated for street purposes and said company and its successors and assigns shall have the right and privilege of operating its trucks upon Amidon Street between 21st Street and 13th Street in the City of Wichita, Kansas, until the sand deposit on the above mentioned land owned by Dolese Bros. Co. has been depleted or until Dolese Bros. Co. ceases to conduct sand producing operations upon its such property, whichever occurs first;
2. The City of Wichita, Kansas at its own expense shall erect a permanent type fence that complies with the ordinances of such city along the entire east side of the property owned by Dolese Bros. Co. which fence shall be located on the west line of the property hereinabove dedicated for street purposes.

Executed this 29th day of April, 1963.

Dolese Bros. Co. a Delaware corporation

By _____
Executive Vice-President



W. R. Spaulding
Assistant Secretary

STATE OF OKLAHOMA)
) SS:
COUNTY OF OKLAHOMA)

Be it remembered, that on this 29th day of April, 1963, before me, the undersigned, a Notary Public in and for the county and state aforesaid, came Troy Shelton, Executive Vice-President of Dolese Bros. Co., a corporation, and J. R. Spear, Assistant Secretary of said corporation, who are personally known to me to be the same persons who executed the within and foregoing instrument of writing as Executive Vice-President and Assistant Secretary, respectively, and said Troy Shelton, as Executive Vice-President of said corporation, duly acknowledged the execution of the same to be the act of the corporation; and J. R. Spear, Assistant Secretary of the said corporation; duly acknowledged the attestation of the same as such Assistant Secretary for and on behalf of said corporation, and that he affixed thereto the common seal of said corporation.

In testimony whereof, I have hereunto subscribed my name and affixed my official seal, on the day and year last above written.

Notary Public

My Commission expires:



Submitted to the Wichita - Sedgwick County Metropolitan Area Planning Commission and the Board of Commissioners of the City of Wichita, Kansas, and approved by said Board of Commissioners of the City of Wichita, Kansas,

this _____ 19 _____

City Clerk

June 13, 1963

Board of City Commissioners
City Building
Wichita, Kansas

Gentlemen:

Subject: D-0242 - Dedication
for portion of Amidon between
Arkansas River and 21st Street

At its regular meeting on June 6, 1963, the Metropolitan Area Planning Commission considered the above dedication, which is legally described as follows:

Beginning at the northeast corner of the Northwest Quarter of Section 7, Township 27, South, Range 1 East of the 6th P.M.; thence south along the east line of said Northwest Quarter to the left bank of the Arkansas River; thence northwesterly along said left bank to a point 50 feet west of the east line of said Northwest Quarter; thence north parallel to said east line to the north line of said Northwest Quarter; thence east 50 feet to the point of beginning.

Also, all abutter's rights of access to or from Amidon Avenue across the following described lines:

Beginning at a point 50 feet west and 200 feet south of the northeast corner of the Northwest Quarter of Section 7, Township 27, South, Range 1, East of the 6th P.M.; thence south parallel to the east line of said Northwest Quarter to a point 1600 feet south of the north line of said Northwest Quarter;

Beginning at a point 50 feet west and 1630 feet south of the northeast corner of the Northwest Quarter of Section 7, Township 27, South, Range 1, East of the 6th P.M.; thence south parallel to the east line of said Northwest Quarter to the left bank of the Arkansas River.

Page 2 - Board of City Commissioners
June 13, 1963

It was moved, seconded and carried unanimously that the Planning Commission recommend to the Board of City Commissioners that this dedication be accepted.

Respectfully submitted,

L. L. Little
Secretary

LLL:GLS:ber

