

M.A.P.C. Appone 2-6-64

B.C.C./B.C.C.C. Appone ²⁻²⁵⁻⁶⁴
~~2-18-64~~

Closed

D-0260 - Robert L. & Gladys M.
Norman offer $W\frac{1}{2}$ of Sabin in an
area N of St. Louis

POSTED
1-8-64

ACTION

	DATE
S/D COMMITTEE	Approve 1-30-64
M.A.P.C.	Approve 2-6-64
B.C.C./B.C.C.C.	Approve 2-18-64 2-25-64

Closed

D-0260 - Robert L. & Gladys M.
Norman offer W³ of Sablin in an
area N of St. Louis

DEDICATION REPORT AND PROGRESS

MAP No. F-1
 SEC. No. 23
 TWP. No. 27
 RANGE 1W

CASE No. D - 0260

I. OFFER TO DEDICATE: W $\frac{1}{2}$ of Sabin
 GENERALLY LOCATED: In an area N of St. Louis

LEGALLY DESCRIBED AS:

The E 30 feet of the N $\frac{1}{2}$ of Lot 8, Block 6, Parkwilde Addition.

DEDICATED BY: Robert L. & Gladys M. Norman
 AGENT: _____
 ADDRESS: _____ PHONE _____
 PURPOSE OF DEDICATION: _____
 Street purposes.

II. SKETCH.

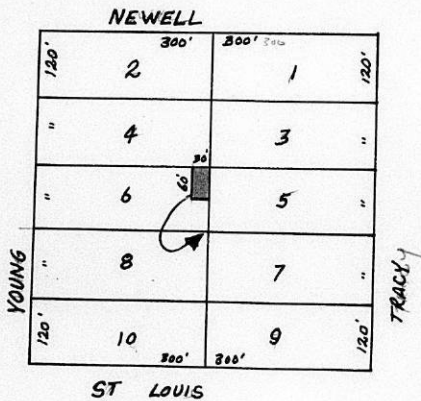

III. OFFER RECEIVED 1-6-64 *B.C.C. ACTION 2-25-64 Approved
 POSTED TO ATLAS 1-8-64
 *S/D COMM. ACTION 1-30-64 Approved PLACED ON RECORD _____
 *M.A.P.C. ACTION 2-6-64 Approved CITY CLERKS No. _____

Dedication of: $w\frac{1}{2}$ Sabin Street

MAPC Case No. D-0260

Dedicated by: Robert L. and Gladys M. Norman

Approved by MAPC: 2-6-64

General Location: Generally located in an area north of St. Louis

Reason for Acceptance: To acquire needed right-of-way which would eventually allow the further extension of Sabin Street. This extension would permit adjacent property owners to further subdivide their lots which are now 300 feet in depth.

City Manager's Recommendation: Accept the Dedication and instruct the City Clerk to file with the Register of Deeds.
Form T21-325

w/2 Subin
NE 1/4 Sec 22 T27S R1W
N of St. Louis bet. Young
& Tracy

DEDICATION

KNOW ALL MEN BY THESE PRESENTS:

That for and in consideration of the sum of One Dollar (\$1.00) and other good and valuable considerations, the receipt of which is hereby acknowledged, the undersigned, Robert L. Norman and Gladys H. Norman

being the owner of the following described real estate in Sedgwick County, Kansas, to wit:

East thirty (30) feet of the north half of lot 2, Block 5, Parkside Addition.

1

do hereby dedicate the above described real estate to the public for street purposes.

Executed this 31 day of August, 19 41.

STATE OF KANSAS)
SEDGWICK COUNTY) SS

BE IT REMEMBERED, that on this 31 day of August 19 41 before me a Notary Public in and for the said County and State came Robert L. Norman and Gladys H. Norman

to me personally known to be the same person who executed the foregoing instrument and duly acknowledged the execution of the same.

IN WITNESS WHEREOF, I have hereunto subscribed my name and affixed by official seal, the day and year last above written.

Notary Public

My Commission Expires: _____