

Posted  
3-17-65

ACTION

S/A COMMITTEE <sup>with</sup> Receipt 3-25-65  
M.A.P.C. Receipt 4-1-65  
B.C.C. ~~Receipt~~ Accepted 4-20-65

Closed 4-20-65

D-0280 - Dedication of south half of  
21st Street, west of Amidon from  
Dolese Bros. Co.

DEDICATION REPORT AND PROGRESS

MAP No. D-3  
 SEC. No. 7  
 TWP. No. 27  
 RANGE 1E

CASE No. D - 0280

I. OFFER TO DEDICATE: half-street right of way for S $\frac{1}{2}$  of 21st  
 GENERALLY LOCATED: South  $\frac{1}{2}$  of 21st Street, west of Amidon

LEGALLY DESCRIBED AS: Beginning 50 feet W of the NE corner of the NW $\frac{1}{4}$  of Section 7, Township 27 South, Range 1 East of the 6th P.M.; thence W along the N line of said NW $\frac{1}{4}$  a distance of 450 feet; thence S a distance of 20 feet; thence SEly to a point 50 feet S of the N line of said NW $\frac{1}{4}$  and 450 feet W of the E line of said NW $\frac{1}{4}$ ; thence E parallel to the N line of said NW $\frac{1}{4}$  a distance of 400 feet; thence N to the point of beginning; except existing street right of way.

DEDICATED BY: Dolese Bros, Co.  
 AGENT: Troy Shelton, Executive Vice President  
 ADDRESS: Dolese Bros, Co. PHONE \_\_\_\_\_  
 PURPOSE OF DEDICATION: Street purposes

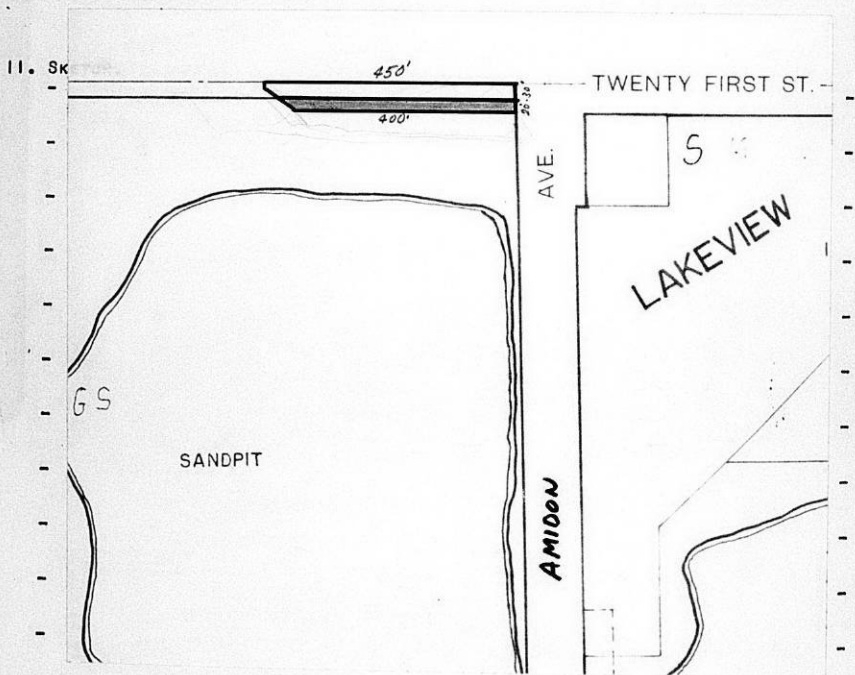

III. OFFER RECEIVED 3-15-65 \*B.C.C. ACTION 4-20-65 Accepted  
 POSTED TO ATLAS 3-17-65  
 \*S/D COMM. ACTION 3-25-65 Accept PLACED ON RECORD \_\_\_\_\_  
 \*N.A.P.C. ACTION 4-1-65 Accept CITY CLERKS No. \_\_\_\_\_

Dedication of: Portion of 21st Street MAPC Case No. D-0280

Dedicated by: Dolese Bros. Co. a corporation Approved by MAPC: 4-1-65

General Location: S $\frac{1}{2}$  of 21st Street in an area west of Amidon

Reason for Acceptance: To provide right-of-way width in accordance with policy.

City Manager's Recommendation: Accept the Dedication and instruct the City Clerk to file with the Register of Deeds.

Form T21-325

April 2, 1965

Mr. Troy Shelton  
Executive Vice President  
Dolese Brothers Company  
Oklahoma City, Oklahoma

Subject: <sup>D-6280-</sup> Dedication for half-  
street right-of-way for the  
south half of 21st Street, west  
of Amidon.

Dear Mr. Shelton:

At its regular meeting on April 1, 1965, the Metropolitan Area Planning Commission considered the above captioned dedication. The action of the Planning Commission was to recommend that this dedication be accepted.

This matter will now be forwarded to the Board of City Commissioners on April 20, 1965.

If you have any questions, please feel free to call.

Sincerely yours,

Jack H. Galbraith  
Senior Planner

JHG:JWH:mb

March 26, 1965

Mr. Troy Shelton  
Executive Vice President  
Dolese Brothers Company  
Oklahoma City, Oklahoma

Subject: D-0280 - Dedication for half-street right-of-way for  
the south half of 21st Street, west of Amidon.

Dear Mr. Shelton:

At its regular meeting on March 25, 1965, the Subdivision Committee of the Metropolitan Area Planning Commission considered the above captioned dedication. The action of the Subdivision Committee was to recommend that this dedication be accepted.

The recommendation of the Subdivision Committee that this dedication be accepted will be forwarded to the Planning Commission for their consideration at their next regular meeting on April 1, 1965.

If you have any questions, please feel free to call.

Sincerely,

Jack H. Galbraith  
Senior Planner

JHG:JWH:mb

D-3  
7  
27  
1E

Dolese  
E. Hall of 21st St.,  
W. of Ardmore

DEDICATION

KNOW ALL MEN BY THESE PRESENTS:

That for and in consideration of the sum of One Dollar (\$1.00) and other good and valuable considerations, the receipt of which is hereby acknowledged, the undersigned,

Dolese Bros. Co. a corporation

being the owner \_\_\_ of the following described real estate in Sedgwick County, Kansas, to wit:

Beginning fifty (50) feet west of the northeast corner of the Northwest Quarter of Section 7, Township 27, South, Range 1, East of the 6th P. M.; thence west along the north line of said Northwest Quarter a distance of four hundred fifty (450) feet; thence south a distance of twenty (20) feet; thence southeasterly to a point fifty (50) feet south of the north line of said Northwest Quarter and four hundred fifty (450) feet west of the east line of said Northwest Quarter; thence east parallel to the north line of said Northwest Quarter a distance of four hundred (400) feet; thence north to the point of beginning, except existing street right-of-way;

does hereby dedicate the above described real estate to the public for street purposes.

Executed this 8th day of March, 19 65.

Dolese Bros. Co.

B

Executive Vice President

Attest:

Assistant Secretary

**OKLAHOMA**

STATE OF ~~KANSAS~~  
SEDGWICK COUNTY) SS

OKLAHOMA

Personally appeared before me a notary public in and for the County and State

aforsaid Troy Shelton

to me personally known to be the same person who executed the foregoing instrument of writing and said person duly acknowledged the execution thereof for and on behalf of and as the act of Dolese Bros. Co.

Dated at Oklahoma City, Okla., this 8th day of March, 19 65.

My Commission expires \_\_\_\_\_

