

D-0357 - Dedication from Keith L. & Beverly B. Rowe of 10' additional half-street right-of-way for the south side of Kellogg, east of Crestway Avenue

*Passed
5-15-67*

ACTION

DATE

SD COMMITTEE No Hearing necessary

M.A.P.C. No Hearing necessary

B.C.C. ~~B-60-C~~ Accepted 5-23-67

Cloud 5-24-67

*Required in connection with
Case No. 7-0822*

DEDICATION REPORT AND PROGRESS

MAP No. 5746
 SEC. No. 26
 TWP. No. 27S
 RANGE 1E

CASE No. D - 0357

I. OFFER TO DEDICATE: 10' additional half-street R/W for S side of Kellogg
 GENERALLY LOCATED: just east of Crestway Avenue

LEGALLY DESCRIBED AS:

The north 10 feet of Lot 1, Block 1, Lincoln Heights 2nd
 Addition to the City of Wichita, Kansas

DEDICATED BY: Keith L. & Beverly B. Rowe, 4401-4403 E. Kellogg
 AGENT: Everett C. Fettis, Attorney
 ADDRESS: Suite 504 - 120 S. Market 67202 PHONE AM 7-7251
 PURPOSE OF DEDICATION:

Required in connection with Case No. Z-0822 - change from
 "A" to "BB"

II. SKETCH.

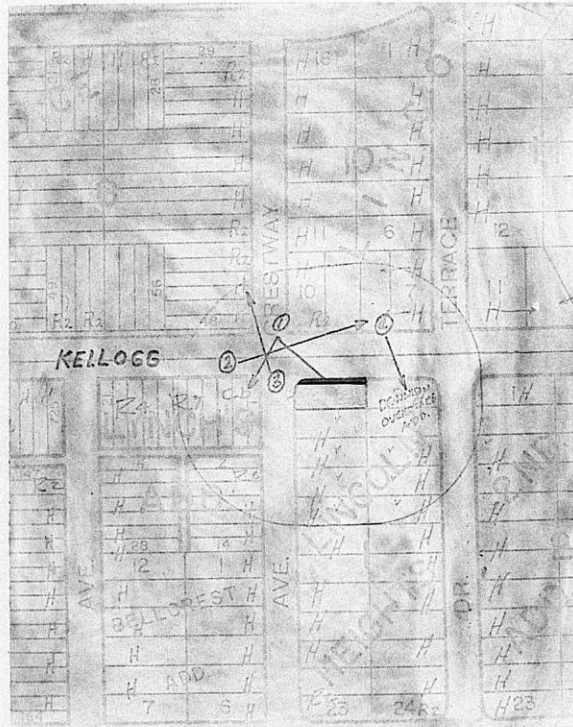

III. FILED 5-15-67 B.C.C. ACTION 5-23-67 *Accepted*
 POSTED TO ATLAS 574-67
 S/D COMM. ACTION No hearing neces. PLACED ON RECORD _____
 M.A.P.C. ACTION No hearing neces. CITY CLERKS No. _____

Dedication of: **street right-of-way**

MAPC Case No. **D-0357**

Dedicated by: **Keith L. and Beverly B. Rowe**

General Location: **10 feet additional half-street right-of-way for south side of Kellogg just east of Crestway Avenue**

Reason for Acceptance: **Required in connection with Case No. Z-0822**

City Manager's Recommendation: **Accept the Dedication and instruct the City Clerk to file with the Register of Deeds.**

