

D-0370 - Dedication from Ray G. & Oakley D. Harris for 40' of R/W for the east-half of Gouverneur Road lying south of Harry and 1/2 mile east of Woodlawn

ACTION

POSTED
9-13-67

DATE

9-21-67

S/S COMMITTEE

Accept

M.A.P.C.

9-28-67

Accept

B.C.C. ~~COFC~~

10-10-67

Accepted

Closed 10-10-67

DEDICATION REPORT AND PROGRESS

MAP No. H-9-A
SEC. No. 31
TWP. No. 27S
RANGE 2E

CASE No. D - 0370

I. OFFER TO DEDICATE: 40' of half-street R/W for the E½ of Gouverneur Rd.
GENERALLY LOCATED: lying south of Harry and 1/2 mile east
of Woodlawn

LEGALLY DESCRIBED AS:

DEDICATED BY: Ray G. & Oakley D. Harris, Union Center Bldg. AM 7-2831
AGENT: _____
ADDRESS: _____ PHONE _____
PURPOSE OF DEDICATION: _____

Requested in connection with S/D 67-16 - Grillot Addition

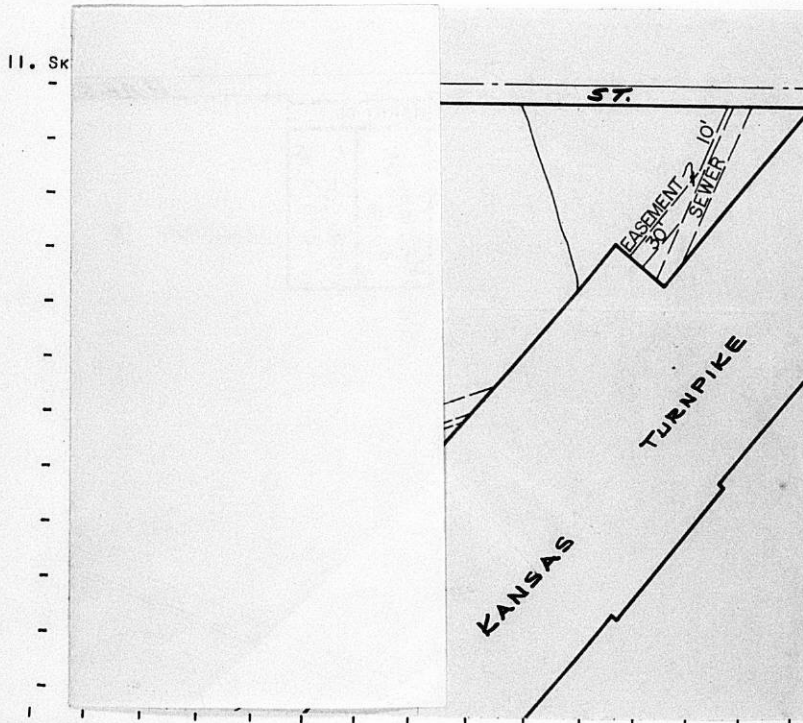

III. FILED 9-5-67
POSTED TO ATLAS 9-13-67
S/D COMM. ACTION 9-21-67 *Accept*
M.A.P.C. ACTION 9-21-67 *Accept*

B.C.C. ACTION 10-10-67 *Accepted*
PLACED ON RECORD _____
CITY CLERKS No. _____

DEDICATION REPORT AND PROGRESS

MAP No. H-9-A
SEC. No. 31
TWP. No. 27S
RANGE 2E

CASE No. D - 0370

I. OFFER TO DEDICATE: 40' of half-street R/W for the E½ of Gouverneur Rd.
GENERALLY LOCATED: lying south of Harry and 1/2 mile east
of Woodlawn

LEGALLY DESCRIBED AS:

DEDICATED BY: Ray G. & Oakley D. Harris, Union Center Bldg. AM 7-2831
AGENT: _____
ADDRESS: _____ PHONE _____
PURPOSE OF DEDICATION: _____

Requested in connection with S/D 67-16 - Grillot Addition

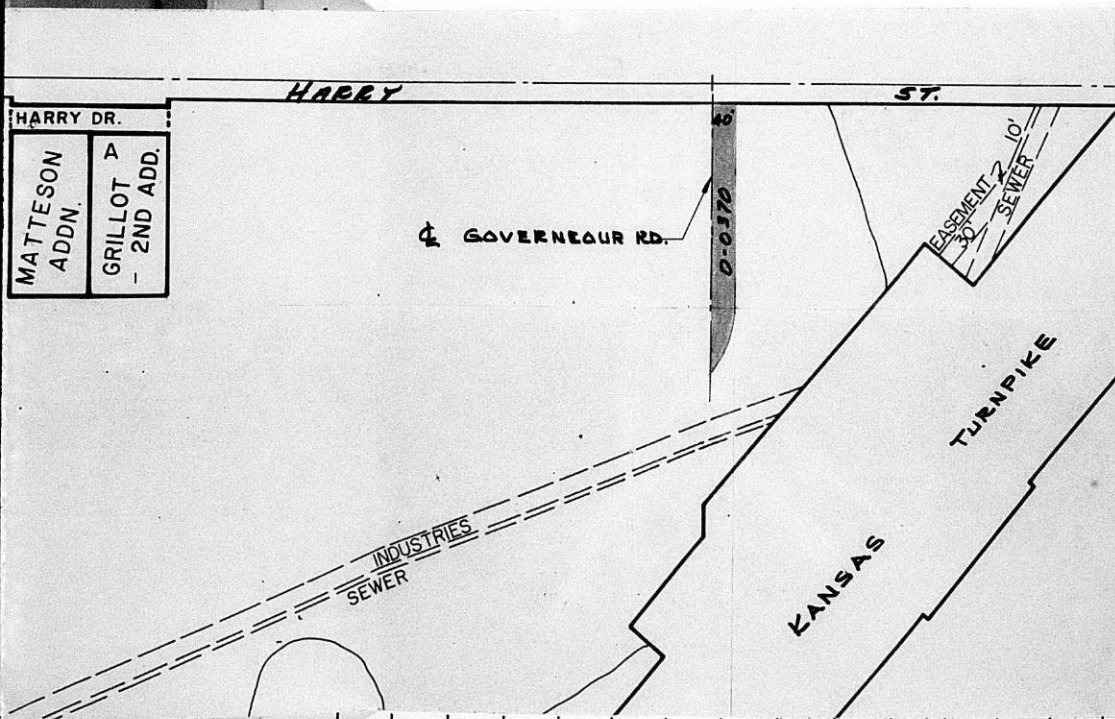

HARRY DR.	
MATTESON ADDN.	A
GRILLOT - 2ND ADD.	

III. FILED	<u>9-5-67</u>	B.C.C. ACTION	<u>10-10-67 Accepted</u>
POSTED TO ATLAS	<u>9-13-67</u>	PLACED ON RECORD	_____
S/D COMM. ACTION	<u>9-21-67 Accept</u>	CITY CLERKS No.	_____
M.A.P.C. ACTION	<u>9-28-67 Accept</u>		_____

Dedication of: 40' of half street R/W
for ~~the~~ of Gouverneur Road

MAPC Case No. D-0370

Dedicated by: Ray G. and Oakley D. Harris

Approved by MAPC: 9-28-67

General Location: South of Harry and 1/2 mile east of Woodlawn

Reason for Acceptance: Requested in connection with S/D 67-10 -
Grillot Addition

City Manager's Recommendation: Accept the Dedication and instruct
the City Clerk to file with the Register of Deeds.

Form Tg-325

October 2, 1967

Ray G. & Oakley D. Harris
Union Center Building
Wichita, Kansas 67202

Subject: D-0370 - Dedication for 40 feet of half-
street R/W for the E½ of Gouverneur Road lying
south of Harry and 1/2 mile east of Woodlawn

Dear Mr. and Mrs. Harris:

At its regular meeting on September 28, 1967, the Metropolitan Area Planning Commission considered the above-captioned offer of dedication. The action of the Planning Commission was to recommend that this dedication be accepted.

This matter will be forwarded to the Board of City Commissioners for its consideration at its regular meeting at 9:00 a.m., Tuesday, October 10, 1967, in Room 201, City Building, 204 South Main Street.

If you have any questions concerning this matter, please call.

Sincerely,

Jack H. Galbraith
Senior Planner

JHG:JDG:bgs

DEDICATION

A-9-A
31
275
2E

KNOW ALL MEN BY THESE PRESENTS:

That for and in consideration of the sum of One Dollar (\$1.00) and other good and valuable considerations, the receipt of which is hereby acknowledged, the undersigned, RAY G. AND OAKLEY D. HARRIS, husband
and wife

being the owner_s of the following described real estate in Sedgwick County, Kansas, to wit:

Beginning at the N. W. Corner of the NE $\frac{1}{4}$ of Sec. 31, Twp. 27-S, R-2-E; thence east 40 feet; thence south parallel with the west line of said NE $\frac{1}{4}$, 392.39 feet to the point of curvature of a curve to the right having a radius of 179.44 feet and a central angle of 39° 00'; thence along said curve 122.12 feet to the west line of said NE $\frac{1}{4}$; thence north 505 feet to the beginning.

do hereby dedicate the above described real estate to the public for roadway purposes.

Executed this fifth day of SEPTEMBER 1967

STATE OF KANSAS)
SEDGWICK COUNTY)^{ss}

BE IT REMEMBERED, that on this FIFTH day of SEPTEMBER, 1967

name RAY G. HARRIS AND OAKLEY D. HARRIS, HUSBAND AND WIFE

me personally known to be the same person_s who executed the foregoing instrument and duly acknowledged the execution of the same.

IN WITNESS WHEREOF, I have hereunto subscribed my name and affixed official seal, the day and year last above written.

mitted to the Wichita-Sedgwick
nty Metropolitan Area Planning
mission and the Board of Com-
missioners of the City of Wichita,
as, and approved by said Board
Commissioners of the City of
Wichita, Kansas,

City Clerk



Notary Public

My Commission Expires: FEB. 16, 1970