

M.A.P.C. accepted 4-25-68

~~B.C.C.~~ accepted 5-2-68

Closed 5-7-68

D-0392 - Woodlawn High Rise, Inc.
dedicates Street right-of-way and
abuttor's access rights for north-
east corner of 13th and Woodlawn

POSTED
4-11-68

ACTION

SID COMMITTEE approve ^{DATE} 4-18-68

M.A.P.C. accepted 4-25-68

~~B.C.C./D.C.C.~~ accept 5-7-68

Closed 5-7-68

D-0392 - Woodlawn High Rise, Inc.
dedicates Street right-of-way and
adaptor's access rights for north-
east corner of 13th and Woodlawn

MAP No. 5749
 MAP No. 5948
 Sec. No. 18
 TWP. No. 27
 RANGE 2E

DEDICATION REPORT AND PROGRESS
 CASE No. D - 0392

I. OFFER TO DEDICATE: Street Right-of-way and abutters access rights
 GENERALLY LOCATED: on the northeast corner of 13th & Woodlawn

LEGALLY DESCRIBED AS: STREET R-O-W: S 25' of the W 300 and W 25' of the N 275' of the S 300' of Lot 8, Block 5, McEwen's Sixth Addition to the City of Wichita Sedgwick County, Kansas.

ALL ABUTTER'S ACCESS RIGHTS: Adjacent to the W. 175' & S. 175' of the S. and W. lines of Lot 8 as platted, Block 5, McEwen's Sixth Addition to the City of Wichita Sedgwick County, Kansas.

ALL ABUTTER'S ACCESS RIGHTS EXCEPT FOR 2 OPENINGS: Adjacent to the N. 349.93' to the W. line of Lot 8, Block 5, McEwen's Sixth Add., Wichita, Sedgwick County, Kans.

* DEDICATED BY: Woodlawn High Rise, Inc.
 AGENT: Robert H. Nelson
 ADDRESS: 816 Union Center Bldg. PHONE _____
 PURPOSE OF DEDICATION: _____

As required by associated case L/S-0027

*ALL ABUTTER'S ACCESS RIGHTS EXCEPT FOR 1 OPENING: adjacent to the E. 265' of the S. line of Lot 8, Block 5, McEwen's Sixth Addition, Wichita, Sedgwick County, Kans.

ALL ABUTTER'S ACCESS RIGHTS EXCEPT FOR 1 OPENING: Adjacent to the W. line 136.98' of the E. 401.98' of the S. line of Lot 8, Block 5, McEwen's Sixth Addition, Wichita, Sedgwick County, Kansas.

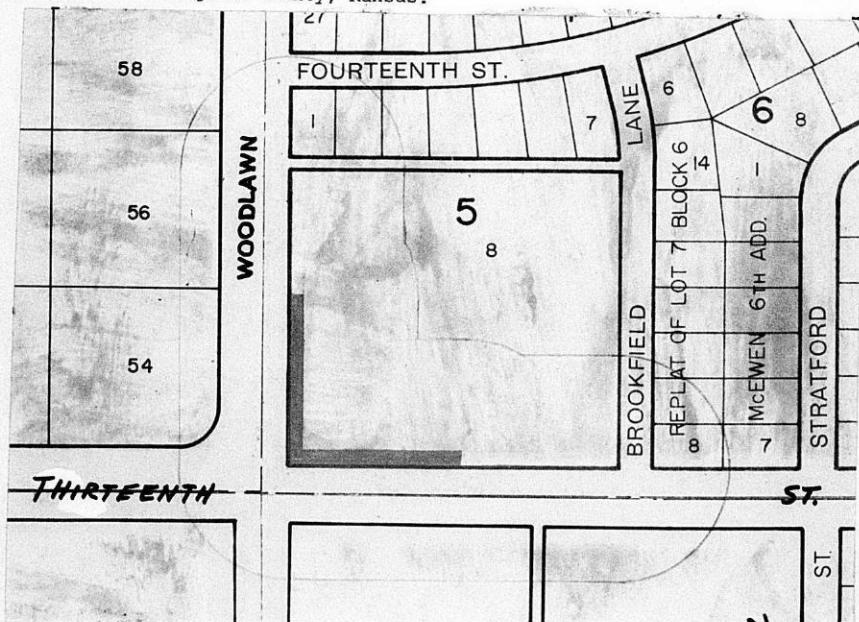

III. FILED 4-8-68
 POSTED TO ATLAS 4-11-68
 S/D COMM. ACTION 4-18-68 accept
 M.A.P.C. ACTION 4-25-68 accept
 B.C.C. ACTION 5-7-68 accept
 PLACED ON RECORD _____
 CITY CLERKS No. _____

MAPC CASE NO. D-0392 Dedication of Street right-of-way and abutter's
access rights

Dedicated by: Woodlawn High Rise, Inc.

Generally located at the northeast corner of Woodlawn and 13th Street

This dedication is given for the following reason:

As required by associated Case L/S-0027

ACTION: Accept the dedication and instruct the City Clerk to
file with the Register of Deeds.

T9-325

April 26, 1968

Mr. Robert H. Nelson
816 Union Center Building
Wichita, Kansas 67202

Subject: D-0392 - Dedication of street
right-of-way and abutter's access rights for
the northeast corner of 13th and Woodlawn.

Dear Mr. Nelson:

At its regular meeting on April 25, 1968, the Metropolitan Area Planning Commission considered the above-captioned offer of dedication. The action of the Planning Commission was to recommend that this dedication be accepted.

This matter will be forwarded to the Board of City Commissioners for its consideration at its regular meeting at 9:00 a.m., Tuesday, May 7, 1968, in Room 201, City Building, 204 South Main Street.

If you have any questions concerning this matter, please call.

Sincerely,

Jack H. Galbraith
Senior Planner

JHG:js

cc: Woodlawn High Rise, Inc.
c/o Robert H. Nelson
816 Union Center Bldg.
Wichita, Kansas 67202

DEDICATION
OF
ABUTTER'S ACCESS CONTROL

KNOW ALL MEN BY THESE PRESENTS:

That for and in consideration of the sum of One Dollar (\$1.00) and other good and valuable considerations, the receipt of which is hereby acknowledged, the undersigned WOODLAWN HIGH RISE, INC., being the owner of the hereinafter described real estate in Sedgwick County, Kansas, does hereby transfer and convey to the City of Wichita all abutter's rights of access, ingress and egress, from, to or upon, except for two openings adjacent to

the north 349.93 feet to the west line of Lot 8, Block 5, McEwen's Sixth Addition, Wichita, Sedgwick County, Kansas,

and except for one opening adjacent to

the east 265 feet of the south line of Lot 8, Block 5, McEwen's Sixth Addition, Wichita, Sedgwick County, Kansas,

and except for one opening adjacent to

the west line 136.98 feet of the east 401.98 feet of the south line of Lot 8, Block 5, McEwen's Sixth Addition, Wichita, Sedgwick County, Kansas

to have and to hold the same forever, it being understood that this conveyance is a covenant running with the land.

EXECUTED this 28th day of March, 1968.

WOODLAWN HIGH RISE, INC.

By Owen C. McEwen
President

ATTEST:

Lelia Jones
Assistant Secretary

STATE OF KANSAS)
) SS
SEDGWICK COUNTY)

BE IT REMEMBERED that on this 28th day of March, 1968, before me a Notary Public in and for the said County and State came Owen C. McEwen, President, and Lelia Jones, Assistant Secretary, of Woodlawn High Rise, Inc., to me personally known to be the same persons who executed the foregoing instrument and duly acknowledged the execution of the same.

IN WITNESS WHEREOF, I have hereunto subscribed my name and affixed my official seal, the day and year last above written.

Frank A. Palmer
Notary Public

My Commission Expires:

August 29, 1969

DEDICATION
OF
ABUTTER'S ACCESS RIGHTS

KNOW ALL MEN BY THESE PRESENTS:

That for and in consideration of the sum of One Dollar (\$1.00) and other good and valuable considerations, the receipt of which is hereby acknowledged, the undersigned WOODLAWN HIGH RISE, INC., being the owner of the following described real estate in Sedgwick County, Kansas, to-wit:

West 175 feet and south 175 feet of the south
and west lines of Lot 8 as platted, Block 5,
McEwen's Sixth Addition to City of Wichita,
Sedgwick County, Kansas,

do hereby transfer and convey to the City of Wichita, Kansas, all abutter's rights of access, ingress and egress to said property from, to or upon the above-described property, to have and to hold the same forever. It being understood that this conveyance is a covenant running with the land and prohibits all subsequent owners thereof and all members of the public from entering upon Woodlawn and Thirteenth Streets, respectively, from the property above described or from entering said property from Woodlawn and Thirteenth Streets, respectively.

Executed this 28th day of March, 1968.

WOODLAWN HIGH RISE, INC.

By Owen C. McEwen
president

ATTEST:

Lelia Jones
Asst. Secy

STATE OF KANSAS)
) SS
SEDGWICK COUNTY)

BE IT REMEMBERED that on this 28th day of March, 1968, before me, a Notary Public in and for the said County and State came Owen C. McEwen, President and Lelia Jones, Assistant Secretary, of Woodlawn High Rise, Inc., to me personally known to be the same persons who executed the foregoing instrument and duly acknowledged the execution of the same.

IN WITNESS WHEREOF, I have hereunto subscribed my name and affixed my official seal, the day and year last above written.

Ernest B. Redden
Notary Public

My Commission Expires:

August 28, 1969

DEDICATION

KNOW ALL MEN BY THESE PRESENTS:

That for and in consideration of the sum of One Dollar (\$1.00) and other good and valuable considerations, the receipt of which is hereby acknowledged, the undersigned, WOODLAWN HIGH RISE, INC.

being the owner of the following described real estate in Sedgwick County, Kansas, to wit:

South 25 feet of the west 300 and west 25 feet of the north 275 feet of Lot 8, Block 5, McEwen's Sixth Addition to the City of Wichita, Sedgwick County, Kansas.

*(OF THE SOUTH 300 FEET)

do hereby dedicate the above described real estate to the public for street-right-of-way purposes.

Executed this 28th day of March, 1968.

ATTEST:

WOODLAWN HIGH RISE, INC.

By: Lelia Jones
Asst. Secy.

By: Owen C. McEwen
President

STATE OF KANSAS)
SEDGWICK COUNTY)^{ss}

BE IT REMEMBERED, that on this 28th day of March, 1968,
came Owen C. McEwen, President and Lelia Jones, Assistant Secretary
of Woodlawn High Rise, Inc.,

to me personally known to be the same person who executed the foregoing instrument and duly acknowledged the execution of the same.

IN WITNESS WHEREOF, I have hereunto subscribed my name and affixed my official seal, the day and year last above written.

Submitted to the Wichita-Sedgwick County Metropolitan Area Planning Commission and the Board of Commissioners of the City of Wichita, Kansas, and approved by said Board of Commissioners of the City of Wichita, Kansas,

this _____,

City Clerk

[Signature]
Notary Public

My Commission Expires: 9/28/69