

B.C.C. ~~11-0000~~ Accepted 2-23-68

Closed 7-23-68

D-0395 - PRAIRIE VILLAGE HOMES, INC.
Dedication of street right-of-way
at NW corner of 21st & Woodlawn.

ACTION

Posted
5-7-68

	DATE
SID COMMITTEE <u>Approved</u>	<u>5-16-68</u>
M.A.P.C. <u>accept</u>	<u>5-23-68</u>
B.C.C. COE <u>accepted</u>	<u>7-23-68</u>

Closed 7-23-68

D-0395 - PRAIRIE VILLAGE HOMES, INC.
Dedication of street right-of-way
at NW corner of 21st & Woodlawn.

DEDICATION REPORT AND PROGRESS
CASE No. D - 0395

MAP No. 5850
SEC. No. 1
TWP. No. 27S
RANGE 1E

I. OFFER TO DEDICATE: Street Right-of-way
GENERALLY LOCATED: At the Northwest corner of Woodlawn and 21st St.

LEGALLY DESCRIBED AS:

The north twenty feet of the south fifty feet of the southwest quarter of the Southeast Quarter of Section 1, Township 27, South, Range 1, East of the 6th P.M.

DEDICATED BY: Prairie Village Homes, Inc.
AGENT: Robert J. Lawrence, President
ADDRESS: 6701 E. 13th St. 67206 PHONE MU 66668
PURPOSE OF DEDICATION:

II. SKETCH.

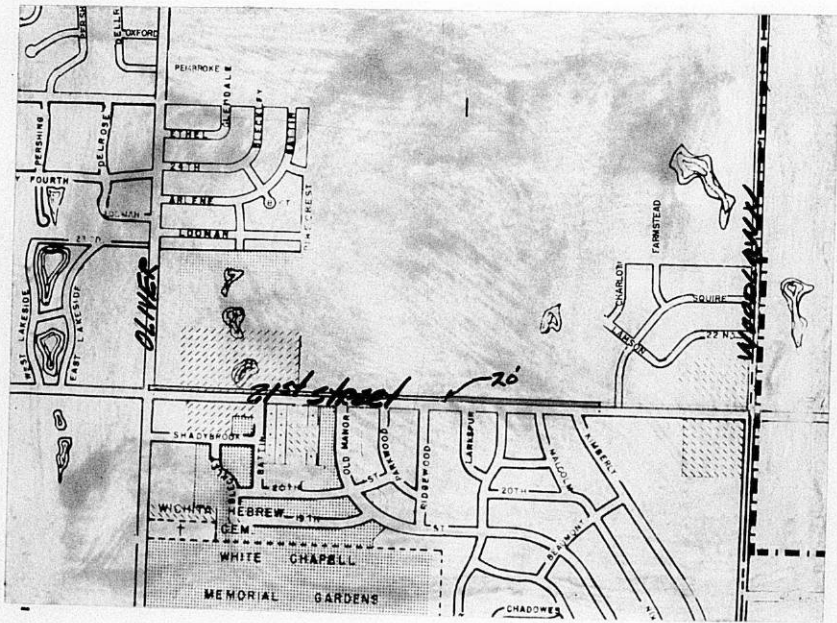

III. FILED 5-7-68

POSTED TO ATLAS

S/D COMM. ACTION

M.A.P.C. ACTION

5-7-68

5-16-68

5-23-68

B.C.C. ACTION 7-23-68 accepted

PLACED ON RECORD

CITY CLERKS No.

MAPC CASE NO. D-0395 Dedication of street right-of-way

Dedicated by: **Prairie Village Homes, Inc.**

Generally Being For: A portion of the north side of 21st Street

This dedication is given for the following reason:

Associated with plat of Prairie Village subdivision

ACTION: Accept the dedication and instruct the City Clerk to
file with the Register of Deeds.

T9-325

May 23, 1968

Prairie Village Homes, Inc.
Robert J. Lawrence, President
6701 East 13th Street
Wichita, Kansas 67206

Subject: D-0395 - Dedication of street right-of-way at the northwest corner of Woodlawn and 21st Street.

Dear Mr. Lawrence:

At its regular meeting on May 23, 1968, the Metropolitan Area Planning Commission considered the above-captioned offer of dedication. The action of the Planning Commission was to recommend that this dedication be accepted.

This matter will be forwarded to the Board of City Commissioners for its consideration together with the plat of Prairie Village Addition at such time as all conditions of approval for the final plat have been met.

If you have any questions concerning this matter, please call.

Sincerely,

Jack H. Galbraith
Senior Planner

JHG:js

DECLARATION

KNOW ALL MEN BY THESE PRESENTS:

That for and in consideration of the sum of One Dollar (\$1.00) and other good and valuable considerations, the receipt of which is hereby acknowledged, the undersigned, Prairie Village Homes, Inc.

being the owner of the following described real estate located in the County of Sedgewick, Kansas, to wit:

Lot 20, Block 10, of the Prairie Village Homes, Inc. Subdivision, located in the County of Sedgewick, Kansas, and being more particularly described as follows:

MICROFILMED
FROM THE BEST
AVAILABLE COPY

do hereby dedicate the above described real estate to the public for street purposes.

Executed this 5th day of April, 1968.



PRAIRIE VILLAGE HOMES, INC.

By Robert J. Lawrence, President

Mary E. Kane, Asst. Sec.-Treas.

STATE OF KANSAS)
SEDGWICK COUNTY) SS

BE IT REMEMBERED, that on this 5th day of April, 1968, before me a Notary Public in and for the said County and State came

Robert J. Lawrence, President and Mary E. Kane, Asst. Sec.-Treas. of

Prairie Village Homes, Inc.

to me personally known to be the same persons who executed the foregoing instrument and duly acknowledged the execution of the same.

IN WITNESS WHEREOF, I have hereunto subscribed my name and affixed my seal, the day and year last above written.



My Commission expires July 22, 1969.

Leslie D. Hostetler
Notary Public
Leslie D. Hostetler