

D-0469 - Sherwood Construction  
Dedicates street row for May  
Avenue between K-42 Highway and  
Sheridan

POSTED  
5-12-71  
CF

ACTION

	DATE
S/D COMMITTEE	5-20-71
M.A.P.C.	5-27-71
B.C.C. <del>RECEIVED</del>	6-8-71

DEDICATION REPORT AND PROGRESS

MAP No. 5245  
 SEC. No. 36  
 TWP. No. 27 S  
 RANGE 1 W

CASE No. D - 0469

I. OFFER TO DEDICATE: Street right-of-way  
 GENERALLY LOCATED: May Avenue between K-42 Highway and Sheridan

LEGALLY DESCRIBED AS:

The north 40 feet of all that portion of the SW 1/4 of Section 36, Township 27 S, Range 1 W, lying east of the right-of-way of Missouri Pacific Railroad and north of the right-of-way of Kansas City, Mexico and Orient, now Atchison, Topeka and Santa Fe Railroad.

DEDICATED BY: Sherwood Construction Company, Inc.  
 AGENT: Howard Sherwood, Vice-President  
 ADDRESS: \_\_\_\_\_ PHONE \_\_\_\_\_  
 PURPOSE OF DEDICATION:

*To allow improvement and paving  
 of May Avenue.*

II. SKETCH.

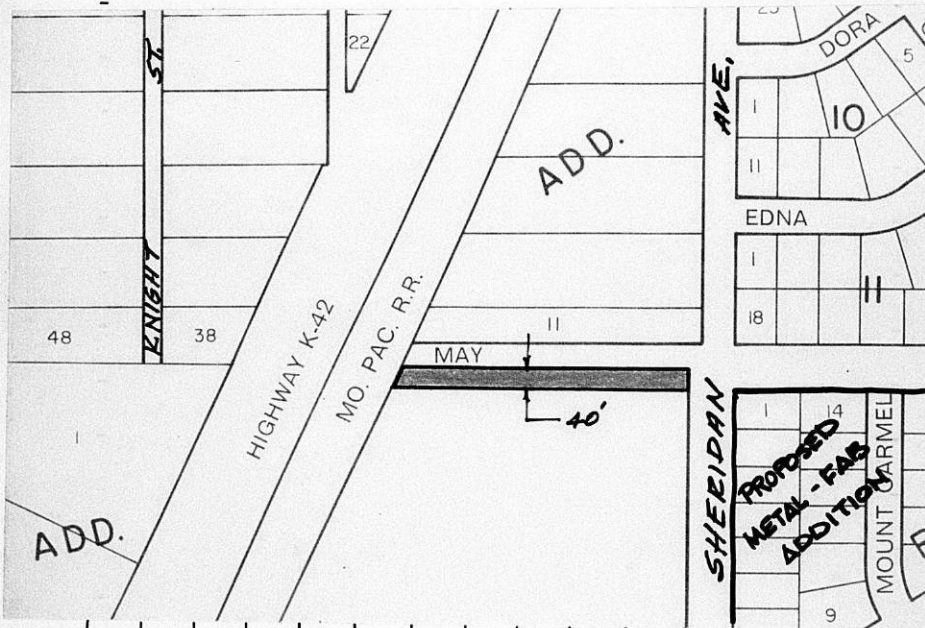

III. FILED 5-10-71  
 POSTED TO ATLAS 5-12-71  
 S/D COMM. ACTION 5-20-71 *Accept*  
 M.A.P.C. ACTION 5-27-71 *Accept*

B.C.C. ACTION 6-8-71 *Accept*  
 PLACED ON RECORD \_\_\_\_\_  
 CITY CLERKS No. \_\_\_\_\_

MAPC CASE NO. D-0469    Dedication of    Street right-of-way

Dedicated by:    Sherwood Construction Company, Inc.

Generally    May Avenue between K-42 Highway and Sheridan

This dedication is given for the following reason:

To allow improvement and paving of May Avenue.

**ACTION:**    Accept the dedication and instruct the City Clerk to  
file with the Register of Deeds.

DEDICATION

KNOW ALL MEN BY THESE PRESENTS:

That for and in consideration of the sum of One Dollar (\$1.00) and other good and valuable considerations, the receipt of which is hereby acknowledged, the undersigned, Sherwood Construction Company, Inc., Successor by Merger to Basset Const., Inc.

being the owner of the following described real estate in Sedgwick County, Kansas, to wit:

The north forty (40) feet of all that portion of the Southwest Quarter of Section 36, Township 27, South, Range 1, West, lying east of the right-of-way of Missouri Pacific Railroad and north of the right-of-way of Kansas City, Mexico and Orient, now Atkinson, Topeka, and Santa Fe Railroad;

Submitted to the Wichita - Sedgwick County Metropolitan Area Planning Commission and the Board of Commissioners of the City of Wichita, Kansas, and approved by said Board of Commissioners of the City of Wichita, Kansas,

this \_\_\_\_\_, 19 \_\_\_\_\_

\_\_\_\_\_  
City Clerk

do SS hereby dedicate the above described real estate to the public for street purposes.

Executed this 5th day of May, 19 71.

ATTEST:

Daniel L. McBeth  
Secretary

(SEAL)

Sherwood Construction Company, Inc., Successor by Merger to Basset Const., Inc.

By Howard Sherwood  
Howard Sherwood - V - Pres.

STATE OF KANSAS)  
SEDGWICK COUNTY) SS

BE IT REMEMBERED, that on this 5th day of May, 19 71, before me a Notary Public in and for the said County and State came

Howard Sherwood, Vice President, of Sherwood Construction Company, Inc., Successor by Merger to Basset Const., Inc., as Vice President of said corporation, and for and on behalf of said corporation,

personally known to be the same person who executed the foregoing and duly acknowledged the execution of the same, as the act and said corporation.

WITNESS WHEREOF, I have hereunto subscribed my name and affixed my seal, the day and year last above written.



Pamela S. Whitehead  
Notary Public

My Commission expires June 11, 1974.