

D-0484 - Kansas Developers, Inc.
Dedicates Street ROW and Easement
At Elpyco and drainage easement
north of Lincoln Street

Posted
11-8-71

ACTION

DATE

S/D COMMITTEE *no hearing necessary*
M.A.P.C. *no hearing necessary*
B.C.C. / *accept* 10-26-71

DEDICATION REPORT AND PROGRESS

MAP No. 5846
 SEC. No. 25
 TWP. No. 27 S
 RANGE 1 E

CASE No. D - 0484

I. OFFER TO DEDICATE: Street and easement
 GENERALLY LOCATED: At Elpyco and the drainage easement north of Lincoln Street

LEGALLY DESCRIBED AS:

Street ROW - A tract of land in Lot 2, Prestridge Add'n. to Wichita, Ks. described as follows: Beg. 30 ft. E of the NW corner of Lightner 2nd Add'n. thence NEly along the W'ly line of said Lot 2 a distance of 18 ft.; thence SE'ly to the NW corner of Lot 31 of Lightner 2nd Add'n.; thence W to beg. Easement - The W'ly 20 feet of Lot 2, Prestridge Add'n. to Wichita, Ks.

DEDICATED BY: Kansas Developers, Inc.
 AGENT: Kenneth F. Beck
 ADDRESS: 1418 Vickers-KSB&T Building PHONE 262-8431
 PURPOSE OF DEDICATION:
 Condition of approval of Case No. Z-1214

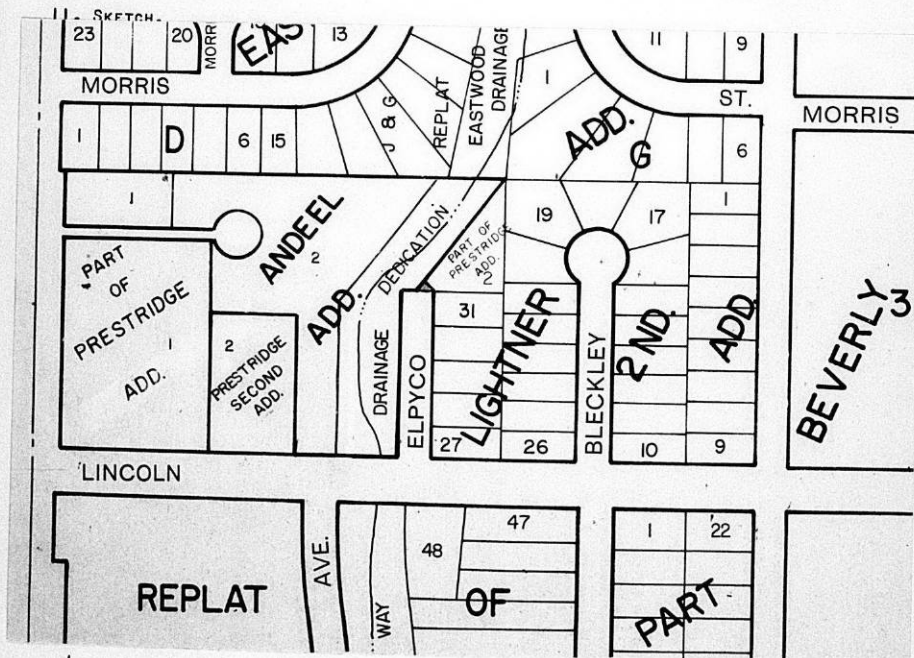

III. FILED 10-9-71 B.C.C. ACTION 10-26-71 approve
 POSTED TO ATLAS 11-8-71 PLACED ON RECORD
 S/D COMM. ACTION no hearing necessary CITY CLERKS No. _____
 M.A.P.C. ACTION no hearing necessary

DEDICATION

KNOW ALL MEN BY THESE PRESENTS:

That for and in consideration of the sum of One Dollar (\$1.00) and other good and valuable considerations, the receipt of which is hereby acknowledged, the undersigned, KANSAS DEVELOPERS, INC. and

HARRY POLLAK

being the owners of the following described real estate in Sedgwick County, Kansas, to wit:

A tract of land in Lot 2, Prestridge Addition to Wichita, Kansas, described as follows: Beginning 30 feet east of the NW corner of Lightner Second Addition; thence northeasterly along the westerly line of said Lot 2 a distance of 18'; thence southeasterly to the NW corner of Lot 31 of Lightner Second Addition; thence west to beginning.

do hereby dedicate the above described real estate to the public for street purposes.

Executed this 8th day of October 19 71.

KANSAS DEVELOPERS, INC.

By *Lindy Andeel*
President

STATE OF KANSAS)
SEDGWICK COUNTY)^{ss}

BE IT REMEMBERED, that on this 8th day of October, 1971,

came Lindy Andeel and Harry Pollak

 to me personally known to be the same persons who executed the foregoing instrument and duly acknowledged the execution of the same.

 PUBLIC WITNESS WHEREOF, I have hereunto subscribed my name and affixed my official seal, the day and year last above written.

Submitted to the Wichita-Sedgwick County Metropolitan Area Planning Commission and the Board of Commissioners of the City of Wichita, Kansas, and approved by said Board of Commissioners of the City of Wichita, Kansas,

this

City Clerk

Mary J. Pichartz
Notary Public

My Commission Expires Feb. 5, 1972

EASEMENT

THIS EASEMENT made this 8th day of October,
19 71, by and between KANSAS DEVELOPERS, INC. and
HARRY POLLAK

of the first part and the City of Wichita of the second part.

WITNESSETH: That the said first party, in consideration
of the sum of One Dollar (\$1.00) and other valuable consideration,
the receipt whereof is hereby acknowledged, does hereby grant and
convey unto the said second party a perpetual right-of-way and
easement for the purpose of constructing and maintaining Dry Creek
along the following described real estate situated in Sedgwick
County, Kansas, towit:

The westerly 20 feet of Lot 2, Prestridge
Addition to Wichita, Kansas.

And said second party is hereby granted the right to
enter upon said premises at any time for the purpose of construct-
ing, operating, maintaining and repairing Dry Creek.

IN WITNESS WHEREOF, the said first party has signed
these presents the day and year first written.

KANSAS DEVELOPERS, INC.

By [Signature]
President

x

STATE OF KANSAS)
) SS
SEDGWICK COUNTY)

Personally appeared before me a Notary Public in and for
the County and State aforesaid Lindy Andeel and Harry Pollak

to me personally known to be the same persons who executed the
foregoing instrument of writing and said persons duly acknowledged
the execution thereof.

DATED at Wichita, Kansas, this 8th day of October,

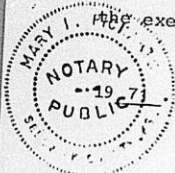

[Signature]
Notary Public

My Commission Expires My Commission Expires Feb. 5, 1972