

D-0486 - Elmer E. Mehl Dedicates
Alley on E side of Hillside in
area between Kellogg and Orme

POSTED

11-1-71

[Signature]

ACTION

S/O COMMITTEE no hearing necessary

M.A.P.C. no hearing necessary

B.C.C. ~~11-2-71~~ 11-2-71

~~accept~~ * 11-16-71

Alley dedication not
required by the Bd of CC 11/16/71
[Signature]

POSTED
11-1-71
[Signature]

D-0486 - Elmer E. Mehl Dedicates
Alley on E side of Hillside in
Area between Kellogg and Orme

ACTION

S/O COMMITTEE no hearing necessary

M.A.P.C. no hearing necessary

B.C.C. ~~_____~~ ^{Defers 2 weeks} 11-2-71
accept * 11-16-71

Alley dedication not
required by the Bd of CC 11/16/71
[Signature]

- *- alley dedication not required
- required 10' outright dedication for Hillside Assoc. w/ zone case Z-1332
- required additional 10' for Hillside on a contingent dedication

MAP No. 5746
 SEC. No. 26
 TWP. No. 27 S
 RANGE 1 E

DEDICATION REPORT AND PROGRESS
 CASE No. D - 0486

I. OFFER TO DEDICATE: Street
 GENERALLY LOCATED: Alley right-of-way
On the east side of Hillside in an area between
Kellogg and Orme

LEGALLY DESCRIBED AS:

The E 2 1/2 feet of Lots 14 and 16, on Hillside Avenue, in Underwood's Addition, a subdivision of Block 5, Vincennes Addition to the City of Wichita, Sedgwick County, Kansas (see application)

OUTRIGHT DEDICATION: W. 10' of Lots 14 & 16
 CONTINGENT " : E. 10' of the W. 20' of Lots 14 & 16

DEDICATED BY: Elmer E. Mehl
 AGENT: Robert M. Moore
 ADDRESS: 1959 South Oliver 67218 PHONE 684-0297

PURPOSE OF DEDICATION:
 Condition of approval of Case No. Z-1332)

II. SKETCH.

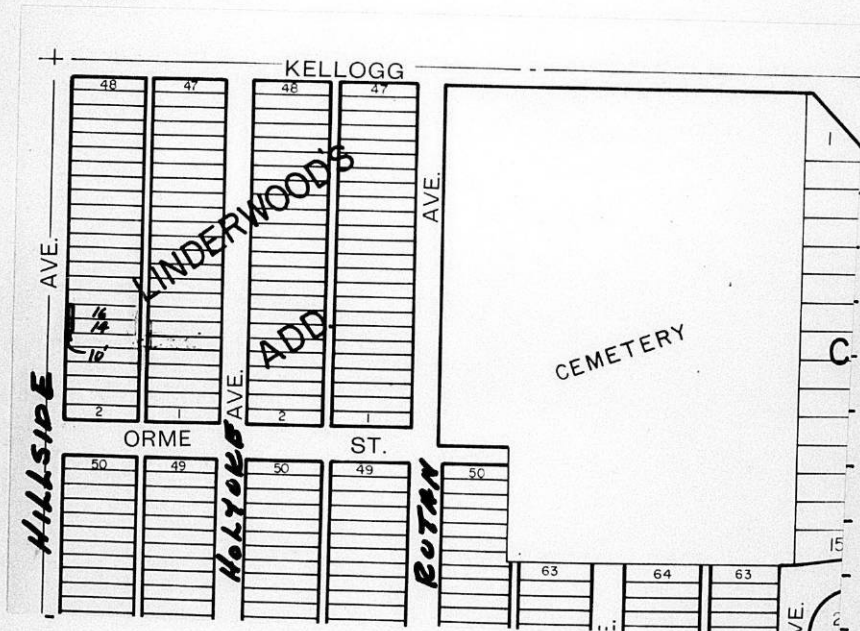

III. FILED Nov 1, 1971 B.C.C. ACTION 11-2-71 Refer 2 who
 POSTED TO ATLAS 11-1-71 11-16-71 Accept *
 S/D COMM. ACTION no hearing necessary PLACED ON RECORD
 M.A.P.C. ACTION no hearing necessary CITY CLERKS No. _____

* accepted in consideration of Assoc. zone case Z-1332
 - Required 10' outright dedication for Hillside
 - " additional 10' for Hillside as a contingent dedication
 Z-1332 did not require additional R/W for alley

Bole Moor - 120
Admission of
D/W on on
Hillside

Outright dedication

1
+
2
X

The W. 10' of Lots 14 & 16, on Hillside
Ave., in Underwood's Add'n., a
Subdivision of Blk. 5, Vincennes
Add'n., to the City of Wichita,
Sedgewick County, Ks.

Cont. Ded.

The E. 10' of the W. 20' of
Lots 14 & 16, on Hillside Ave.,

CONTINGENT DEDICATION

WHEREAS, Elmer Edgar Mehl and Elizabeth May Mehl, husband and wife, are the owners of real property described as follows:

Lots 14 and 16, on Hillside Avenue, in UNDERWOOD ADDITION, A SUBDIVISION of Block 5, in VINCENNES ADDITION to Wichita, Sedgwick County, Kansas; and

WHEREAS, said owners are desirous of making a contingent dedication to the public for street right of way covering the following described property, to-wit:

The East 10 feet of the West 20 feet of Lots 14 and 16, on Hillside Avenue, in UNDERWOOD ADDITION, A SUBDIVISION of Block 5, in VINCENNES ADDITION to Wichita, Sedgwick County, Kansas;

and

WHEREAS, at the present time, a portion of existing buildings is presently located on said property herein being dedicated; and

WHEREAS, it is the intention of the owners to dedicate to the public the above described property, but effective only in the event of certain contingencies hereinafter specified.

NOW, THEREFORE, Elmer Edgar Mehl and Elizabeth May Mehl, husband and wife, being the legal owners of the above described property, do hereby dedicate to the public for street purposes the property hereinabove set forth; but the right of the public and the City of Wichita and the Board of County Commissioners of Sedgwick County, Kansas, to make use thereof for public purposes, including streets, excavation, fill, street paving, sidewalks, public utilities and other similar street purposes, shall not occur so long as the presently existing portion of a building located on said above described property being dedicated shall remain thereon. It is understood that this dedication shall come into being in the event of substantial or total destruction of an existing building by fire or other casualty or in the event an existing building is substantially torn down or destroyed, and upon the happening of such an event this dedication shall be and become, without further notice or act, in full force and effect.

It is the intent of the grantors and owners that this contingent dedication shall be a covenant running with the land and shall be binding upon their heirs and assigns and all subsequent owners of any part or parcel of said property covered by said dedication.

DONE this 24th day of October, 1971.

Elmer Edgar Mehl
Elmer Edgar Mehl

Elizabeth May Mehl
Elizabeth May Mehl

A C K N O W L E D G M E N T

STATE OF KANSAS }
SEDGWICK COUNTY } ss.

BE IT REMEMBERED, that on this 24th day of October, 1971, before me, a Notary Public in and for said County and State, came Elmer Edgar Mehl and Elizabeth May Mehl

to me personally known to be the same persons who executed the foregoing instrument and duly acknowledged the execution of the same.

IN WITNESS WHEREOF, I have hereunto set my hand and affixed my seal the day and year last above written.

Robert M. Moore
Notary Public

My Commission Expires: My Commission Expires February 7, 1976



DEDICATION

KNOW ALL MEN BY THESE PRESENTS:

That for and in consideration of the sum of One Dollar (\$1.00) and other good and valuable considerations, the receipt of which is hereby acknowledged, the undersigned, Elmer Edgar Mehl and Elizabeth May Mehl,
husband and wife

being the owner of the following described real estate in Sedgwick County, Kansas, to wit:

The west 10 feet of Lots 14 and 16, on Hillside Avenue, in Underwood's Addition, a Subdivision of Block 5, Vincennes Addition, to the City of Wichita, Sedgwick County, Kansas.

do hereby dedicate the above described real estate to the public for public purposes.

Executed this 19th day of November 19 71.

X Elmer Edgar Mehl
Elmer Edgar Mehl

X Elizabeth May Mehl
Elizabeth May Mehl

STATE OF KANSAS)
SEDGWICK COUNTY) ss

BE IT REMEMBERED, that on this 19th day of November, 1971,
came Elmer Edgar Mehl and Elizabeth May Mehl,

to me personally known to be the same persons who executed the foregoing instrument and duly acknowledged the execution of the same.

IN WITNESS WHEREOF, I have hereunto subscribed my name and affixed my official seal, the day and year last above written.

Submitted to the Wichita-Sedgwick County Metropolitan Area Planning Commission and the Board of Commissioners of the City of Wichita, Kansas, and approved by said Board of Commissioners of the City of Wichita, Kansas,

this _____

City Clerk

Robt. M. Moore
Notary Public

My Commission Expires: Feb. 7, 1975.



DEDICATION

KNOW ALL MEN BY THESE PRESENTS:

That for and in consideration of the sum of One Dollar (\$1.00) and other good and valuable considerations, the receipt of which is hereby acknowledged, the undersigned, Elmer Edgar Mehl and Elizabeth May Mehl,
husband and wife,

being the owner^s of the following described real estate in Sedgwick County, Kansas, to wit:

The east two and one-half (2 1/2) feet of Lots 14 and 16, on Hillside Avenue, in Underwood's Addition, a subdivision of Block 5, Vincennes Addition to the City of Wichita, Sedgwick County, Kansas

do hereby dedicate the above described real estate to the public for purposes.

Executed this 24th day of October 19 71.

Elmer Edgar Mehl
Elmer Edgar Mehl

Elizabeth May Mehl
Elizabeth May Mehl

STATE OF KANSAS)
SEDGWICK COUNTY) ss

BE IT REMEMBERED, that on this 24th day of October, 1971

Elmer Edgar Mehl and Elizabeth May Mehl

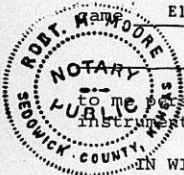

I am personally known to be the same person^s who executed the foregoing instrument and duly acknowledged the execution of the same.

IN WITNESS WHEREOF, I have hereunto subscribed my name and affixed my official seal, the day and year last above written.

Submitted to the Wichita-Sedgwick County Metropolitan Area Planning Commission and the Board of Commissioners of the City of Wichita, Kansas, and approved by said Board of Commissioners of the City of Wichita, Kansas,

this _____

City Clerk

Robert M. Mehl
Notary Public

My Commission Expires February 7, 1975
My Commission Expires: _____

CONTINGENT DEDICATION

WHEREAS, Elmer Edgar Mehl and Elizabeth May Mehl, husband and wife, are the owners of real property described as follows:

Lots 14 and 16, on Hillside Avenue, in UNDERWOOD ADDITION, A SUBDIVISION of Block 5, in VINCENNES ADDITION to Wichita, Sedgwick County, Kansas; and

WHEREAS, said owners are desirous of making a contingent dedication to the public for street right of way covering the following described property, to-wit:

The last 10 feet of the

~~The~~ West 20 feet of Lots 14 and 16, on Hillside Avenue, in UNDERWOOD ADDITION, A SUBDIVISION of Block 5, in VINCENNES ADDITION to Wichita, Sedgwick County, Kansas;

and

WHEREAS, at the present time, a portion of existing buildings is presently located on said property herein being dedicated; and

WHEREAS, it is the intention of the owners to dedicate to the public the above described property, but effective only in the event of certain contingencies hereinafter specified.

NOW, THEREFORE, Elmer Edgar Mehl and Elizabeth May Mehl, husband and wife, being the legal owners of the above described property, do hereby dedicate to the public for street purposes the property hereinabove set forth; but the right of the public and the City of Wichita and the Board of County Commissioners of Sedgwick County, Kansas, to make use thereof for public purposes, including streets, excavation, fill, street paving, sidewalks, public utilities and other similar street purposes, shall not occur so long as the presently existing portion of a building located on said above described property being dedicated shall remain thereon. It is understood that this dedication shall come into being in the event of substantial or total destruction of an existing building by fire or other casualty or in the event an existing building is substantially torn down or destroyed, and upon the happening of such an event this dedication shall be and become, without further notice or act, in full force and effect.

It is the intent of the grantors and owners that this contingent dedication shall be a covenant running with the land and shall be binding upon their heirs and assigns and all subsequent owners of any part or parcel of said property covered by said dedication.

DONE this 24th day of October, 1971.

Elmer Edgar Mehl
Elmer Edgar Mehl

Elizabeth May Mehl
Elizabeth May Mehl

A C K N O W L E D G M E N T

STATE OF KANSAS }
SEDGWICK COUNTY } ss.

BE IT REMEMBERED, that on this 24th day of October, 1971, before me, a Notary Public in and for said County and State, came Elmer Edgar Mehl and Elizabeth May Mehl

to me personally known to be the same persons who executed the foregoing instrument and duly acknowledged the execution of the same.

IN WITNESS WHEREOF, I have hereunto set my hand and affixed my seal the day and year last above written.

Robt. M. Moore
Notary Public

My Commission Expires: My Commission Expires February 7, 1974

