

D-0488 - Howard I. White Dedicates  
Access Control & Street ROW at  
NW corner of Hillside and Pawnee

ACTION

no hearing necessary

no hearing necessary

no hearing necessary

NOTE

see file V-0571 where  
BCC on 12-7-91 considered  
vacation and substitute  
dedications together.

MAP No. 5645  
 Sec. No. 34  
 TWP. No. 27 S  
 RANGE 1 E

DEDICATION REPORT AND PROGRESS

CASE No. D - 0488

I. OFFER TO DEDICATE: Access control and Street ROW  
 GENERALLY LOCATED: At the northwest corner of Hillside and Pawnee

LEGALLY DESCRIBED AS:

Access Control - Lot 2, Block G, Maplewood Add., Sedg. Co., Ks.  
Street ROW - The E 10 feet of Lot 2 and the S 10 feet of Lots 1 and 2, all in Block G, Maplewood Add., Sedg. Co., Ks.

DEDICATED BY: Howard I. White, Jr.  
 AGENT: Bruce B. Fitts  
 ADDRESS: 622 North Broadway 67203 PHONE 265-6624  
 PURPOSE OF DEDICATION:

*Requirements of associated case V-0571*

II. SKETCH.

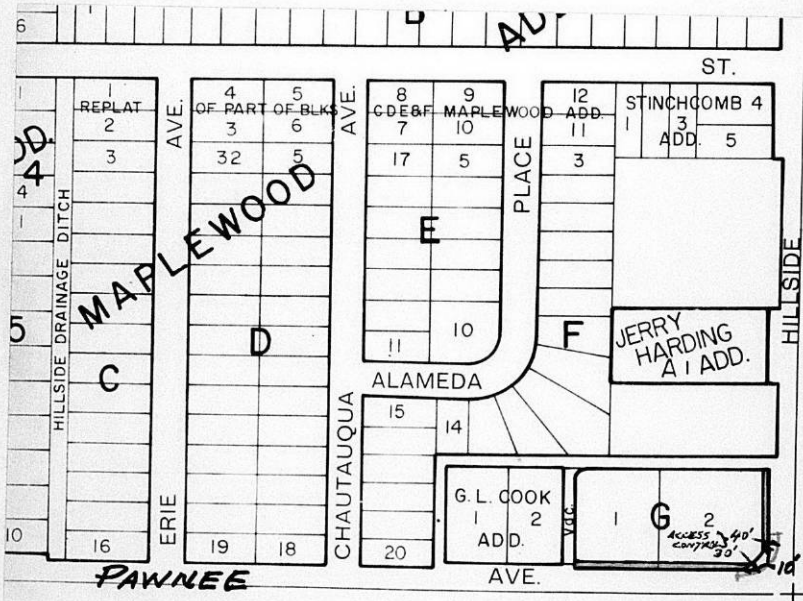

III. FILED 12-1-71 B.C.C. ACTION No hearing necessary  
 POSTED TO ATLAS 12-2-71 \*  
 S/D COMM. ACTION no hearing necessary PLACED ON RECORD  
 M.A.P.C. ACTION no hearing necessary CITY CLERKS No. \_\_\_\_\_

\* NOTE see file V-0571 where BCC on 12-1-71 considered the vacation and substitute dedications together.

DEDICATION OF ABUTTER'S ACCESS RIGHTS

KNOW ALL MEN BY THESE PRESENTS:

That for and in consideration of the sum of One Dollar (\$1.00) and other good and valuable considerations, the receipt of which is hereby acknowledged, the undersigned, Howard I. White, Jr., a single person, being the owner of the following described real estate in Sedgwick County, Kansas, to-wit:

Lot Two (2), Block G, Maplewood Addition,  
Sedgwick County, Kansas,

does hereby transfer and convey to the City of Wichita, Kansas, all abutter's rights of access, ingress and egress to said property from, to, or upon The East Thirty (30) Feet and the South Forty (40) Feet of the South and East lines of said lot, respectively, to have and to hold the same forever. It being understood that this conveyance is a covenant running with the land and prohibits all subsequent owners thereof and all members of the public from entering upon The East Thirty (30) feet and the South Forty (40) Feet of the South and East lines of said lot, respectively, from the property above described or from entering said property from The East Thirty (30) Feet and the South Forty (40) Feet of the South and East lines of said lot, respectively.

Executed this 29th day of November, 1971.

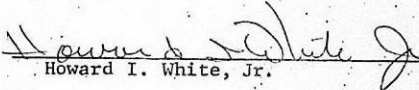
  
Howard I. White, Jr.

STATE OF KANSAS, SEDGWICK COUNTY, ss:.

BE IT REMEMBERED, that on this 29th day of November, 1971, before me a Notary Public in and for the said County and State came Howard I. White, Jr., a single person, to me personally known to be the same person who executed the foregoing instrument and duly acknowledged the execution of the same.

IN WITNESS WHEREOF, I have hereunto subscribed my name and affixed my official seal, the day and year last above written.

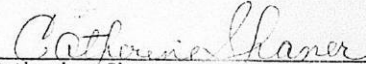

  
Catherine Shaner - Notary Public

My Commission expires:

December 31, 1972

DEDICATION

KNOW ALL MEN BY THESE PRESENTS:

That for and in consideration of the sum of One Dollar (\$1.00) and other good and valuable considerations, the receipt of which is hereby acknowledged, the undersigned, Howard I. White, Jr., a single person

being the owner of the following described real estate in Sedgwick County, Kansas, to wit:

The East Ten (10) Feet of Lot Two (2) and the South Ten (10) Feet of Lots One (1) and Two (2), All in Block G, Maplewood Addition, Sedgwick County, Kansas

do es hereby dedicate the above described real estate to the public for Street purposes.

Executed this 29th day of November 19 71.

Howard I. White, Jr.  
Howard I. White, Jr.

STATE OF KANSAS )  
SEDGWICK COUNTY ) ss

BE IT REMEMBERED, that on this 29th day of November, 1971, came Howard I. White, Jr., a single person

to me personally known to be the same person who executed the foregoing instrument and duly acknowledged the execution of the same.

IN WITNESS WHEREOF, I have hereunto subscribed my name and affixed my official seal, the day and year last above written.

Submitted to the Wichita-Sedgwick County Metropolitan Area Planning Commission and the Board of Commissioners of the City of Wichita, Kansas, and approved by said Board of Commissioners of the City of Wichita, Kansas,  
this \_\_\_\_\_  
City Clerk

Catherine Shanahan  
Catherine Shanahan, Notary Public  
WICHITA, KANSAS

My Commission Expires: \_\_\_\_\_  
Dec. 31, 1972