

ACTION

	DATE
S/D COMMITTEE	<u>11-16-72</u>
M.A.P.C.	<u>11-27-72</u>
B.C.C./ B.C.C.	<u>12-5-72</u>

D-0521 Clyde & Ruth Dawson dedicate street on the West side of Garnett in an area North of Douglas Avenue

DEDICATION REPORT AND PROGRESS

MAP No. 6247
SEC. No. 22
TWP. No. 27S
RANGE 2E

CASE No. D - 0521

I. OFFER TO DEDICATE: street
GENERALLY LOCATED: On the West side of Garnett in an area North of Douglas

LEGALLY DESCRIBED AS:

The East 15 feet of the South 100 feet of Lot 31, Gilders Gardens Addition, in Sedgwick County, Kansas.

DEDICATED BY: Clyde W. and Ruth N. Dawson

AGENT: _____

ADDRESS: _____

PURPOSE OF DEDICATION: _____

PHONE _____

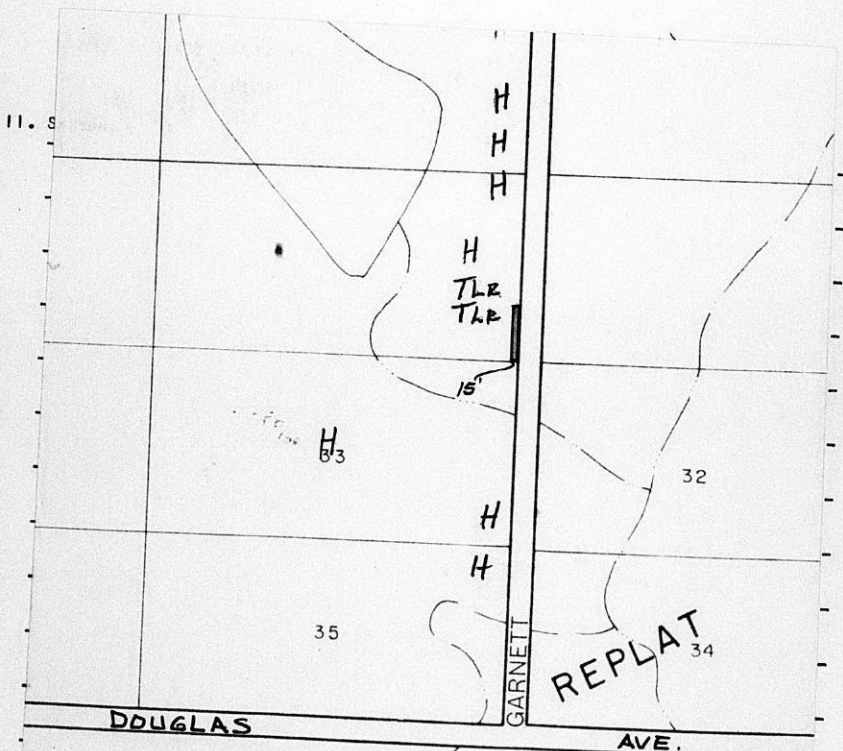

III. FILED 9/25/72

POSTED TO ATLAS 11-9-72

S/D COMM. ACTION 11/16/72 approve

M.A.P.C. ACTION 11-27-72 approve

B.C.C. ACTION 12-5-72 Approved

PLACED ON RECORD _____

CITY CLERKS No. _____

MAPC CASE NO. D-0521 Dedication of street

Dedicated by: Clyde W. Dawson and Ruth N. Dawson, his wife

Generally being for a portion of the west side of Garnett
 in an area north of Douglas

This dedication is given for the following reason:

 Requirement of lot split approval.

ACTION: Accept the dedication and instruct the City Clerk to
 file with the Register of Deeds.

T9-325

DEDICATION

KNOW ALL MEN BY THESE PRESENTS:

That for and in consideration of the sum of One Dollar (\$1.00) and other good and valuable considerations, the receipt of which is hereby acknowledged, the undersigned, Clyde W. Dawson and Ruth N. Dawson, his wife

being the owners of the following described real estate in Sedgwick County, Kansas, to wit:

The east 15 feet of the south 100 feet of Lot 31, Gilders Gardens Addition, in Sedgwick County, Kansas.

All being in the NE $\frac{1}{4}$, Section 22, Township 27 South, Range 2 East.

do es hereby dedicate the above described real estate to the public for Street purposes.

Executed this 25th day of September 19 72.

Clyde W. Dawson
Ruth N. Dawson

STATE OF KANSAS)
SEDGWICK COUNTY)^{ss}

BE IT REMEMBERED, that on this 25th day of September, 1972,
came Clyde W. Dawson and Ruth N. Dawson, husband and wife,

to me personally known to be the same persons who executed the foregoing instrument and duly acknowledged the execution of the same.

IN WITNESS WHEREOF, I have hereunto subscribed my name and affixed my official seal, the day and year last above written.

Submitted to the Wichita-Sedgwick County Metropolitan Area Planning Commission and the Board of Commissioners of the City of Wichita, Kansas, and approved by said Board of Commissioners of the City of Wichita, Kansas,

this _____

City Clerk

Edna N. Dunn
Edna N. Dunn Notary Public

My Commission Expires: Sept. 27, 1975

