

ACTION

	DATE
S/D COMMITTEE	<u>accepted</u> 7-5-73
M.A.P.C.	<u>accepted</u> 2-12-73
B.C.C./ B.C.C.	<u>Accepted</u> 2-24-73

D-0545 Harriett Morris dedicates utility easement at the southeast corner of Rock Road and Harry -

MAP No. 6045
SEC. No. 29
TWP. No. 27S
RANGE 2E

DEDICATION REPORT AND PROGRESS

CASE No. D - 0545

I. OFFER TO DEDICATE: utility easement
GENERALLY LOCATED: At the Southeast corner of Rock Road and Harry

LEGALLY DESCRIBED AS:
NW Quarter of Sec. 32, Twsp. 27S, Range 2E of the 6th P.M., 10 foot
either side of a centerline described as follows: Beg. at on the E
right-of-way line or Rock Road and 729.07 ft. S of the N line of
said NW 1/4, said point being 65 feet E of the W line of said NW 1/4,
thence bearing S 50°25'07" E a distance of 853.79 ft., thence bearing
S 54°59'33" E a distance of 125.40 ft., thence bearing S 50°25'07" E
a distance of 510 feet, thence bearing S 37°39'32" E a distance of 268 ft.
DEDICATED BY: Harriett Morris to a pt. of ending.

AGENT: _____
ADDRESS: _____
PURPOSE OF DEDICATION: _____ PHONE _____

II. SKETCH.

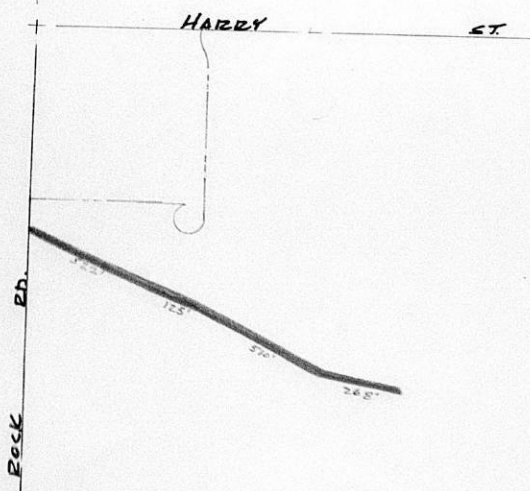

III. FILED 6-27-73
POSTED TO ATLAS
S/D COMM. ACTION 7-5-73 accepted
M.A.P.O. ACTION 7-2-73 accepted
B.C.C. ACTION 2-24-73 accepted
PLACED ON RECORD
CITY CLERKS No. _____

MAPC CASE NO. D-0545 Dedication of utility easement

Dedicated by: Harriett Morris

Generally located in an area extending east from Rock
Road in an area south of Harry Street

This dedication is given for the following reason:
To permit installation and maintenance of public utilities.

ACTION: Accept the dedication and instruct the City Clerk to
file with the Register of Deeds.

T9-325

UTILITY EASEMENT

THIS EASEMENT made this 1st day of June, 19 73,
by and between Harriett Morris of the first part
and the City of Wichita on the second part.

WITNESSETH: That the said first party, , in consideration of the sum
of One Dollar (\$1.00) and other valuable consideration, the receipt whereof is
hereby acknowledged, do hereby grant and convey unto the said second party a
perpetual right-of-way and easement for the purpose of constructing, maintaining,
and repairing public utilities, over, along and under the following described
real estate situated in Sedgwick County, Kansas; to wit:

A tract of land in the Northwest Quarter of Section 32, Township 27 South,
Range 2 East of the 6th P.M., Sedgwick County, Kansas 10 foot either side
of a centerline described as follows:
Beginning at on the East Right-of-Way line of Rock Road and 729.07 feet
south of the north line of said NW 1/4, said point being 65.00 feet
east of the west line of said NW 1/4, thence bearing S 50° 25' 07" E a
distance of 853.79 feet, thence bearing S 54° 59' 33" E a distance of
125.40 feet, thence bearing S 50° 25' 07" E a distance of 510.00 feet,
thence bearing S 37° 39' 32" E a distance of 268.88 feet to a point of
ending.

And said second party is hereby granted the right to enter upon said premises
at any time for the purpose of constructing, operating, maintaining, and repairing
such public utilities.

IN WITNESS WHEREOF: The said first party has signed these presents the
day and year first written.

Harriett Morris
HARRIETT MORRIS

STATE OF KANSAS)
) SS
SEDGWICK COUNTY)

Personally appeared before me, a notary public, in and for the County and
State aforesaid HARRIETT MORRIS
to me personally known to be the same person who executed the foregoing
instrument of writing and said person duly acknowledged the execution thereof.

Dated at Wichita, Kansas, this 1st day of June, 19 73.

William A. Bell
WILLIAM A. BELL

My Commission Expires December 3, 1976



THE CITY OF WICHITA
OFFICE OF Engineering

DATE June 20, 1973.



TO Jack Galbraith, Chief Planner
FROM Dean Sellers, Assistant City Engineer

SUBJECT

Enclosed is a copy of a Utility Easement acquired by the Department of Public Works in connection with the Cedar Lakes Plat at Rock Road and Harry. Please process this easement in the usual manner.

Dean Sellers
Dean Sellers
Assistant City Engineer

DS/mrc
enclosure

