

M.A.P.C.

Account 5-23-74

B.C.C./~~5-23-74~~

Account 8-20-74

D-0595 - Wichita Childrens Home,
Bd. of Park Comm. & Wesley Medi-
cal Center dedicates street
rights of way assoc. with Wesley
Hospital 2nd Add. located on the

POSTED
4-11-74
CY

ACTION

	DATE
SID COMMITTEE <u>accept</u>	5.16.74
M.A.P.C. <u>accept</u>	5.23.74
B.C.C./ W <u>Accepted</u>	8-20-74

D-0595 - Wichita Childrens Home,
Bd. of Park Comm. & Wesley Medi-
cal Center dedicates street
rights of way assoc. with Wesley
Hospital 2nd Add located on the

DEDICATION REPORT AND PROGRESS

MAP No. 5748
 SEC. No. 14
 TWP. No. 27
 RANGE _____

CASE No. D - 0595

I. OFFER TO DEDICATE: Street rights of way
 GENERALLY LOCATED: East side of Hillside in an area north of Central

LEGALLY DESCRIBED AS:

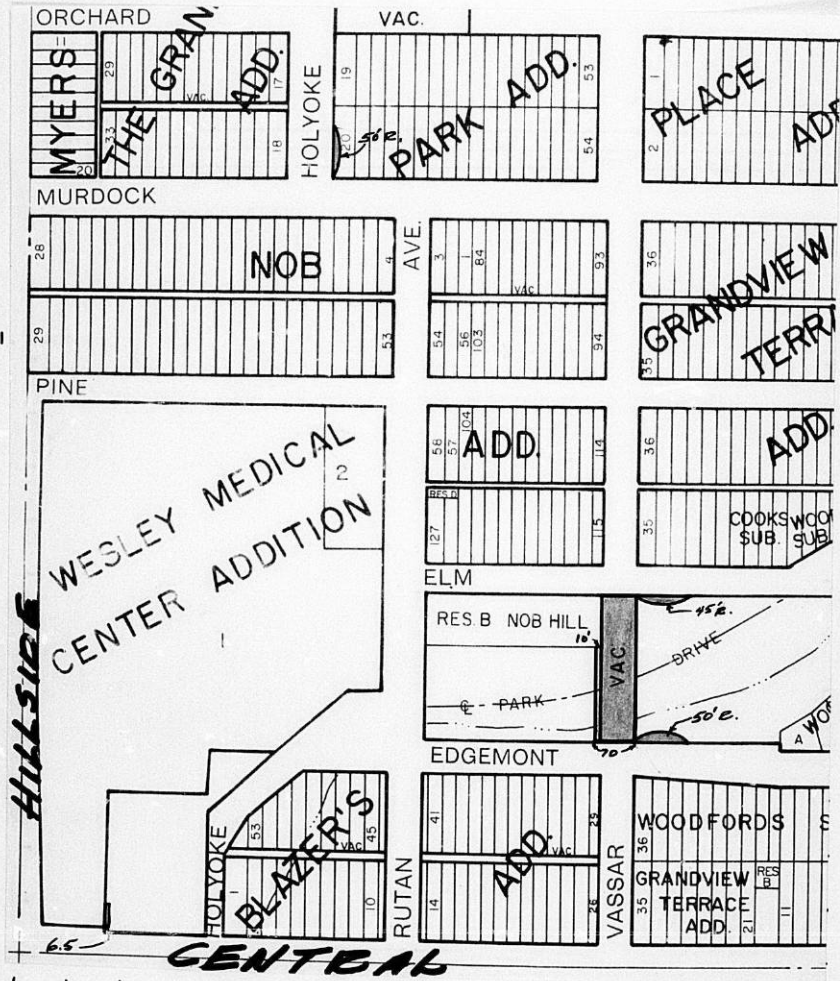

III. FILED 3-29-74
 POSTED TO ATLAS YES
 S/D COMM. ACTION 5-16-74 accept
 M.A.P.C. ACTION 5-23-74 accept

B.C.C. ACTION 8-27-74 Accepted
 PLACED ON RECORD _____
 CITY CLERKS No. _____

MAPC CASE NO. D-0595 Dedication of street rights-of-way

Dedicated by: The Board of Park Commissioners of the
City of Wichita, Kansas, et al.

Generally located in an area east of Hillside
and north of Central

This dedication is given for the following reason:

**For street rights-of-way for Vassar and to terminate Edgemont
Place, Elm and Holyoke with cul-de-sacs.**

ACTION: Accept the dedication and instruct the City Clerk to
file with the Register of Deeds.

DEDICATION

KNOW ALL MEN BY THESE PRESENTS:

That for and in consideration of the sum of One Dollar (\$1.00) and other good and valuable considerations, the receipt of which is hereby acknowledged, the undersigned, THE BOARD OF PARK COMMISSIONERS OF THE CITY OF WICHITA, KANSAS

being the owner of the following described real estate in Sedgwick County, Kansas, to wit:

Beginning at a point on the south line of Ingals, now Elm Street, extended east as platted in Nob Hill Addition to Wichita, Kansas, and 60 feet east of the N.E. Corner of Reserve B in said Addition; thence east on extended south line of Elm Street 90 feet; thence southwesterly, westerly and northwesterly along a curve having a radius of 45 feet and through a central angle of 180°-00", a distance of 141.37 feet to the point of beginning.

do hereby dedicate the above described real estate to the public for cul de sac purposes.

Executed this 11th day of March 19 74.

THE BOARD OF PARK COMMISSIONERS OF THE CITY OF WICHITA, KANSAS

Wilma Burkle - Clerk

G. Gordon Dotzour, President

ATTEST: Wilma Burkle - Clerk STATE OF KANSAS) SEDGWICK COUNTY) ss

BE IT REMEMBERED, that on this 11th day of March, 1974, G. Gordon Dotzour, President of the Board of Park Commissioners of the City of Wichita, Kansas,

to me personally known to be the same person who executed the foregoing instrument and duly acknowledged the execution of the same.

IN WITNESS WHEREOF, I have hereunto subscribed my name and affixed my official seal, the day and year last above written.

Submitted to the Wichita-Sedgwick County Metropolitan Area Planning Commission and the Board of Commissioners of the City of Wichita, Kansas, and approved by said Board of Commissioners of the City of Wichita, Kansas,

this City Clerk

Notary Public seal for Gale E. Pennick, Notary Public, Kansas, commission expires 2/17/78.

My Commission Expires: 2/17/78

APPROVED AS TO FORM

BERNARD J. GORST Assistant City Attorney

2/22/74 Date

DEDICATION

KNOW ALL MEN BY THESE PRESENTS:

That for and in consideration of the sum of One Dollar (\$1.00) and other good and valuable considerations, the receipt of which is hereby

acknowledged, the undersigned, THE BOARD OF PARK COMMISSIONERS

OF THE CITY OF WICHITA, KANSAS

being the owner of the following described real estate in Sedgwick County, Kansas, to wit:

Beginning at a point on the north line of Edgemont Place as platted in Blazers Addition to Wichita, Kansas at the intersection of the east line of Vassar Avenue, as platted in said Addition, extended north; thence east along the north line of Edgemont Place 97.08 feet; thence northwesterly, westerly and southwesterly along a curve having a radius of 50 feet, and through a central angle of 152°-13'-38", a distance of 132.84 feet to the place of beginning.

do hereby dedicate the above described real estate to the public for cul de sac purposes.

Executed this 11th day of March 19 74.

THE BOARD OF PARK COMMISSIONERS
OF THE CITY OF WICHITA, KANSAS

Wilma Burkle
ATTEST:
Wilma Burkle - Clerk
STATE OF KANSAS)
SEDGWICK COUNTY) ss

G. Gordon Dotzour
G. Gordon Dotzour, President

BE IT REMEMBERED, that on this 11th day of March, 1974,

came G. Gordon Dotzour, President of the Board of Park Commissioners of the City of Wichita, Kansas,

to me personally known to be the same person who executed the foregoing instrument and duly acknowledged the execution of the same.

IN WITNESS WHEREOF, I have hereunto subscribed my name and affixed my official seal, the day and year last above written.

Submitted to the Wichita-Sedgwick County Metropolitan Area Planning Commission and the Board of Commissioners of the City of Wichita, Kansas, and approved by said Board of Commissioners of the City of Wichita, Kansas,

this _____

City Clerk

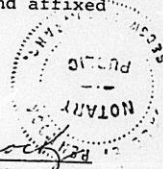

G. E. Pennock
Notary Public

My Commission Expires: 2/17/78

APPROVED AS TO FORM

Bernard V. Borst
BERNARD V. BORST
Assistant City Attorney

2/20/74 Date

D E D I C A T I O N

KNOW ALL MEN BY THESE PRESENTS:

That for and in consideration of the sum of One Dollar (\$1.00) and other good and valuable considerations, the receipt of which is hereby

acknowledged, the undersigned, THE BOARD OF PARK COMMISSIONERS
OF THE CITY OF WICHITA, KANSAS

being the owner of the following described real estate in Sedgwick County, Kansas, to wit:

Beginning at the N.E. Corner of Reserve B in Nob Hill Addition to Wichita, Kansas; thence south along the east side of said Reserve 90 feet; thence west parallel with the north line of said Reserve (south line of Elm Street) 10 feet; thence south along a line parallel with and 10 feet west of the west line of Vassar as platted in said Addition to the north line of Edgemont Place as platted in Blazers Addition to Wichita, Kansas; thence east along the north line of said Edgemont Place 70 feet; thence north to the south line of said Elm Street, extended east; thence west 60 feet to the place of beginning.

do hereby dedicate the above described real estate to the public for _____ street _____ purposes.

Executed this 11th day of March 19 74.

THE BOARD OF PARK COMMISSIONERS
OF THE CITY OF WICHITA, KANSAS

Wilma Burkle

ATTEST: Wilma Burkle - Clerk

G. Gordon Dotzour

G. Gordon Dotzour, President

STATE OF KANSAS)
SEDGWICK COUNTY)^{SS}

BE IT REMEMBERED, that on this 11th day of March, 1974,

came G. Gordon Dotzour, President of the Board of Park

Commissioners of the City of Wichita, Kansas,

to me personally known to be the same person who executed the foregoing instrument and duly acknowledged the execution of the same.

IN WITNESS WHEREOF, I have hereunto subscribed my name and affixed my official seal, the day and year last above written.

Submitted to the Wichita-Sedgwick County Metropolitan Area Planning Commission and the Board of Commissioners of the City of Wichita, Kansas, and approved by said Board of Commissioners of the City of Wichita, Kansas,
this _____,

City Clerk

Gale E. Pennock
Notary Public



My Commission Expires: 2/17/78

APPROVED AS TO FORM

Bernard V. Borst
BERNARD V. BORST
Assistant City Attorney

2/28/74 Date

DEDICATION

KNOW ALL MEN BY THESE PRESENTS:

That for and in consideration of the sum of One Dollar (\$1.00) and other good and valuable considerations, the receipt of which is hereby acknowledged, the undersigned, as President of the Board of Directors of the Wichita Children's Home which is

~~being~~ the owner of the following described real estate in Sedgwick County, Kansas, to wit:

Part of Lot 20, on Murdock Avenue in Sunrise Park Addition, Wichita, Kansas, described as beginning at the S. W. Corner of said Lot 20; thence north along the west line of said Lot, 91.65-feet; thence southeasterly, southerly and southwesterly along a curve having a radius of 50 feet, and through a central angle of 132°-50'-35", a distance of 115.93 feet to the place of beginning.

does hereby dedicate the above described real estate to the public for cul de sac purposes.

Executed this 28th day of February 19 74.

[Signature]

Mrs. Betty Minkler
MRS. BETTY MINKLER

STATE OF KANSAS)
SEDGWICK COUNTY)^{ss}

BE IT REMEMBERED, that on this 28th day of February, 1974,
came Mrs. Betty Minkler

to me personally known to be the same person who executed the foregoing instrument and duly acknowledged the execution of the same.

IN WITNESS WHEREOF, I have hereunto subscribed my name and affixed my official seal, the day and year last above written.

Submitted to the Wichita-Sedgwick County Metropolitan Area Planning Commission and the Board of Commissioners of the City of Wichita, Kansas, and approved by said Board of Commissioners of the City of Wichita, Kansas,
this _____,
City Clerk

D. Renai Harrison
Notary Public

My Commission Expires: Oct 10, 1977

