

D-0601 - Jerry Gaddis dedicates
sewer easement at southwest
corner English & Rutan.

COMMITTEE

M.A.P.G.

B.C.C./B.C.O.G. 5-21-74 ~~ACCEPTED~~

(ASSOCIATED WITH
Y-0680)

POSTED

5-29-74

[Handwritten signature]

ACTION

DATE

COMMITTEE _____

M.A.P.C. _____

B.C.C./B. CO. C. ~~5-21-74~~ ^{ACCEPTED} _____

(ASSOCIATED WITH
V-0680)

D-0601 - Jerry Gaddis dedicates
sewer easement at southwest
corner English & Rutan.

MAP No. 5747
 SEC. No. 23
 TWP. No. 27
 RANGE 1E

DEDICATION REPORT AND PROGRESS
 CASE No. D - 0601

I. OFFER TO DEDICATE: sewer easement
 GENERALLY LOCATED: southwest corner English and Rutan.

LEGALLY DESCRIBED AS:

A north-south 10 foot easement centered on a point 9½ feet east of the west property line of Lots 12, 14, 16, 18, 20 and 22 on English Street, formerly known as Maple, B. D. Allen's Addition to Wichita, commonly known as 205 South Rutan, Wichita, Sedgwick County, Kansas.

DEDICATED BY: Jerry A. Gaddis
 AGENT: _____
 ADDRESS: _____ PHONE _____
 PURPOSE OF DEDICATION: _____

sewer easement

II. SKETCH.

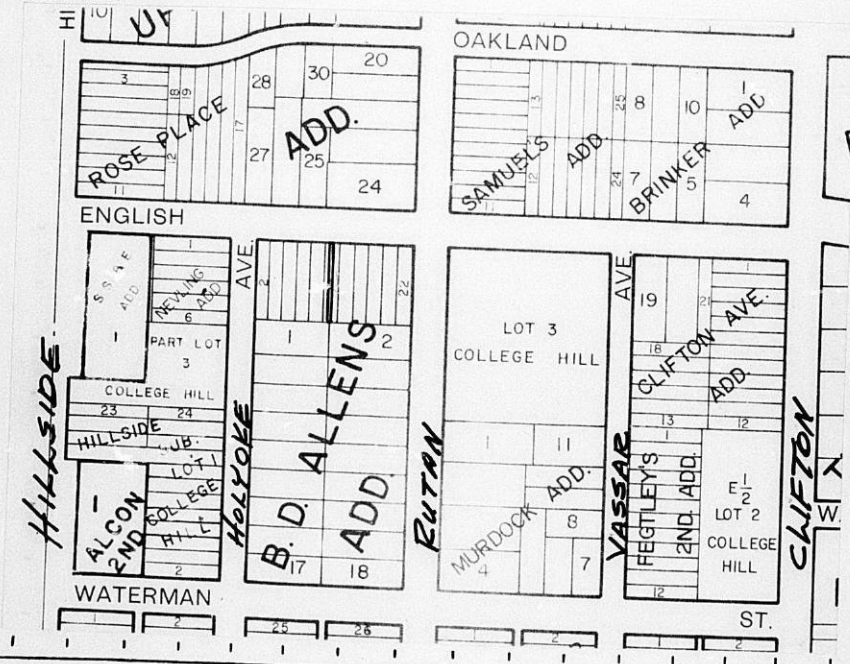

III. FILED 5-22-74
 POSTED TO ATLAS YES
 S/D COMM. ACTION not req.
 M.A.P.C. ACTION not req.
 B.C.C. ACTION 5-21-74 accepted
(associated with V-0680)
 PLACED ON RECORD
 CITY CLERKS No. _____

THIS EASEMENT made this 25th day of April, 1974,

by and between JERRY A. GADDIS
of the first part and the City of Wichita of the second part.

WITNESSETH: That the said first party, in consideration of the sum of One Dollar (\$1.00) and other valuable consideration, the receipt whereof is hereby acknowledged, do hereby grant and convey unto the said second party a perpetual right-of-way and easement for the purpose of constructing, maintaining, and repairing sewer pipes and a sewer system according to the plans and specifications now on file in the office of the City Engineer of the City of Wichita, Kansas, over, along and under the following described real estate situated in Sedgwick County, Kansas, to wit:

A north-south 10 foot easement centered on a point 9½ feet east of the west property line of Lots 12, 14, 16, 18, 20 and 22 on English Street, formerly known as Maple, B. D. Allen's Addition to Wichita, commonly known as 205 South Rutan, Wichita, Sedgwick County, Kansas

And said second party is hereby granted the right to enter upon said premises at any time for the purpose of constructing, operating, maintaining, and repairing such sewer and sewer system.

IN WITNESS WHEREOF: The said first party has signed these presents the day and year first written.

Jerry A. Gaddis
Jerry A. Gaddis

STATE OF KANSAS)
SEDGWICK COUNTY) SS

Personally appeared before me a notary public in and for the County and State aforesaid Jerry A. Gaddis

to me personally known to be the same person who executed the foregoing instrument of writing and said person duly acknowledged the execution thereof.



Witnessed at Wichita, Kansas, this 25th day of April, 1974.

William W. Green
Notary Public

My Commission expires My Commission Expires Aug. 23, 1976

FORM 42-017

EASEMENT

THIS EASEMENT made this 25th day of April, 1974,

by and between JERRY A. GADDIS

of the first part and the City of Wichita of the second part.

WITNESSETH: That the said first part y, in consideration of the sum of One Dollar (\$1.00) and other valuable consideration, the receipt whereof is hereby acknowledged, do hereby grant and convey unto the said second party a perpetual right-of-way and easement for the purpose of constructing, maintaining, and repairing sewer pipes and a sewer system according to the plans and specifications now on file in the office of the City Engineer of the City of Wichita, Kansas, over, along and under the following described real estate situated in Sedgwick County, Kansas, to wit:

A north-south 10 foot easement centered on a point $9\frac{1}{2}$ feet east of the west property line of Lots 12, 14, 16, 18, 20 and 22 on English Street, formerly known as Maple, B. D. Allen's Addition to Wichita, commonly known as 205 South Rutan, Wichita, Sedgwick County, Kansas

And said second party is hereby granted the right to enter upon said premises at any time for the purpose of constructing, operating, maintaining, and repairing such sewer and sewer system.

IN WITNESS WHEREOF: The said first party y has signed these presents the day and year first written.

Jerry A. Gaddis
Jerry A. Gaddis

STATE OF KANSAS)
SEDGWICK COUNTY) SS

Personally appeared before me a notary public in and for the County and State aforesaid Jerry A. Gaddis

to me personally known to be the same person who executed the foregoing instrument of writing and said person duly acknowledged the execution thereof.

Witness my hand and seal at Wichita, Kansas, this 25th day of April, 1974.

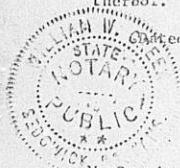

William W. Green
Notary Public

My Commission expires My Commission Expires Aug. 28, 1976