

D-0607 - Wichita Land Company  
dedicates street r-o-w on east  
side of Webb Rd. in an area so.  
of 37th St. North.

V-0814

B.C.C. ~~10-22-74~~ Accepted 10-22-74

POSTED  
9-30-74  
[Signature]

ACTION

DATE

SID COMMITTEE Accepted 10.3.74

M.A.P.C. accepted 10-10-74

B.C.C. ~~Accepted~~ Accepted 10-22-74

1-081

D-0607 - Wichita Land Company  
dedicates street I-O-W on east  
side of Webb Rd. in an area so.  
of 37th St. North.

DEDICATION REPORT AND PROGRESS

CASE No. D - 0607

MAP No. 6151  
 SEC. No. \_\_\_\_\_  
 TWP. No. \_\_\_\_\_  
 RANGE \_\_\_\_\_

I. OFFER TO DEDICATE: street right of way  
 GENERALLY LOCATED: East side of Webb Road in an area south of 37th St. North

LEGALLY DESCRIBED AS: Beg. at a pt. 25' so. and 30' east of the NW corner of Sec. 33 Twp, 26S, R-2E of the 6th P.M., Sedg. Co., Ks; th easterly, along the so. line of 37th St. No. 90'; th southerly parallel with the west line of said NW quarter, 250' th southwesterly to a pt. 40' east and 750' so. of said NW corner; th westerly to a pt. on the east line of Webb Rd, said pt. being 725' so. of the pt. of beg; th northerly, along said E line to the pt. of beg.  
 Also beg. at a pt. 25' N and 40' E of the SW corner of the SW Quarter of Sec. 28, Twp. 26 S, R-2E of the 6th P.M. Sedg. Co., Ks; th E, along the N line of 37th St. 800'; th N, at rt. angles to said N line, 25' th NW to a pt. 125' N and 370' E of said SW corner; th W, parallel with the S line of said SW Quarter, 250' th NW to a pt. 50' E and 800' N of said SW corner; th W to a pt. on the E line of Webb Rd, said pt. being 775' N of the pt. of beg; th S, along said E line to the pt. of beg.

Dedicated By: Wichita Land Company  
 Agent: J. Thomas Cushman, President  
 Address: \_\_\_\_\_  
 Purpose of Dedication: Street right of way

II. SKETCH.



III. FILED 9-23-74 B.C.C. ACTION 10-22-74  
 POSTED TO ATLAS 465  
 S/D COMM. ACTION 10-3-74 Accepted PLACED ON RECORD \_\_\_\_\_  
 M.A.P.C. ACTION 10-10-74 Accepted CITY CLERKS No. \_\_\_\_\_

MAPC CASE NO. D-0607 Dedication of Street right-of-way

Dedicated by: Wichita Land Company

Generally East side of Webb Road in an  
area south of 37th Street North

This dedication is given for the following reason: Street right-of-way

ACTION: Accept the dedication and instruct the City Clerk to  
file with the Register of Deeds.

T9-325

Film 121 Pg. 1032



ARCHITECTS - ENGINEERS

**VAN DOREN - HAZARD - STALLINGS**

250 ROCKBOROUGH BUILDING, 260 NORTH ROCK ROAD WICHITA, KANSAS 67206  
TELEPHONE 316 686-7303

D-0607

September 4, 1974

Re: Comotara Business Park  
Right of Way Dedication  
Our Job No. 4-074-004 A0

Wichita-Sedgwick County  
Metropolitan Area Planning Dept.  
104 South Main Street  
City Building Annex  
Wichita, Kansas 67202

Attn: Curtis Newby

Dear Mr. Newby:

Submitted herewith is the right of way dedication for  
the future expansion of 37th Street North and Webb Road.

This dedication is being granted in compliance with  
recommendations from the Subdivision Committee indicated  
under Item B.

Very truly yours,

*John E. Lundblade*

John E. Lundblade

JEL:et

cc: Dean Sellers, Engineering Dept.  
Wichita Land Company

*on the east side of Webb Road  
in an area south of 37th St No*



DEDICATION

KNOW ALL MEN BY THESE PRESENTS:

That for and in consideration of the sum of One Dollar (\$1.00) and other good and valuable considerations, the receipt of which is hereby acknowledged, the undersigned, Wichita Land Company

being the owner of the following described real estate in Sedgwick County, Kansas, to wit:

Beginning at a point 25.00 feet south and 30.00 feet East of the Northwest corner of Section 33, Township 26 South, Range 2 East of the 6th P.M., Sedgwick County, Kansas; thence Easterly, along the South line of 37th Street North, 90.00 feet; thence Southerly parallel with the west line of said Northwest quarter, 250.00 feet; thence Southwesterly to a point 40.00 feet East and 750.00 feet south of said Northwest corner; thence Westerly to a point on the East line of Webb Road, said point being 725.00 feet South of the point of beginning; thence Northerly, along said East line to the point of beginning.

Also beginning at a point 25.00 feet North and 40.00 feet East of the Southwest corner of the Southwest quarter of Section 28, Township 26 South, Range 2 East of the 6th P.M., Sedgwick County, Kansas; thence Easterly, along the North line of 37th Street North, 800.00 feet; thence Northerly, at right angles to said North line, 25.00 feet; thence Northwesterly to a point 125.00 feet North and 370.00 feet East of said Southwest corner; thence Westerly, parallel with the South line of said Southwest quarter, 250.00 feet; thence Northerly, parallel with the west line of said Southwest quarter, 250.00 feet; thence Northwesterly to a point 50.00 feet East and 800.00 feet North of said Southwest corner; thence Westerly to a point on the East line of Webb Road, said point being 775.00 feet North of the point of beginning; thence Southerly, along said East line to the point of beginning.

do hereby dedicate the above described real estate to the public for street purposes.

Executed this 30th day of August, 1974.

WICHITA LAND COMPANY

J. Thomas Cushman  
J. Thomas Cushman, President



STATE OF KANSAS)  
SEDGWICK COUNTY) SS

BE IT REMEMBERED, that on this 30th day of August, 1974, before me a Notary Public in and for the said County and State came

J. Thomas Cushman

to me personally known to be the same person who executed the foregoing instrument and duly acknowledged the execution of the same.

IN WITNESS WHEREOF, I have hereunto subscribed my name and affixed my official seal, the day and year last above written.



My Commission expires Sept 5, 1976.

Elaine B. Tischer  
Notary Public

DEDICATION

KNOW ALL MEN BY THESE PRESENTS:

That for and in consideration of the sum of One Dollar (\$1.00) and other good and valuable considerations, the receipt of which is hereby acknowledged, the undersigned, Wichita Land Company

being the owner of the following described real estate in Sedgwick County, Kansas, to wit:

Beginning at a point 25.00 feet south and 30.00 feet East of the Northwest corner of Section 33, Township 26 South, Range 2 East of the 6th P.M., Sedgwick County, Kansas; thence Easterly, along the South line of 37th Street North, 90.00 feet; thence Southerly parallel with the west line of said Northwest quarter, 250.00 feet; thence Southwesterly to a point 40.00 feet East and 750.00 feet south of said Northwest corner; thence Westerly to a point on the East line of Webb Road, said point being 725.00 feet South of the point of beginning; thence Northerly, along said East line to the point of beginning.

Also beginning at a point 25.00 feet North and 40.00 feet East of the Southwest corner of the Southwest quarter of Section 28, Township 26 South, Range 2 East of the 6th P.M., Sedgwick County, Kansas; thence Easterly, along the North line of 37th Street North, 800.00 feet; thence Northerly, at right angles to said North line, 25.00 feet; thence Northwesterly to a point 125.00 feet North and 370.00 feet East of said Southwest corner; thence Westerly, parallel with the South line of said Southwest quarter, 250.00 feet; thence Northerly, parallel with the west line of said Southwest quarter, 250.00 feet; thence Northwesterly to a point 50.00 feet East and 800.00 feet North of said Southwest corner; thence Westerly to a point on the East line of Webb Road, said point being 775.00 feet North of the point of beginning; thence Southerly, along said East line to the point of beginning.

do es hereby dedicate the above described real estate to the public for street purposes.

Executed this 30th day of August, 1974.

WICHITA LAND COMPANY

*J. Thomas Cushman*

J. Thomas Cushman, President



STATE OF KANSAS)  
(SEDGWICK COUNTY) SS

BE IT REMEMBERED, that on this 30th day of August, 1974, before me a Notary Public in and for the said County and State came

J. Thomas Cushman

to me personally known to be the same person who executed the foregoing instrument and duly acknowledged the execution of the same.

IN WITNESS WHEREOF, I have hereunto subscribed my name and affixed my official seal, the day and year last above written.



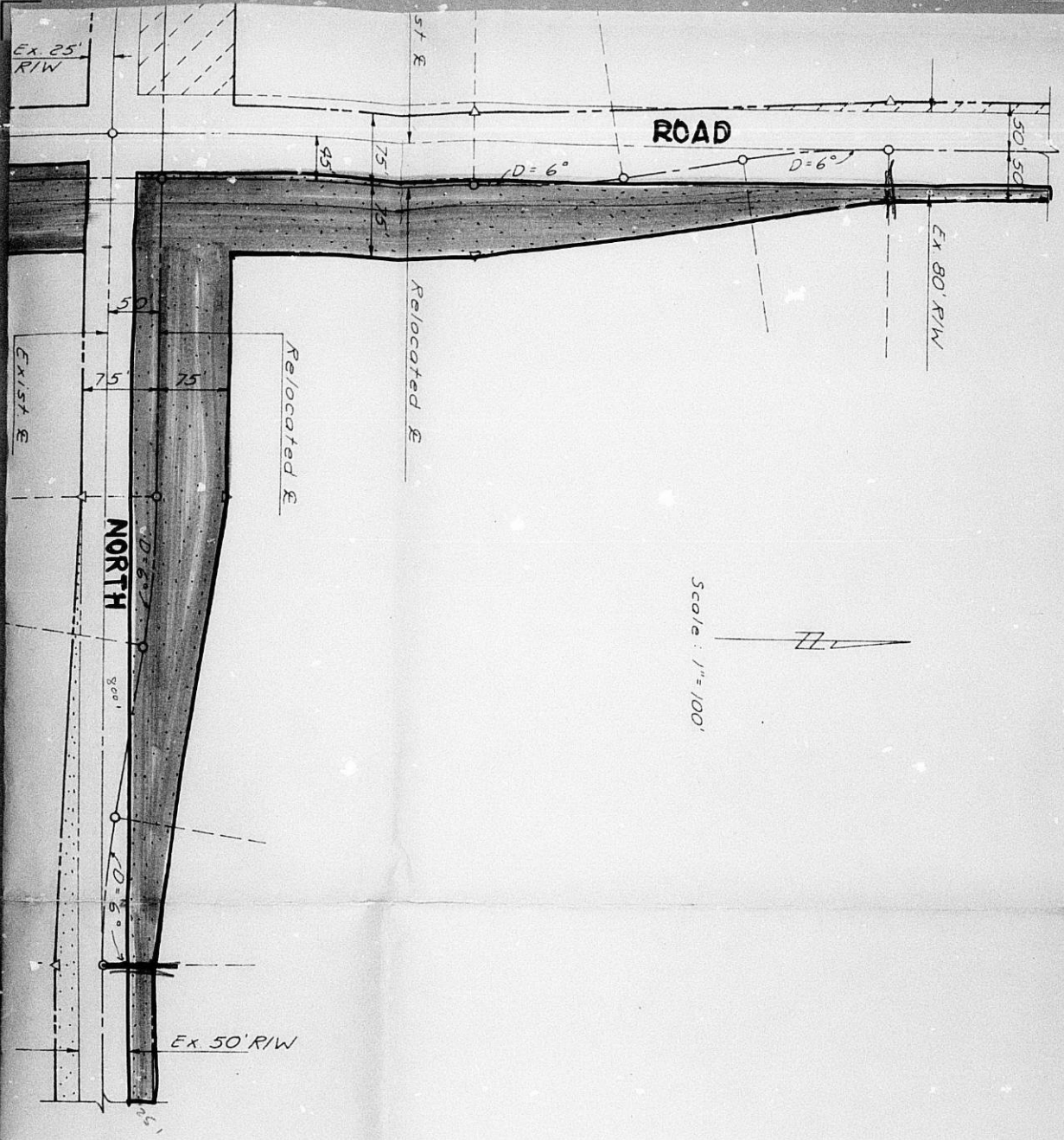

*Elaine B. Tischhauser*  
Notary Public

My Commission expires Sept 5, 1976.

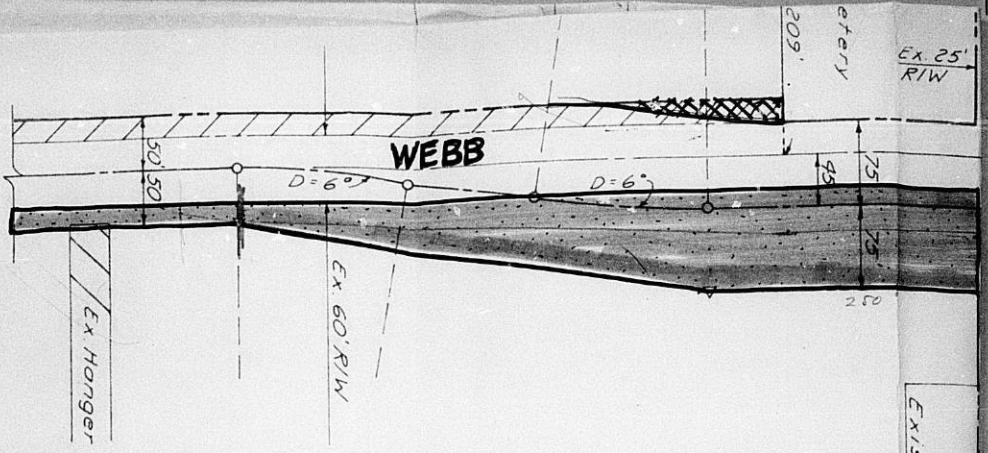



EXIST E

- LEGEND
-  Wichita Land Co. R/W by plotting
  -  Wichita Land Co. R/W by separate instrument
  -  R/W from others by separate instrument

DESIGN	
DR. BY	
CK. BY	
DATE	
JOB NO.	

VAN DOREN, HAZARD, STALLINGS  
 ENGINEERS ARCHITECTS . . . 1044  
 PROPOSED RELC  
 OF 37TH ST. NO  
 WEBB RD. INTER

