

D-0608 - Leisure Living, Inc.  
dedicates sewer easement on no.  
side of 13th St. No.,  $\frac{1}{4}$  mi. west  
of Rock Road.

*POSTED*  
*9-30-74*  
*[Signature]*

ACTION

DATE

*10.3.74*

*Accepted*

SID COMMITTEE

*10.10.74*

*accepted*

M.A.P.C.

*10-30-74*

*Accepted*

~~R.C.C.~~

DEDICATION REPORT AND PROGRESS

MAP No. 5949  
 Sec. No. 7  
 TWP. No. 27S  
 RANGE 2E

CASE No. D - 0608

I. OFFER TO DEDICATE: Sewer Easement  
 GENERALLY LOCATED: North side of 13th St. North, 1/4 mile west of Rock Road.

LEGALLY DESCRIBED AS: A strip of land 20.00 ft. in width lying 10.00 ft. on each side of the following described center line: Beginning at a point on the west line of the east one-half of the SE Quarter of the SE Quarter of Sec. 7, Twp. 27S. R-2E of the 6th P.M., Sedgwick Co., Kansas, said point being 65.00 ft. north of the SW corner of said east one-half; thence easterly, parallel with the south line of said east one-half, a distance of 107.00 ft; thence north-easterly through an angle to the left of 61°57'56", a distance of 31.91 ft.

DEDICATED BY: Leisure Living, Inc.  
 AGENT: N. Lee Aronfeld, President  
 ADDRESS: \_\_\_\_\_ PHONE \_\_\_\_\_  
 PURPOSE OF DEDICATION: \_\_\_\_\_

Sewer easement

II. SKETCH.

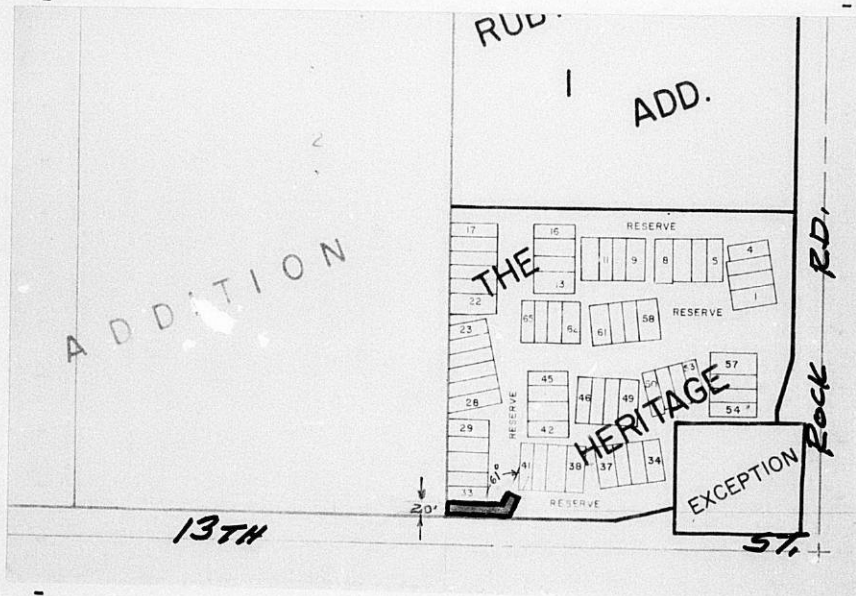

III. FILED 9-23-74  
 POSTED TO ATLAS YES  
 S/D COMM. ACTION 10-3-74 Accepted  
 M.A.P.C. ACTION 10-10-74 Accepted  
 B.C.C. ACTION 10-22-74  
 PLACED ON RECORD \_\_\_\_\_  
 CITY CLERKS No. \_\_\_\_\_

EASEMENT

THIS EASEMENT MADE THIS 29th DAY OF August, 1974,

BY AND BETWEEN Leisure Living, Inc.

OF THE FIRST PART AND THE CITY OF WICHITA, OF THE SECOND PART.

WITNESSETH: THAT THE SAID FIRST PARTY, IN CONSIDERATION OF THE SUM OF ONE DOLLAR (\$1.00) AND OTHER VALUABLE CONSIDERATION, THE RECEIPT WHEREOF IS HEREBY ACKNOWLEDGED, DO HEREBY GRANT AND CONVEY UNTO THE SAID SECOND PARTY A PERPETUAL RIGHT-OF-WAY AND EASEMENT FOR THE PURPOSE OF CONSTRUCTING, MAINTAINING, AND REPAIRING SEWER AND ALL OTHER PUBLIC UTILITIES, OVER, ALONG AND UNDER THE FOLLOWING DESCRIBED REAL ESTATE SITUATED IN SEDGWICK COUNTY, KANSAS, TOWIT:

A strip of land 20.00 feet in width lying 10.00 feet on each side of the following described center line:

Beginning at a point on the west line of the east one-half of the southeast quarter of the southeast quarter of Section 7, Township 27 South, Range 2 East of the 6th P.M., Sedgwick County, Kansas, said point being 65.00 feet north of the southwest corner of said east one-half; thence easterly, parallel with the south line of said east one-half, a distance of 107.00 feet; thence northeasterly through an angle to the left of 61° 57' 56", a distance of 31.91 feet.

AND SAID SECOND PARTY IS HEREBY GRANTED THE RIGHT TO ENTER UPON SAID PREMISES AT ANY TIME FOR THE PURPOSE OF CONSTRUCTING, OPERATING, MAINTAINING, AND REPAIRING SUCH SEWER AND ALL OTHER PUBLIC UTILITIES.

IN WITNESS WHEREOF: THE SAID FIRST PARTY HAS SIGNED THESE PRESENTS THE DAY AND YEAR FIRST WRITTEN.

Leisure Living, Inc.

N. Lee Aronfeld  
N. Lee Aronfeld, President

STATE OF KANSAS)  
SEDGWICK COUNTY) SS

PERSONALLY APPEARED BEFORE ME A NOTARY PUBLIC IN AND FOR THE COUNTY AND STATE AFORESAID

N. Lee Aronfeld

TO ME PERSONALLY KNOWN TO BE THE SAME PERSON WHO EXECUTED THE FOREGOING INSTRUMENT OF WRITING AND SAID PERSON DULY ACKNOWLEDGED THE EXECUTION THEREOF.

DATED AT WICHITA, KANSAS, THIS 29th DAY OF September, 1974.

Cecilia M. Blackwell  
NOTARY PUBLIC



MY COMMISSION EXPIRES April 24 1978

MAPC CASE NO. D-0608 Dedication of Sewer easement

Dedicated by: Leisure Living, Inc.

Generally located on the north side of 13th Street  
1/4 mile west of Rock Road

This dedication is given for the following reason: Sewer easement

ACTION: Accept the dedication and instruct the City Clerk to  
file with the Register of Deeds.

T9-325



ARCHITECTS - ENGINEERS

**VAN DOREN - HAZARD - STALLINGS**

250 ROCKBOROUGH BUILDING, 260 NORTH ROCK ROAD WICHITA, KANSAS 67206  
TELEPHONE 316 686-7303

*D-0608*

August 29, 1974

Re: Leisure Living Ventures  
First Addition  
Easement Dedication  
Our Job No. 4-073-007-A0

Wichita-Sedgwick County  
Metropolitan Area Planning Dept.  
104 South Main Street  
City Building Annex  
Wichita, Kansas 67202

Attn: Curtis Newby

Dear Mr. Newby:

Submitted herewith is an additional easement  
dedication for Leisure Living Ventures First Addition.

This easement is required for the extension  
of the sanitary sewer to serve the project.

Very truly yours,

*John E. Lundblade*

John E. Lundblade

JEL:et

*on the north side of 13<sup>th</sup> St Mo  
1/4 mi. west of ~~Wichita~~  
→ Rock Rd.*



EASEMENT

THIS EASEMENT MADE THIS 29th DAY OF August, 1974,  
BY AND BETWEEN Leisure Living, Inc.  
OF THE FIRST PART AND THE CITY OF WICHITA, OF THE SECOND PART.

WITNESSETH: THAT THE SAID FIRST PARTY, IN CONSIDERATION OF THE SUM OF ONE DOLLAR (\$1.00) AND OTHER VALUABLE CONSIDERATION, THE RECEIPT WHEREOF IS HEREBY ACKNOWLEDGED, DO HEREBY GRANT AND CONVEY UNTO THE SAID SECOND PARTY A PERPETUAL RIGHT-OF-WAY AND EASEMENT FOR THE PURPOSE OF CONSTRUCTING, MAINTAINING, AND REPAIRING SEWER AND ALL OTHER PUBLIC UTILITIES, OVER, ALONG AND UNDER THE FOLLOWING DESCRIBED REAL ESTATE SITUATED IN SEDGWICK COUNTY, KANSAS, TOWIT:

A strip of land 20.00 feet in width lying 10.00 feet on each side of the following described center line:

Beginning at a point on the west line of the east one-half of the southeast quarter of the southeast quarter of Section 7, Township 27 South, Range 2 East of the 6th P.M., Sedgwick County, Kansas, said point being 65.00 feet north of the southwest corner of said east one-half; thence easterly, parallel with the south line of said east one-half, a distance of 107.00 feet; thence northeasterly through an angle to the left of 61° 57' 56", a distance of 31.91 feet.

AND SAID SECOND PARTY IS HEREBY GRANTED THE RIGHT TO ENTER UPON SAID PREMISES AT ANY TIME FOR THE PURPOSE OF CONSTRUCTING, OPERATING, MAINTAINING, AND REPAIRING SUCH SEWER AND ALL OTHER PUBLIC UTILITIES.

IN WITNESS WHEREOF: THE SAID FIRST PARTY HAS SIGNED THESE PRESENTS THE DAY AND YEAR FIRST WRITTEN.

Leisure Living, Inc.

N. Lee Aronfeld President

STATE OF KANSAS)  
SEDGWICK COUNTY) SS

PERSONALLY APPEARED BEFORE ME A NOTARY PUBLIC IN AND FOR THE COUNTY AND STATE AFORESAID

N. Lee Aronfeld

TO ME PERSONALLY KNOWN TO BE THE SAME PERSON WHO EXECUTED THE FOREGOING INSTRUMENT OF WRITING AND SAID PERSON DULY ACKNOWLEDGED THE EXECUTION THEREOF.

DATED AT WICHITA, KANSAS, THIS 29th DAY OF September, 1974.



Cynthia B. Blackwell  
NOTARY PUBLIC