

D-0625 William Weber dedicates
street r-o-w for Mt. Carmel for
an area south of 18th St. North

S/D COMMITTEE — Accepted — 2.6.75
M.A.P.C. — Accepted — 2.13.75
B.C.C. / ~~B.C.C.~~ Accepted — 3.11.75

POSTED
1-29-75

ACTION

	DATE
SID COMMITTEE	<u>accepted</u> 2-6-75
M.A.P.C.	<u>accepted</u> 2-13-75
B.C.C./S.C.C.C.	<u>Accepted</u> 3-11-75

D-0625 - William Weber dedicates street r-o-w for Mt. Carmel for an area south of 18th St. North

DEDICATION REPORT AND PROGRESS

MAP No. 5249
 SEC. No. 12
 TWP. No. 27
 RANGE 1W

CASE No. D - 0625

I. OFFER TO DEDICATE: street right of way
 GENERALLY LOCATED: For Mt. Carmel in an area south of 18th St. North

LEGALLY DESCRIBED AS:

The east thirty feet of Lot 4, Block B,
 Sheridan Acres Addition.

DEDICATED BY: William E. Weber
 AGENT: _____
 ADDRESS: _____ PHONE _____
 PURPOSE OF DEDICATION:

street right of way

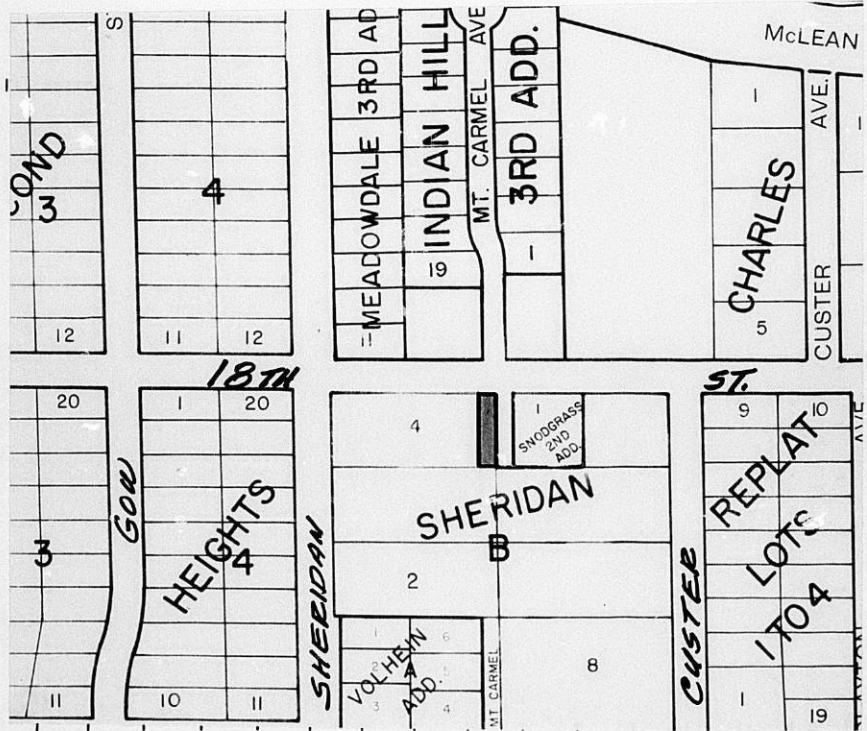

III. FILED 1-22-75
 POSTED TO ATLAS YES
 S/D COMM. ACTION 2-6-75 Accepted
 M.A.P.C. ACTION 2-13-75 Accepted
 B.C.C. ACTION 3-11-75 Accepted
 PLACED ON RECORD _____
 CITY CLERKS No. _____

Newby.



ON SAFETY
PHASE II

THE CITY OF WICHITA

OFFICE OF ENGINEERING

DATE January 9, 1975

TO Curtis Newby - Planning

FROM Donald E. Schneider, Drainage and Sanitary Engineer

SUBJECT Right-of-Way Dedication for
Street Purposes
DAKS574108

Attached for processing is Right-of-Way Dedication signed by William E. Weber and Cynthia A. Weber for the west half of Mt. Carmel, south of 18th Street.

Donald E. Schneider

/tn

Attachment



DEDICATION

Bill Weber
c/o Ron Gott, Attorney
First National Bank Building
Paving 18th Street, Sheridan to
Clayton - Project No. DAKS574108

KNOW ALL MEN BY THESE PRESENTS:

That for and in consideration of the sum of One Dollar (\$1.00) and other good and valuable considerations, the receipt of which is hereby acknowledged, the undersigned, William E. Weber and Cynthia A. Weber, husband and wife, as Joint Tenants and not as tenants in common, with full rights of survivorship, being the owners of the following described real estate in Sedgwick County, Kansas, to wit:

The east thirty (30) feet of Lot 4, Block B, Sheridan Acres Addition.

do hereby dedicate the above described real estate to the public for street purposes.

Executed this 6th day of January, 1975.

X William E. Weber
William E. Weber
X Cynthia A. Weber
Cynthia A. Weber

STATE OF KANSAS)
SEDGWICK COUNTY) SS

BE IT REMEMBERED, that on this 6th day of January, 1975, before me a Notary Public in and for the said County and State came

WILLIAM E. WEBER and CYNTHIA A. WEBER, husband and wife,

to me personally known to be the same persons who executed the foregoing instrument and duly acknowledged the execution of the same.

IN WITNESS WHEREOF, I have hereunto subscribed my name and affixed my official seal, the day and year last above written.

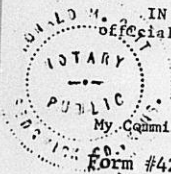

My Commission expires

Feb 9, 1975

Ronald M. Gott
Notary Public
Ronald M. Gott