

D-2803 - George H. Pittsworth. Eas
dedicates Street r-o-w, on the
North side of 13th St., in an area
west of Ridge Road

12/12/78

ACTION

	DATE
S/D COMMITTEE	<u>1-12-78</u>
M.A.P.C.	<u>1-18-78</u>
B.C.C./B-60. C.	<u>1-31-78</u>

DEDICATION REPORT AND PROGRESS

MAP No. 4949
SEC. No. 9
TWP. No. 27
RANGE 1W

CASE No. D - 0803
(Assoc. L/S-0350)

I. OFFER TO DEDICATE: Street r-o-w
GENERALLY LOCATED: on the north side of 13th Street, in an area west of Ridge Road
LEGALLY DESCRIBED AS: _____

DEDICATED BY: George H. Tittsworth, Etux
AGENT: _____
ADDRESS: 853 N. West Street 67202 PHONE _____
PURPOSE OF DEDICATION: _____

II. SKETCH.

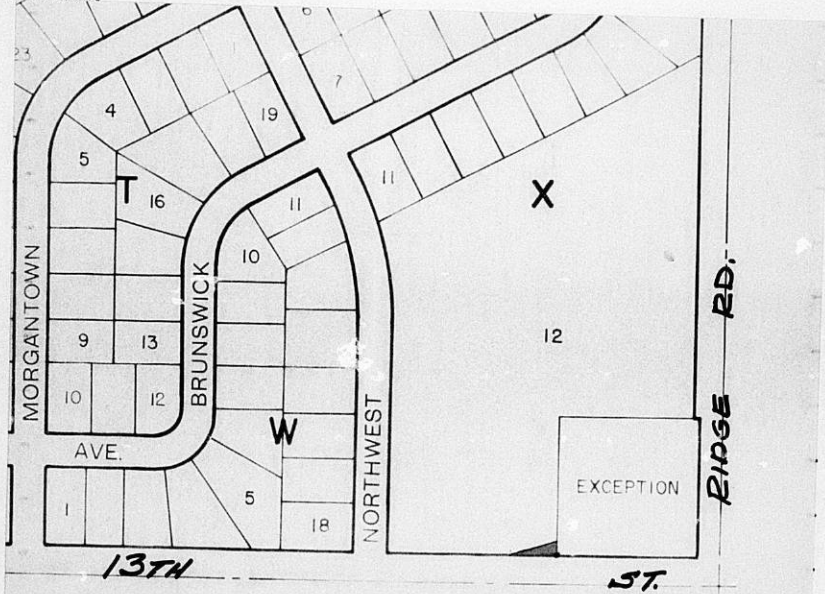

III. FILED 12-30-77
POSTED TO ATLAS _____
S/D COMM. ACTION 1-12-78 Approved
M.A.P.C. ACTION 1-19-78 Approved
B.C.C. ACTION 1-31-78 Approved
PLACED ON RECORD _____
CITY CLERKS No. _____

MAPC CASE NO. D-0803 Dedication of street right-of-way

Dedicated by: George H. Tittsworth, etux.

Generally on the north side of 13th Street, in an area west of Ridge Road

This dedication is given for the following reason: Requirement of lot split approval, case number L/S-0350.

ACTION: Accept the dedication and instruct the City Clerk to file with the Register of Deeds.

BILL RECORDING FEE TO: George H. Tittsworth, 853 N. West Street, Wichita, Kansas 67203

4949
9
27
165

DEDICATION

D-0803

(Assoc. 45-0350)

KNOW ALL MEN BY THESE PRESENTS:

That for and in consideration of the sum of One Dollar (\$1.00) and other good and valuable considerations, the receipt of which is hereby

acknowledged, the undersigned, George H. Tittsworth and

Wanda L. Tittsworth

being the owner s of the following described real estate in Sedgwick County, Kansas, to wit:

Part of Lot 12, Block X, Westridge Village, Sedgwick County, Kansas, described as beginning at a point 296 feet west and 50 feet north of the S.E. Corner of the SE $\frac{1}{4}$ of Sec. 9, Twp. 27-S, R-1-W, being the S.E. Corner of said Lot 12; thence north along the east line of said Lot 12, 25 feet; thence southwesterly 83.68 feet to a point on the south line of said Lot 12, said point being 80 feet west of the beginning; thence east 80 feet to the place of beginning.

do hereby dedicate the above described real estate to the public for

 Street purposes.

Executed this 29th day of Dec. 1977.

George H. Tittsworth
George H. Tittsworth

Wanda L. Tittsworth
Wanda L. Tittsworth

STATE OF KANSAS)
SEDGWICK COUNTY)^{ss}

BE IT REMEMBERED, that on this 29th day of Dec., 1977,

came George H. Tittsworth and Wanda L. Tittsworth, his wife

to me personally known to be the same persons who executed the foregoing instrument and duly acknowledged the execution of the same.

IN WITNESS WHEREOF, I have hereunto subscribed my name and affixed my official seal, the day and year last above written.

Submitted to the Wichita-Sedgwick County Metropolitan Area Planning Commission and the Board of Commissioners of the City of Wichita, Kansas, and approved by said Board of Commissioners of the City of Wichita, Kansas,

this _____,

City Clerk

Joyce C. Cornwell
Notary Public

My Commission Expires: 2/20/80

JOYCE C. CORNWELL
NOTARY PUBLIC
Sedgwick County, Kansas
My Appt. Exp. 2/20/80