

D-0874 - Plaza West Shopping Center dedicates Additional street R.O.W. for Central and for West Street at the southwest corner of Central and West.

10-15-83
K.C.
to Sec
to Sec
to Sec
10-15-83

DIP BASE

ROUTED
3-23-79
[Signature]

ACTION

S/D COMMITTEE accepted DATE 4-5-79

M.A.P.C. Approved 4-12-79

B.C.C./B.C.C. Approved 4-24-79

POST TO DRIGE
DOR BASES

POSTED
800
[Signature]
10-18-83

DEDICATION REPORT AND PROGRESS

MAP No. 5147
 SEC. No. 23
 TWP. No. 27
 RANGE 1W

CASE No. D - 0874
 Assoc. L/S-0411 & DP-4)

I. OFFER TO DEDICATE: Additional Street R.O.W.
 GENERALLY LOCATED: for Central and for West Street at the southwest corner of Central and West.

LEGALLY DESCRIBED AS:

DEDICATED BY: Plaza West Shopping Center, a Partnership
 AGENT: 46 Jack Bayouth
 ADDRESS: 1202 SW Douglas PHONE _____
 PURPOSE OF DEDICATION: Requirement of C.V.P. (DP-4 amended) and L/S-0411

II. SKETCH.

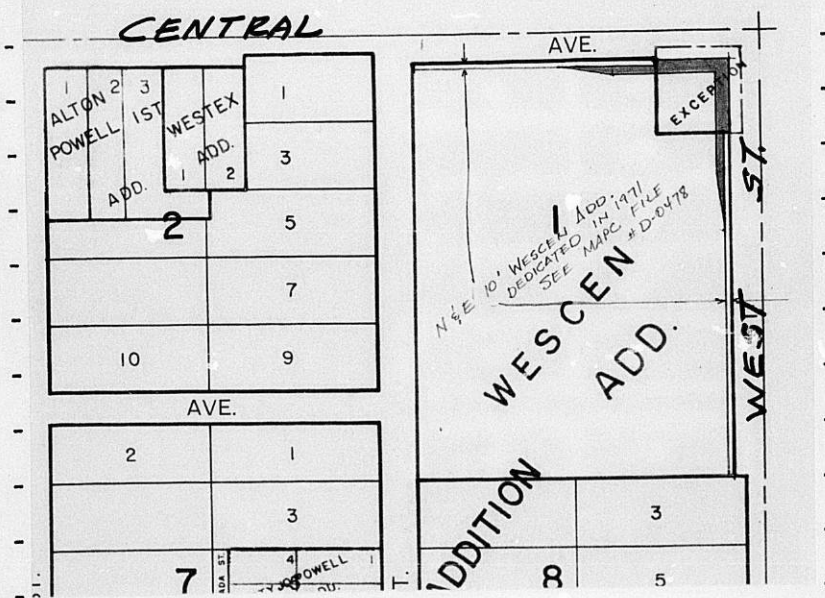

III. FILED 3-16-79
 POSTED TO ATLAS
 S/D COMM. ACTION 4-5-79 accept
 M.A.P.C. ACTION 4-12-79 Approved

B.C.C. ACTION 4-24-79 Approved
 PLACED ON RECORD _____
 CITY CLERKS No. _____

MAPC CASE NO. D-0874 Dedication of street right-of-way

Dedicated by: Plaza West Shopping Center, a partnership

Generally at the southwest corner of Central and West Street

This dedication is given for the following reason: Requirement of Community Unit Plan (DP-4) and requirement of approval of Lot Split, #L/S 0411

ACTION: Accept the dedication and instruct the City Clerk to file with the Register of Deeds.

BILL RECORDING FEE TO: Jack Bayouth, 1202 W. Douglas, Wichita, Ks. 67203

5147
23
27
16

DEDICATION

D0874
(Assoc. 4/S-0411)
+ D P-4

KNOW ALL MEN BY THESE PRESENTS:

That for and in consideration of the sum of One Dollar (\$1.00) and other good and valuable considerations, the receipt of which is hereby acknowledged,

the undersigned, Plaza West Shopping Center a Partnership

being the owner s of the following described real estate in Sedgwick County, Kansas, to wit:

Part of Lot 1, Wescen Addition and Lots 1 and 3 of Block 1, Parkwild Addition to the City of Wichita, Kansas, described as follows: Beginning at a point 50 feet west and 50 feet south of the N.E. Corner of Sec. 23, Twp. 27-S, R-1-W, being the S.W. Corner of West Street and Central Avenue, thence southerly, parallel with the east line of said Sec. 23, 125 feet; thence westerly, parallel with the north line of said Sec. 23, 10 feet; thence southerly, parallel with the east line of said Sec. 23, 175 feet; thence northwesterly 101.18 feet to a point 75 feet west and 250 feet south of the N.E. Corner of said Sec. 23; thence northerly, parallel with the east line of said Sec. 23, 175 feet; thence westerly, parallel with the north line of said Sec. 23, 175 feet; thence northwesterly 101.18 feet to a point 60 feet south and 350 feet west of the N.E. Corner of said Sec. 23; thence easterly, parallel with the north line of said Sec. 23, 175 feet; thence northerly, parallel with the east line of said Sec. 23, 10 feet; thence easterly, parallel with the north line of said Sec. 23, 125 feet to the point of beginning.

does hereby dedicate the above described real estate to the public for street purposes.

Executed this 15th day of March, 19 79.

Plaza West Shopping Center
a Partnership

Jack E. Bayouth
Jack E. Bayouth

STATE OF KANSAS)
SEDCWICK COUNTY) SS

BE IT REMEMBERED, that on this 15th day of March, 19 79, before me a Notary Public in and for the said County and State came

Jack E. Bayouth

to me personally known to be the same person who executed the foregoing instrument and duly acknowledged the execution of the same.

IN WITNESS WHEREOF, I have hereunto subscribed my name and affixed my official seal, the day and year last above written.

My Commission expires 4/19/80

Form #42-033

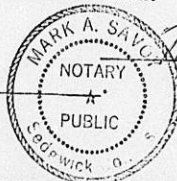

Mark A. Sawyer
Notary Public