

D-0901 - George W. Nicholson
dedicates Contingent Street on the
north side of 63rd St. South, bet.
Hydraulic and Kansas Turnpike.

POSTED
7-31-79

ACTION

DATE

COMMITTEE _____

M.A.P.C. _____

B.C.C./B-60-C. *Clyde* _____ *7-31-79*

Book 4; M-5-B

DEDICATION REPORT AND PROGRESS

MAP No. 5540
SEC. No. 28
TWP. No. 28
RANGE 1E

CASE No. D - 0901

Associated CU-217

I. OFFER TO DEDICATE: Contingent street dedication
GENERALLY LOCATED: North side of 63rd St. South, between Hydraulic
and the Kansas Turnpike

LEGALLY DESCRIBED AS: _____

DEDICATED BY: George W. Nicholson
AGENT: _____
ADDRESS: _____ PHONE _____
PURPOSE OF DEDICATION: _____

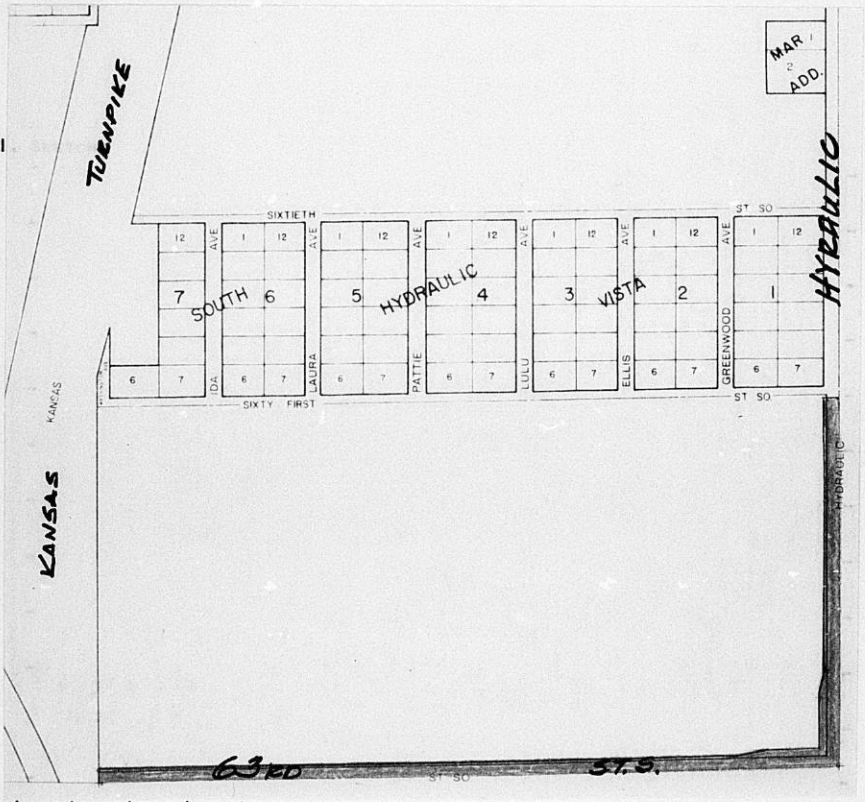

III. FILED 7-16-79
POSTED TO ATLAS _____
S/D COMM. ACTION _____
M.A.P.C. ACTION _____

B.C.C. ACTION 7-31-79 *Approved*
PLACED ON RECORD _____
CITY CLERKS No. _____

MAPC CASE NO. D-0901 Dedication of contingent street right-of-way for
Hydraulic and for 63rd Street South

Dedicated by: George W. Nicholson

Generally located at the northwest corner of Hydraulic and 63rd St. South

This dedication is given for the following reason:
Requirement of Conditional Use CU-217.

ACTION: Accept the dedication and instruct the City Clerk to
file with the Register of Deeds.

BILL RECORDING FEE TO:
Metropolitan Area Planning Department

Book 4
M-S-B
5540
28
28
16

CONTINGENT DEDICATION

WHEREAS, George W. Nicholson, is the owner of the following described real property, to wit:

The South Half of the Southeast Quarter of Section 28, Township 28 South, Range 1 East of the 6th P.M., Sedgwick County, Kansas; and D-0901
(Case CV-217)

WHEREAS, the County of Sedgwick, is requesting that a portion of said property be dedicated to the public for street right-of-way purposes;

Now, therefore, George W. Nicholson being the legal owner of the aforesaid property does dedicate to the public for street purposes, the following described property:

Beginning at the southeast corner of the Southeast Quarter of Section 28, Township 28 South, Range 1 East; thence north 1300.6 feet; thence west 50 feet; thence south 950.6 feet; thence southwesterly to a point 75 feet west and 250 feet north of the southeast corner of said southeast quarter; thence south 175 feet to a point 75 feet north and 75 feet west of the southeast corner of said southeast quarter; thence west 175 feet; thence southwesterly to a point 60 feet north and 350 feet west of the southeast corner of said southeast quarter; thence west to the west line of said southeast quarter; thence south 60 feet; thence east to the point of beginning.

N.P. 63, 950, 2 Hydraulic & 63rd Street

But the right of the public and the County of Sedgwick to use, maintain, excavate, fill, pave, or install utilities or to make similar use of said property shall not occur until such time as the right-of-way is deemed necessary for the improvement or reimpovement of Hydraulic and 63rd Street South by the County Engineer of Sedgwick County, at which time said dedication shall become effective.

It is the intent of the grantors herein that this shall be a covenant running with the land and shall be binding upon the heirs, assigns and successors and upon all subsequent owners of any part or parcel of said property covered by this dedication.

Executed at Wichita, Sedgwick County, Kansas, this 24th day of May, 19 79.

George W. Nicholson
George W. Nicholson

STATE OF KANSAS) SS
SEDGWICK COUNTY)

BE IT REMEMBERED, that on this 24th day of May, 19 79, before me a Notary Public in and for said County and State came

George W. Nicholson

to me personally known to be the same person who executed the foregoing instrument and duly acknowledged the execution of same.

IN WITNESS WHEREOF, I have hereunto subscribed my name and affixed my official seal, the day and year last above written.

Glenda M. Crites
Notary Public

My Commission expires June 24, 1982

