

D-1121 - Lyle Investments, Inc.
dedicate street ROW - generally
located on the south side of
Central, in an area west of
Hillcrest.

Posted
5-2-83

ACTION

DATE

COMMITTEE _____

M.A.P.C. _____

B.C.C./B-60-G *Amptel* *5-3-83*

D-1121
dedicat
located
Central
Hillc

DEDICATION REPORT AND PROGRESS

MAP No. 5847A
SEC. No. _____
TWP. No. _____
RANGE _____

CASE No. D - 1121

ASSOCIATED CASE NO. Z-2493

I. OFFER TO DEDICATE: Street ROW
GENERALLY LOCATED: on the south side of Central, in an area west of Hillcrest.

LEGALLY DESCRIBED AS: _____

DEDICATED BY: Lyle Investments, Inc.
AGENT: _____
ADDRESS: _____ PHONE _____
PURPOSE OF DEDICATION: _____

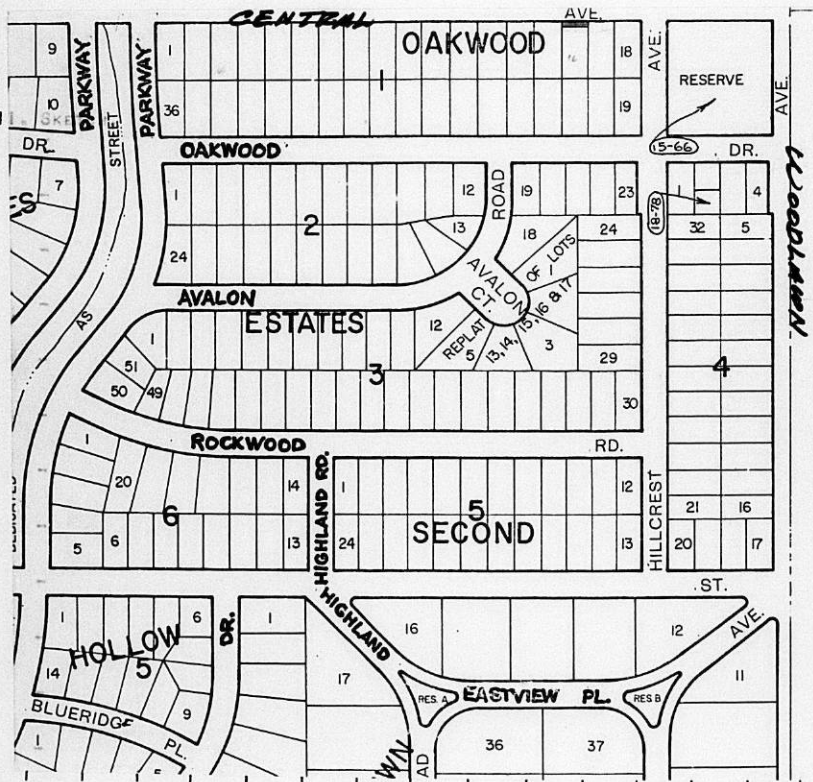

III. FILED 4-22-83 B.C.C. ACTION 5-3-83 *Ampted*
 POSTED TO ATLAS _____
 S/D COMM. ACTION _____
 M.A.P.C. ACTION _____
 PLACED ON RECORD _____
 CITY CLERKS No. _____

5847A

D E D I C A T I O N

D-1121

Acct. 2-2493

KNOW ALL MEN BY THESE PRESENTS:

That for and in consideration of the sum of One Dollar (\$1.00) and other good and valuable considerations, the receipt of which is hereby acknowledged, the undersigned, Lyle Investments, Inc.

being the owner of the following described real estate in Sedgwick County, Kansas, to wit:

North 10' of Lot 16, Block 1, Oakwood Estates Second, an Addition to Wichita, Sedgwick County, Kansas.

do es hereby dedicate the above described real estate to the public for street purposes.

Executed this 21st day of April 19 83.

Lyle Investments, Inc.

By: Jeff Lyle, President

STATE OF KANSAS)
SEDGWICK COUNTY)^{ss}

BE IT REMEMBERED, that on this 21st day of April 1983,

came Jeff Lyle, President, Lyle Investments, Inc.,

to me personally known to be the same person who executed the foregoing instrument and duly acknowledged the execution of the same.

IN WITNESS WHEREOF, I have hereunto subscribed my name and affixed my official seal, the day and year last above written.

Submitted to the Wichita-Sedgwick County Metropolitan Area Planning Commission and the Board of Commissioners of the City of Wichita, Kansas, and approved by said Board of Commissioners of the City of Wichita, Kansas,

this _____

City Clerk



Notary Public

My Commission Expires: 11-17-84

FOULSTON, SIEFKIN, POWERS & EBERHARDT

LAW OFFICES

A PARTNERSHIP INCLUDING A PROFESSIONAL ASSOCIATION

700 FOURTH FINANCIAL CENTER

BROADWAY AT DOUGLAS

WICHITA, KANSAS 67202

(316) 267-6371

COUNSEL
GEORGE E. POWERS

ROBERT C. FOULSTON (1888-1947) GEORGE SIEFKIN (1888-1984)

JOHN F. EBERHARDT
ROBERT C. FOULSTON, P. A.
ROBERT M. PARTRIDGE
ROBERT H. SIEFKIN
RICHARD C. HARRIS
SERALD SAWATSKY
ROBERT L. HOWARD
CHARLES J. WOODIN
MIRREL L. STOUT
BENJAMIN C. LANGEL
JERRY G. ELLIOTT
WILLIAM H. OYE
PHILLIP S. FRICK

STANLEY G. ANDEK
FREDERICK L. HAAG
RICHARD D. EMY
DARRELL L. WARTA
WILLIAM R. BAFFRON
HARVEY R. BOKENEN
CHRISTOPHER F. CHRISTIAN
MICHAEL KIM MOORE
JAMES M. ARMSTRONG
MARY KATHLEEN BARCOCK
CHARLES P. EFFLANDT
JAMES D. OLIVER

GARY L. AYERS
MARK S. AYERS
VAUGHN BURKHOLDER
LINDA K. CONSTABLE
TERRY C. CUFFY
NICHOLAS S. DAILY
GLORIA G. FLEETZ
JAY P. FOWLER
STEVEN J. FRANTZ
CHRISTOPHER M. HURST

STEPHEN M. KERWICK
GARY E. REISDT
RICHARD C. MORRIS
JOHN J. MURPHY
LARRY G. RAPP
R. DOUGLAS REAGAN
TERESA J. ROLL
SUSAN L. SWITS
NOLA TERESCO FOULSTON
WYATT M. WRIGHT

April 21, 1983

Mr. Jack Galbraith
Chief Planner
Metropolitan Area Planning
Commission
City Hall-Tenth Floor
455 North Main Street
Wichita, Kansas 67202

Re: Z-2493-"A" to "BB"-south side of Central
in an area west of Hillcrest

Dear Jack:

Pursuant to your letter of April 8, 1983, I am enclosing herewith the executed copies of the Partial Dedication of Abbuter's Rights and Dedication, all as provided for in your letter. These documents are executed by Lyle Investments, Inc. which corporation was one of the applicants and will become sole owner of the property when we close on May 5, 1983. Accordingly I think the documents as executed will take care of the dedications as required. Should you have any questions please let me know.

Very truly yours,

Phillip S. Frick

of FOULSTON, SIEFKIN, POWERS & EBERHARDT

PSF:klc
Enclosures
c.c. Jeff Lyle