

D-1200 - Phillip G. Ruffin dedicates partial access control at the northwest corner of West St. and Westlawn.

POSTED 4-19-84 KY

Ⓟ

ACTION

	DATE
9/6 COMMITTEE	<u>4-26-84</u>
	<u>accept</u>
M.A.P.C.	<u>5-3-84</u>
	<u>accept</u>
B.C.C./R.C.C.C.	<u>5-15-84</u>
	<u>Grant</u>

5199 A

MAP No. 5149 A
Sec. No. 11
TWP. No. 27 S
RANGE No. 1 W

DEDICATION REPORT AND PROGRESS

CASE No. D - 1200

ASSOCIATED CASE NO. L/S-0604

I. OFFER TO DEDICATE: Partial Access Control to West Street
GENERALLY LOCATED: At the northwest corner of West Street and Westlawn

LEGALLY DESCRIBED AS: _____

DEDICATED BY: Phillip G. Ruffin

ADDRESS: _____ PHONE _____

PURPOSE OF DEDICATION: _____

II. SKETCH.

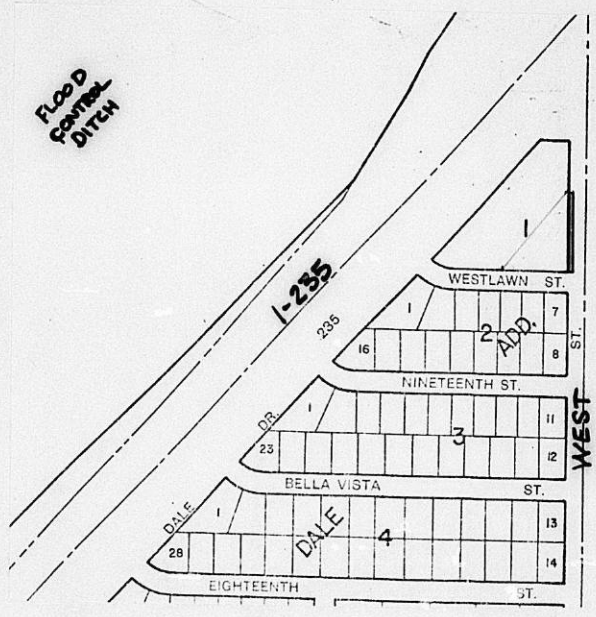

III. FILED 4-4-84
POSTED TO ATLAS _____
S/D COMM. ACTION 4-26-84 accept
M.A.P.C. ACTION 5-3-84 accept
B.C.C. ACTION 5-15-84 Accept
PLACED ON RECORD _____
CITY CLERKS No. _____

D-1200

Phillip G. Ruffin
dedicates partial access
control. Located at the
northwest corner of West
Street and Westlawn.

4/26/84 - S/O Conn.
mtg.

Assoc case - 4/5-8604

Bill Reconciliation Costs to

P.E.C. P.A.
1440 E. English

67211

MAPC CASE NO. D-1200

Dedication of partial access control
to West Street

Dedicated by: Phillip G. Ruffin

Generally located at the northwest corner of West Street and Westlawn.

This dedication is given for the following reason:
a condition of lot split approval.

ACTION: Accept the dedication and instruct the City Clerk
to file the document with the Register of Deeds.

BILL RECORDING FEE TO: Professional Engineering Consultants, P.A.
1440 E. English
Wichita, Ks. 67211

5149A
11
275
IW

PARTIAL DEDICATION OF ABUTTER'S RIGHTS

KNOW ALL MEN BY THESE PRESENTS:

That for and in consideration of the sum of One Dollar (\$1.00) and other good and valuable considerations, the receipt of which is hereby acknowledged, the undersigned Phillip G. Ruffin

_____ being the owner of the following

described real estate in Sedgwick County, Kansas, to-wit:
Beginning at the southeast corner of Block 1, West Dale Addition; thence west along the south line of Block 1, 200 ft.; thence northeasterly to a point on the east line of Block 1, 215 ft. north of the point of beginning; thence south along the east line of Block 1, 215 ft. to the point of beginning.

do hereby transfer and convey to the City of Wichita, Kansas, all abutter's rights of access, ingress and egress to said property from or to West Street over and across the

East line of the above described property; to have and to hold the same forever; provided, however, that said property shall have access to West Street

at two (2) locations. It being understood

that this conveyance is a covenant running with the land and prohibits all subsequent owners thereof and all members of the public from entering upon said property from West Street,

except at the two (2) permitted locations.

Executed this 4th day of April, 19 84.

Phillip G. Ruffin
Phillip G. Ruffin

State of Kansas) ss.
Sedgwick County)

BE IT REMEMBERED, that on this 4th day of April, 19 84, before me a notary public in and for the said County and State, came Phillip G. Ruffin to me personally known to be the same person who executed the foregoing instrument and duly acknowledged the execution of the same.

IN WITNESS WHEREOF, I have hereunto subscribed my name and affixed my official seal, the day and year last above written.

Movita R. Forrester
Notary Public

My Commission Expires:

March 23, 1987

MOVITA R. FORRESTER
NOTARY PUBLIC
STATE OF KANSAS
My Appt. Exp. 3-23-87