

Pasted 8-1-84  
NW 4447

OK PA

# ACTION

	DATE
<i>S/D</i> COMMITTEE	<u>8-2-84</u>
M.A.P.C.	<u>8-9-84</u>
B.C.C./B.C.C.	<u>9-1-84</u>

*Approved*

*Approved*

*Approved*

D-1224 - Von M. Edens, etux., grants a utility easement located on the south-easterly side of Gleneagles Drive in an area north of Prestwick.

DEDICATION REPORT AND PROGRESS

MAP No. 4947 B  
 SEC. No. 21  
 TWP. No. 27 S  
 RANGE No. 1 W

CASE No. D - 1224

ASSOCIATED CASE NO. V-1278

I. OFFER TO DEDICATE: Utility easement  
 GENERALLY LOCATED: On the southeasterly side of Gleneagles Drive between ~~Woodchil and Murfield~~ on an area north of Prestwick

LEGALLY DESCRIBED AS:

DEDICATED BY: Von M. Edens, etux.  
148 Murfield  
 ADDRESS: Wichita, Kansas 67212 PHONE 722-8905  
 PURPOSE OF DEDICATION:

II. SKETCH.

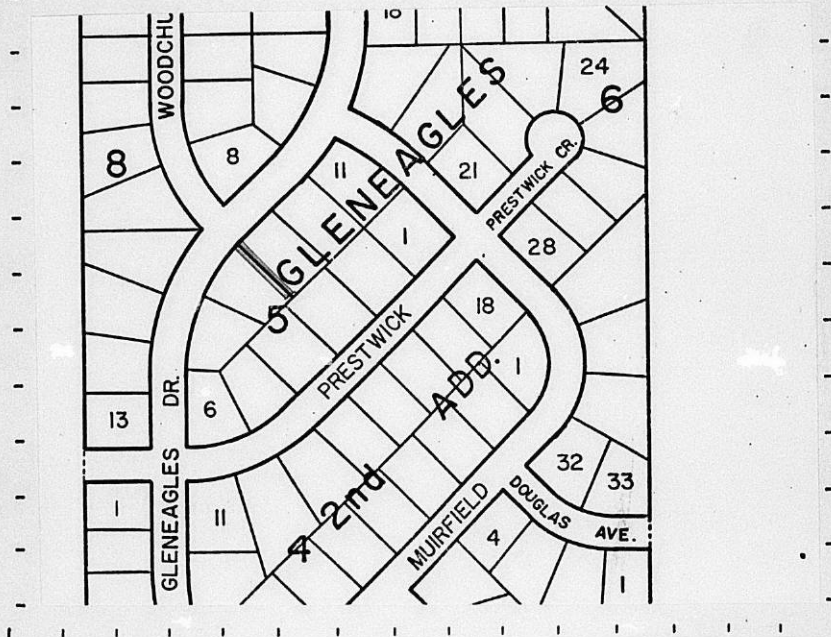

III. FILED 7-20-84  
 POSTED TO ATLAS  
 S/D COMM. ACTION 8-2-84 approved  
 M.A.P.C. ACTION 8-4-84 approved

B.C.C. ACTION 7-28-84 Approved  
 PLACED ON RECORD \_\_\_\_\_  
 CITY CLERKS No. \_\_\_\_\_

MAPC CASE NO. D-1224

Dedication of a utility ease-  
ment

Dedicated by: Von M. Edens

Generally located on the southeasterly side of Gleneagles Drive in an area north of Prestwick.

This dedication is given for the following reason: condition of approval of a vacation request (V-1278).

**ACTION:** Accept the dedication and instruct the City Clerk to file the document with the Register of Deeds.

**BILL RECORDING FEE TO:** Von M. Edens  
148 Murifield  
Wichita, Kansas 67211

4947 B

21  
275  
1W

EASEMENT

D-1224

THIS EASEMENT made this 20<sup>th</sup> day of July

1941, by and between \_\_\_\_\_ the undersigned owners

of the first part and the City of Wichita, of the second part.

WITNESSETH: That the said first party, in consideration of the sum of One Dollar (\$1.00) and other valuable consideration, the receipt whereof is hereby acknowledged, does hereby grant and convey unto the said second party a perpetual right-of-way and easement for the purpose of constructing, maintaining, and repairing sewer and all other public utilities, over, along and under the following described real estate situated in Sedgwick County, Kansas, to wit:

Part of Lots 8 and 9, described as follows: Being a strip of land 10 feet wide, lying 5 feet either side of the following described line: Beginning at the front corner common to said lots 8 and 9; thence southeasterly to a point on the rear line of said lot 9, said point being 5.7 feet northeasterly of the rear corner common to said Lots 8 and 9, all in Block 5, Gleneagles 2nd Addition, Wichita, Kansas.

And said second party is hereby granted the right to enter upon said premises at any time for the purpose of constructing, operating, maintaining, and repairing such sewer and all other public utilities.

IN WITNESS WHEREOF: The said first party has signed these presents the day and year first written.

Von M. Edens  
Von M. Edens  
Audrey L. Edens  
Audrey L. Edens

STATE OF KANSAS)  
SEDGWICK COUNTY) SS

Blue Mountain Company Darry Brown  
Darry Brown, Vice-President

Be it remembered that on this 20<sup>th</sup> day of July, 1941, before me, a notary public in and for said County and State, came Von M. Edens & Audrey L. Edens his wife, and Darry Brown vice-President of Blue Mountain Company

to me personally known to be the same person(s) who executed the foregoing instrument of writing and duly acknowledged the execution of same. In testimony whereof I have hereunto set my hand and affixed my notarial seal the day and year above written.

SEAL

C. Crossley  
Notary Public

C. CROSSLEY  
Notary Public  
State of Kansas  
My Assn. Exp. 2/28/55

My Commission expires: \_\_\_\_\_

Dedication:

Assoc. with GLENFAGLES  
VAC. CASE. V-1218

Von M. Edens, ETUX,  
grants a utility easement,  
located on the southeasterly  
side of Glenfagles Drive  
between Prestwick & Murfield.

4947 B

21

275

1W

D-1204

For. 8/2/84 S/D