

ACTION

DATE

COMMITTEE _____

M.A.P.C. _____

B.C.C. ~~B.C.C.~~ *Ampt* _____ 10-9-84

D-1243 (Assoc. Z-2632) Robert W. Moore grants the east two feet of Lot 27, Dieter's Addn. on the east side of Main and the west side of Market between Kellogg and Orme.

M.A.P.C.

~~B.C.C.A.C.C.~~

Ampt

10-9-84

D-1243 (Assoc. Z-2632) Robert W. Moore grants the east two feet of Lot 27, Dieter's Addn. on the east side of Main and the west side of Market between Kellogg and Orme.

MAP No. 5446 A
 SEC. No. _____
 TWP. No. _____
 RANGE _____

DEDICATION REPORT AND PROGRESS

CASE No. D - 1243

ASSOCIATED CASE NO. Z-2632

- I. OFFER TO DEDICATE: The east two feet of Lot 27, Dieter's Addition
 GENERALLY LOCATED: On the east side of Main and the west side of Market
in an area between Orme and Kellogg.

LEGALLY DESCRIBED AS: _____

DEDICATED BY: Robert W. Moore
 AGENT: Everett C. Pettis
 ADDRESS: 120 S. Market, Suite 504, 67202 PHONE 267-7251
 PURPOSE OF DEDICATION: For Alley Purposes

II. SKETCH.

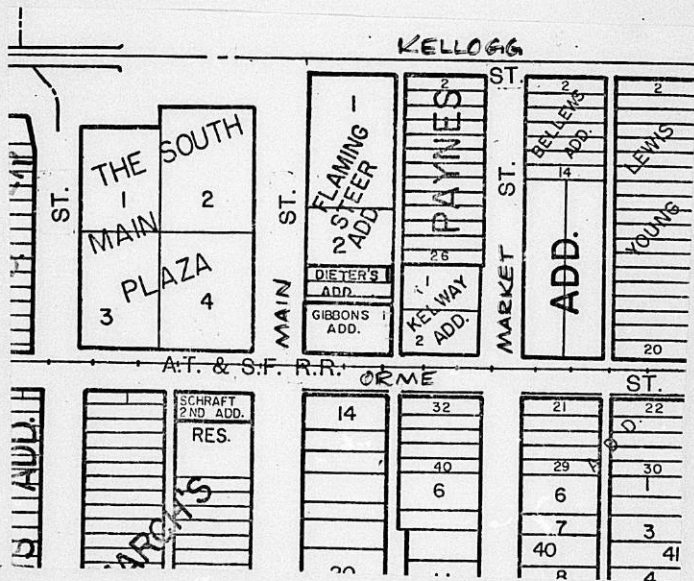

FILED 9-19-84
 POSTED TO ATLAS _____
 S/D COMM. ACTION _____
 M.A.P.C. ACTION _____

B.C.C. ACTION 10-9-84 *Accepted*
 PLACED ON RECORD _____
 CITY CLERKS No. _____

DEDICATION

KNOW ALL MEN BY THESE PRESENTS:

That for and in consideration of the sum of One Dollar (\$1.00) and other good and valuable considerations, the receipt of which is hereby acknowledged, the undersigned, Robert W. Moore

being the owner of the following described real estate in Sedgwick County, Kansas, to wit:

The east two feet of Lot 27, Dieter's Addition to the City of Wichita, Kansas.

do I hereby dedicate the above described real estate to the public for Alley purposes.

Executed this 12th day of September 19 84.

Robert W. Moore
Robert W. Moore

STATE OF KANSAS)
SEDGWICK COUNTY) ss

BE IT REMEMBERED, that on this 12th day of September, 1984,
came Robert W. Moore

to me personally known to be the same person who executed the foregoing instrument and duly acknowledged the execution of the same.

IN WITNESS WHEREOF, I have hereunto subscribed my name and affixed my official seal, the day and year last above written.

Submitted to the Wichita-Sedgwick County Metropolitan Area Planning Commission and the Board of Commissioners of the City of Wichita, Kansas, and approved by said Board of Commissioners of the City of Wichita, Kansas,
this _____,

City Clerk

Mary Michele Jonas
Notary Public

My Commission Expires: 9-29-87

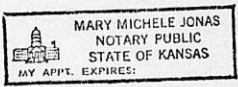

LAW OFFICES
FETTIS & MCCLURE
120 SOUTH MARKET
SUITE 504
WICHITA, KANSAS 67202
316-267-7251

D-1243

EVERETT C. FETTIS
DAVID R. MCCLURE

KEITH M. CURFMAN
OF COUNSEL

September 14, 1984

Jack H. Galbraith, Chief Planner
Metropolitan Area Planning Department
455 North Main
Wichita, Kansas 67203

RE: Z-2632 - "B" & "LC" to "C"

Dear Jack:

Pursuant to your letter to me of September 7, 1984 regarding the captioned zoning matter, we are herewith returning the Dedication you sent us which has been signed by Robert W. Moore and notarized. I believe this is all you need in order to schedule this matter for consideration by the Board of City Commissioners at their regular meeting on October 9, 1984.

Please contact me if there are any questions.

Very truly yours,

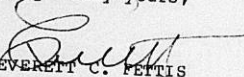
EVERETT C. FETTIS

ECF/dbs
enc

RECEIVED

SEP 18 1984

METROPOLITAN PLANNING
ROUTE _____
