

POSTED 10-22-84 KX
AS

ACTION

COMMITTEE	ACTION	DATE
96	approved	10-25-84
M.A.P.C.	approved	11-1-84
B.C.C./B.-G.O.-C.	approved	11-13-84

closed

D-1254 - Keith L. Anderson grants a utility easement at the north-west corner of Rock Rd. and Greenbriar Circle.

DEDICATION REPORT AND PROGRESS

MAP No. 5950 A
SEC. No. 6
TWP. No. 27 S
RANGE 2 E

CASE No. D - 1254

ASSOCIATED CASE NO. _____

1. OFFER TO DEDICATE: Utility Easement
GENERALLY LOCATED: At the northwest corner of Rock Road
and Greenbriar Circle

LEGALLY DESCRIBED AS: _____

DEDICATED BY: Keith L. Anderson

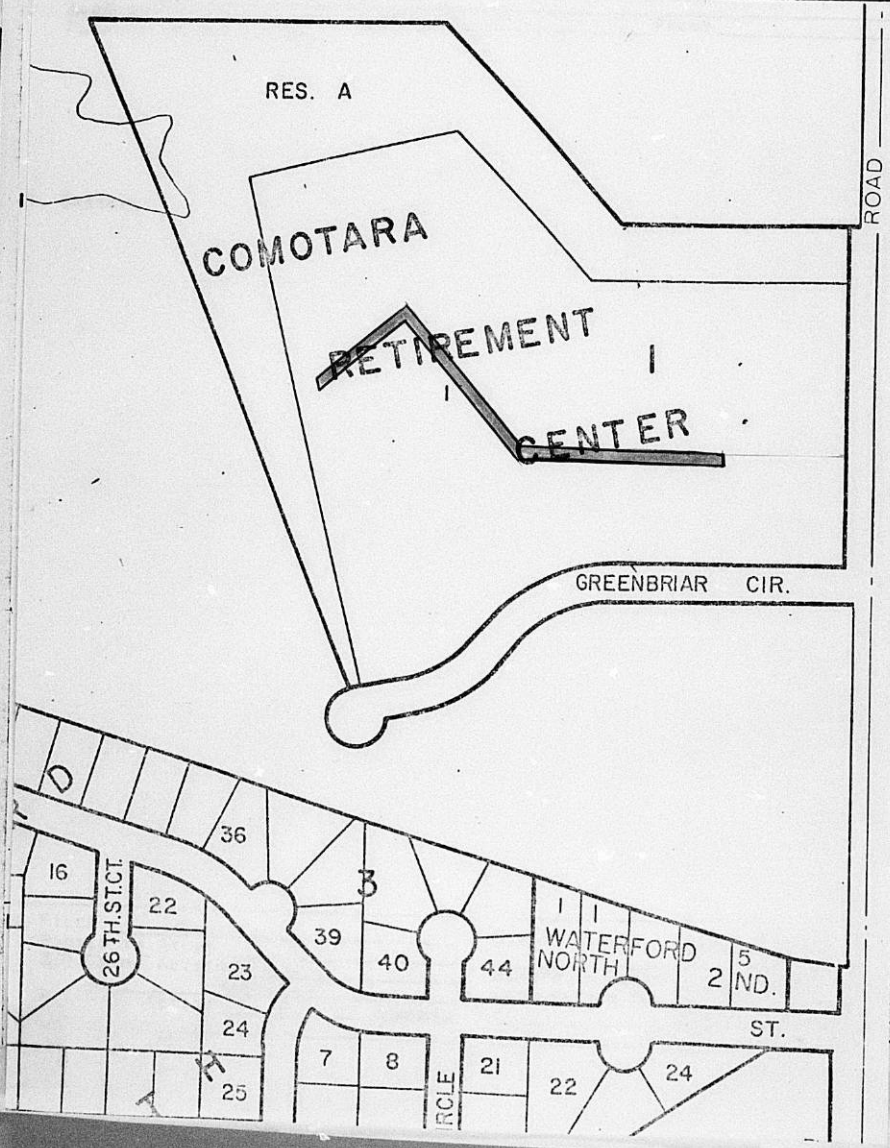

MAPC CASE NO. D-1254

Dedication of utility easement.

Dedicated by: Keith L. Anderson

Generally located at the northwest corner of Rock Road and Greenbriar Circle.

This dedication is given for the following reason:

City project.

ACTION: Accept the dedication and instruct the City Clerk to file the document with the Register of Deeds.

BILL RECORDING FEE TO:

Lat. 32, Main 7, SS #23
468-81381-001

5950A
6
27S
2E

468-81381-001
D-1254

EASEMENT

THIS EASEMENT made this 12th day of October, 1984.
by and between Keith L. Anderson of the first
part and City of Wichita, Kansas of the second
part.

WITNESSETH; that the said first party, in consideration of the sum of One Dollar (\$1.00) and other valuable consideration, the receipt whereof is hereby acknowledged, do hereby grant and convey unto the said second party a perpetual right of way and easement for the purpose of constructing, maintaining and repairing their Utilities, over, along and under the following described real estate situated in Sedgwick County, Kansas, to wit:

Commencing at the northeast corner of Lot 1, block 1, "Comotara Retirement Center Addition", an addition to Wichita, Sedgwick County, Kansas; thence S 0° 54' 22" E, 303.20 feet along the east line of said addition; thence S 89° 05' 38" W, 210.00 feet to the point of beginning; thence S 0° 54' 22" E, 20.00 feet; thence S 89° 05' 38" W, 369.78 feet; thence N 39° 49' 50" W, 316.79 feet; thence S 62° 10' 28" W, 191.72 feet to a point on the easterly line of an utility easement as platted in said addition; thence N 14° 37' 52" W, 16.43 feet along the easterly line of said easement; thence N 62° 10' 28" E, 205.02 feet; thence S 39° 49' 50" E, 319.33 feet; thence N 89° 05' 38" E, 360.22 feet to the point of beginning.

*Keith Anderson grants a utility easement.
Generally at the northwest corner of Rock Rd. and
Greenbriar Circle.*

for 10/25/84 5/10 mtg.
And said second party is hereby granted the right to enter upon said premises at any time for the purpose of constructing, operating, maintaining and repairing their Utilities.

IN WITNESS WHEREOF: The said first party has signed these presents the day and year first written.

*Bill recording to:
Lat. 32, Main 7, SS #23
468-81381-001*

Keith L. Anderson
Keith L. Anderson

STATE OF KANSAS
ss:
SEDGWICK COUNTY

Personally appeared before me a notary public in and for the County and State aforesaid came Keith L. Anderson to me personally known to be the same person who executed the foregoing instrument of writing and said person duly acknowledged the execution thereof.

Dated at Wichita this 12th day of October, 1984.

Joyce L. Kaufman
Notary Public Joyce L. Kaufman

My Appointment Expires: June 8, 1988

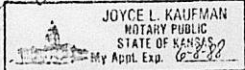

THE CITY OF WICHITA

OFFICE OF MAPD - Design Division

DATE October 16, 1984

TO Forrest Nagley, Senior Planner
FROM Larry D. Henry, Program Development Engineer

SUBJECT Lateral 32, Main 7,
Sanitary Sewer #23
468 76 245 81381 000 000 001

Attached is an easement received in connection with the subject project. Please place the attached easement on the agenda for Subdivision Committee consideration. Upon approval by the City Commission, I would appreciate a copy of the recorded instrument for our file.

Larry D. Henry
Larry D. Henry, P.E.
Program Development Engineer

JLL:ms
/02/12
Attachment

RECEIVED

OCT 16 1984

METROPOLITAN PLANNING

ROUTE _____
