

ACTION

COMMITTEE	<small>DATE</small>
<u>approved</u>	<u>9-12-85</u>
<u>approved</u>	<u>9-19-85</u>
<u>B.C.C./B. CO. C. <i>Approved</i></u>	<u>10/0/85</u>

AK18

D-1319 - Inland Investment Co., Inc.
dedicates street right-of-way located
west of Maize in an area north of Maple.

POSTED 8-29-85 KX

9/12/85

ACTION

COMMITTEE	<u>approved</u>	<small>DATE</small> <u>9-12-85</u>
M.A.P.C.	<u>approved</u>	<u>9-19-85</u>
B.C.C./B.C.C.C.	<u>Approved</u>	<u>10/9/85</u>

KX/KB

DEDICATION REPORT AND PROGRESS

MAP NO. 4747 B
 SEC. NO. 19
 TWP. NO. 27S
 RANGE 1W

CASE NO.: D-1319

ASSOCIATED CASE: _____

1. OFFER TO DEDICATE: Street right of way.
 GENERALLY LOCATED: West of Maize in an area north of Maple.

LEGALLY DESCRIBED AS:

Beginning at the southwest corner of Lot 1, Block 9, Oak Cliff Estates 3rd Addition; thence east a distance of 70 feet to the southeast corner of said Lot 1; thence northeasterly along the south line of Reserve "G" in said Addition, a distance of 57.31 feet; thence southwesterly to a point on the east line of said Lot 1, 11.5 feet north of the southeast corner of said Lot 1; thence southwesterly to the point of beginning.

DEDICATED BY: Inland Investment Co., Inc.

ADDRESS: _____ PHONE _____

PURPOSE OF DEDICATION: _____

Connected with City street improvement project No. 472 76 245 81433 000 000 001.

II. SKETCH.

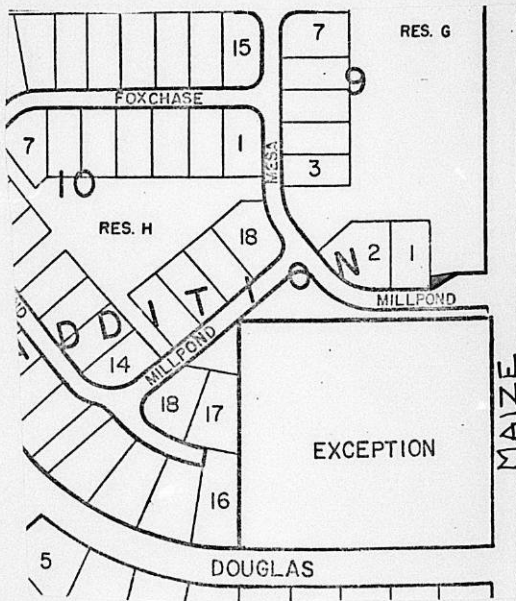

III. FILED 823/85
 POSTED TO ATLAS _____
 S/D COMM. ACTION 9/12/85 *approved*
 M.A.P.C. ACTION 9-19-85 *approved*

B.C.C. ACTION 10-8-85 *Approved*
 PLACED ON RECORD _____
 CITY CLERKS NO. _____

PLANNING AGENDA

Date: October 8, 1985

MAPC CASE NO.: D-1319

Dedication of street right of way.

Dedicated by: Inland Investment Co., Inc.

Generally located: West of Maize in an area north of Maple.

This dedication is given for the following reason:

Connected with City street improvement project.

ACTION: Accept the dedication and instruct the City Clerk to file the document with the Register of Deeds.

BILL RECORDING FEE TO:

472 76 245 81433 000 000 001

C/U: 1386/M

472-76-245-81433-000-001

DEDICATION

KNOW ALL MEN BY THESE PRESENTS:

That for and in consideration of the sum of One Dollar (\$1.00) and other good and valuable considerations, the receipt of which is hereby acknowledged, the undersigned, Inland Investment Co., Inc.

being the owner of the following described real estate in Sedgwick County, Kansas, to wit:

BEGINNING AT THE SOUTHWEST CORNER OF LOT 1, BLOCK 9, OAK CLIFF ESTATES 3RD ADDITION; THENCE EAST A DISTANCE OF 70' TO THE SOUTHEAST CORNER OF SAID LOT 1; THENCE NORTHEASTERLY ALONG THE SOUTH LINE OF RESERVE "G" IN SAID ADDITION, A DISTANCE OF 57.31'; THENCE SOUTHWESTERLY TO A POINT ON THE EAST LINE OF SAID LOT 1, 11.5' NORTH OF THE SOUTHEAST CORNER OF SAID LOT 1; THENCE SOUTHWESTERLY TO THE POINT OF BEGINNING.

do es hereby dedicate the above described real estate to the public for STREET purposes.

Executed this 15th day of July 19 85.

Inland Investment Co., Inc.

by: Larry A. Chambers
Larry A. Chambers, President

STATE OF KANSAS)
SEDGWICK COUNTY) ss

BE IT REMEMBERED, that on this 15th day of July, 1985,

came Larry A. Chambers, President of Inland Investment Co., Inc.

to me personally known to be the same person who executed the foregoing instrument and duly acknowledged the execution of the same.

IN WITNESS WHEREOF, I have hereunto subscribed my name and affixed my official seal, the day and year last above written.

Submitted to the Wichita-Sedgwick County Metropolitan Area Planning Commission and the Board of Commissioners of the City of Wichita, Kansas, and approved by said Board of Commissioners of the City of Wichita, Kansas,

this _____

City Clerk

Jane E. Mossman
Notary Public
Jane E. Mossman

My Commission Expires: 20 Feb. 1988



THE CITY OF WICHITA

OFFICE OF MAPD - Design Division

DATE August 22, 1985

TO Forrest Nagley, Senior Planner

FROM Larry D. Henry, Program Development Engineer

SUBJECT Streets in Oak Cliff Estates 3rd Addition
472 76 245 81433 000 000 001

Attached is a street dedication received in connection with the subject project. Please place the attached dedication on the agenda for Subdivision Committee consideration. Upon approval by the City Commission, I would appreciate a copy of the recorded instrument for our file.

Larry D. Henry by *JLL*
Larry D. Henry, P.E.
Program Development Engineer

/JLL:ms
Attachment

RECEIVED

AUG 23 1985

METROPOLITAN PLANNING

ROUTE

4747 B

19

275

1w

Inland Investment Co., Inc.
dedicate Street r.o.w.
located west of Klaise
in an area north of
Maple

D-1319
(3)

Bill recording costs to:
472 76 245 81433 000 000 000

For S/O 9-12-85