

D-1368 - Elmo & Mabel Mauck grant a por-  
tion of utility easement, located on the  
west side of Joann, in an area north of  
Central.

POSTED 5/28/86  
120  
5/28/86

5/28/86

ACTION

	DATE
S/D COMMITTEE	5/8/86
APPROVED	5/15/86
APPROVED	5/27/86

DEDICATION REPORT AND PROGRESS

MAP NO. 5248 C  
SEC. NO. 31  
TWP. NO. 27S  
RANGE 1W

CASE NO.: D-1368

ASSOCIATED CASE: L/S-0670

1. OFFER TO DEDICATE: A portion of utility easement.  
GENERALLY LOCATED: On the west side of Joann, in an area north of Central.  
LEGALLY DESCRIBED AS:  
The south 15 feet of the east 11 feet of the west half of Lot 19, West Ridge Acres Addition, Sedgwick County, Kansas.  
DEDICATED BY: Elmo & Mabel Mauck  
PURPOSE OF DEDICATION:  
In connection with L/S-0670.

II. SKETCH.

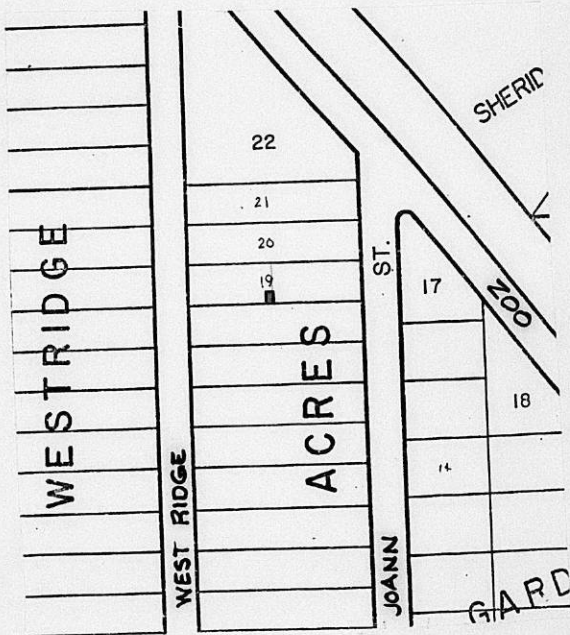

III. FILED 4/25/86  
POSTED TO ATLAS  
S/D COMM. ACTION 5/8/86 *approved*  
M.A.P.C. ACTION 5/15/86 *approved*

B.C.C. ACTION 5/27/86 *Approved*  
PLACED ON RECORD  
CITY CLERK'S NO.

Planning Agenda Item # \_\_\_\_\_

City of Wichita  
City Commission Meeting  
May 27, 1986

Agenda Report # \_\_\_\_\_

TO: Mayor and City Commissioners

SUBJECT: D-1368 - DEDICATION OF A PORTION OF UTILITY EASEMENT,  
LOCATED ON THE WEST SIDE OF JOANN, IN AN AREA NORTH  
OF CENTRAL.

INITIATED BY: Metropolitan Area Planning Department

AGENDA ACTION: Planning

-----  
MAPC Recommendation: Accept the dedication.

Background: Elmo & Mabel Mauck are dedicating this portion of utility easement to satisfy a condition of lot split approval (L/S-0670).

Financial Considerations: Bill the recording costs to:

Joseph Tinsley  
1746 Woodland  
Wichita, KS 67203

Recommendations/Actions: Accept the dedication and record document.

2844/M

EASEMENT

THIS EASEMENT made this 14th day of April,  
1986, by and between Elmo B. Mauck and Mabel Mauck  
of the first part and the City of Wichita, of the second part.

WITNESSETH: That the said first party, in consideration of the sum of One Dollar (\$1.00) and other valuable consideration, the receipt whereof is hereby acknowledged, does hereby grant and convey unto the said second party a perpetual right-of-way and easement for the purpose of constructing, maintaining, and repairing sewer and all other public utilities, over, along and under the following described real estate situated in Sedgwick County, Kansas, to wit:

The South 15 feet of the East 11 feet of the West Half of Lot 19, West Ridge Acres Addition, Sedgwick County, Kansas.

And said second party is hereby granted the right to enter upon said premises at any time for the purpose of constructing, operating, maintaining, and repairing such sewer and all other public utilities.

IN WITNESS WHEREOF: The said first party has signed these presents the day and year first written.

Elmo B. Mauck  
ELMO B. MAUCK  
Mabel Mauck  
MABEL MAUCK

STATE OF KANSAS)  
SEDGWICK COUNTY) SS

Be it remembered that on this 14th day of April, 1986, before me, a notary public in and for said County and State, came Elmo B. Mauck and Mabel Mauck to me personally known to be the same person(s) who executed the foregoing instrument of writing and duly acknowledged the execution of same. In testimony whereof I have hereunto set my hand and affixed my notarial seal the day and year above written.



John A. Deall  
Notary Public

My Commission expires: April 14 1986

5248C

31

27S

1W

assoc.

Case:

4S-0670

Elmo and Mabel  
Mauck grant  
a portion of  
utility easement  
generally located  
on the west  
side of Joann in  
an area north  
of Central.

Bill recording costs  
to: Joseph Tinsley  
1746 Woodland  
67203

For 5-8-86