

D-1376 - Board of Park Commissioners
dedicate a street easement at Memory
Lane, in an area east of Smith.

Smith
Smith

POSTED 5-16-86
KX
#10

ACTION

	COMMITTEE	DATE
S/D	approved	5/24/86
M.A.P.C.	approved	5/27/86
B.C.C./B.C.C.	Approved	6/10/86

D-1376 -
dedicate
Lane, in

DEDICATION REPORT AND PROGRESS

MAP NO. 5148 D
 SEC. NO. 14
 TWP. NO. 27S
 RANGE 1W

CASE NO.: D-1376

ASSOCIATED CASE:

I. OFFER TO DEDICATE: Street easement.

GENERALLY LOCATED: At Memory Lane, in an area east of Smith.

LEGALLY DESCRIBED AS:

That part of Lot 29, R.A. Morris Tracts, Sedgwick County, Kansas, described as the south 5 feet of the north 35 feet of said Lot 29, except therefrom those portions previously dedicated for street right-of-way.

DEDICATED BY: Board of Park Commissioners

PURPOSE OF DEDICATION:

Additional street right-of-way.

II. SKETCH.

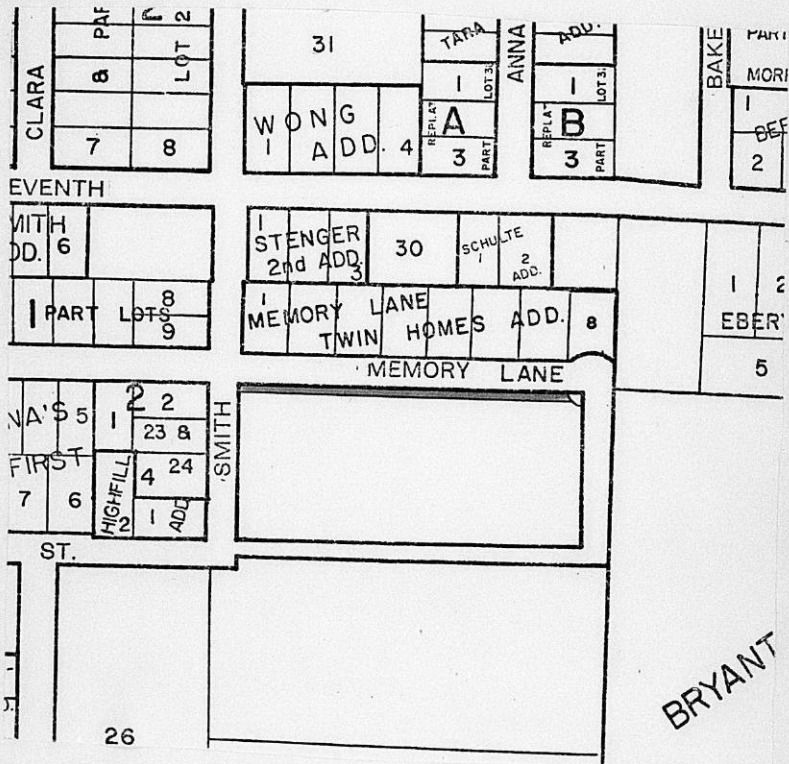

III. FILED 5/5/86
 POSTED TO ATLAS
 S/D COMM. ACTION 5/22/86 *approved*
 M.A.P.C. ACTION 5/29/86 *approved*

B.C.C. ACTION 6-10-86 *Approved*
 PLACED ON RECORD _____
 CITY CLERKS NO. _____

Planning Agenda Item # _____

City of Wichita
City Commission Meeting
June 10, 1986

Agenda Report # _____

TO: Mayor and City Commissioners

SUBJECT: D-1376 - DEDICATION OF STREET EASEMENT, LOCATED AT
MEMORY LANE, IN AN AREA EAST OF SMITH.

INITIATED BY: Metropolitan Area Planning Department

AGENDA ACTION: Planning

MAPC Recommendation: Accept the dedication.

Background: The Board of Park Commissioners is dedicating this street easement for additional street right-of-way.

Financial Considerations: Bill the recording costs to:

Baughman Company, P.A.
330 Laura
Wichita, KS 67211

Recommendations/Actions: Accept the dedication and record document.

5148 D

14

275

1W

Board of Park Commissioners
dedicate a street easement,
generally located at Memory
Lane in an area east of
Smith.

D-1376

For 5/22/86 SID
Comm. meeting

Bill recording costs to:

Baughman Company P.A.
330 Laura 67211

5148 D
14
275
IW

STREET EASEMENT

THIS EASEMENT made this 28th day of April, 1986,
by and between The Board of Park Commissioners of the first part
and the City of Wichita on the second part.

WITNESSETH: That the said party, in consideration of the sum of One Dollar (\$1.00) and other valuable consideration, the receipt whereof is hereby acknowledged, do hereby grant and convey unto the said second party a perpetual right-of-way and easement for the purpose of constructing, maintaining, and repairing street over, along and under the following described real estate situated in Sedgwick County, Kansas; to wit:

That part of Lot 29, R. A. Morris Tracts, Sedgwick County, Kansas, described as the south five feet (5') of the north 35 feet of said Lot 29, except therefrom those portions previously dedicated for street right-of-way.

And said second party is hereby granted the right to enter upon said premises at any time for the purpose of constructing, operating, maintaining, and repairing such street.

IN WITNESS WHEREOF: The said first party, has signed these presents the day and year first written.

ATTEST:

Luella Busby
Park Board Clerk

Alfred F. Angulo
Alfred F. Angulo, President
Board of Park Commissioners

STATE OF KANSAS)
SEDGWICK COUNTY) SS

Personally appeared before me, a notary public, in and for the County and State aforesaid Alfred F. Angulo

to me personally known to be the same person who executed the foregoing instrument of writing and said person duly acknowledged the execution thereof.

Dated at Wichita, Kansas, this 28th day of April, 1986.

Donna M. Middleton
Notary Public

My Commission Expires November 3, 1987



FROM

Cain

DATE

4-29-86

ADMINISTRATION	ADVANCE PLANS	CURRENT PLANS	ENGINEERING	GRAPHICS
<input type="checkbox"/> Lakin	<input type="checkbox"/> Stockwell	<input type="checkbox"/> Galbraith	<input type="checkbox"/> Lindebak	<input type="checkbox"/> Pierce
<input type="checkbox"/> Walter	<input type="checkbox"/> Schwartz	<input type="checkbox"/> Lytle	<input type="checkbox"/> Cain	<input type="checkbox"/> Commer
<input type="checkbox"/> Doramus	<input type="checkbox"/> Leivo	<input type="checkbox"/> Young	<input type="checkbox"/> Ruiz	<input type="checkbox"/> Crook
<input type="checkbox"/> Eubanks	<input type="checkbox"/> Bechtel	<input type="checkbox"/> Chambers	<input type="checkbox"/> Henry	<input type="checkbox"/> Jones
<input type="checkbox"/> Hanson	<input type="checkbox"/> Clark	<input type="checkbox"/> Daniels	<input type="checkbox"/> Schneider	<input type="checkbox"/> Whitney
<input type="checkbox"/> Henderson	<input type="checkbox"/> Dudark	<input type="checkbox"/> Lahey	<input type="checkbox"/> _____	
<input type="checkbox"/> _____	<input type="checkbox"/> Hart	<input checked="" type="checkbox"/> Nagley	<input type="checkbox"/> _____	
<input type="checkbox"/> Scott	<input type="checkbox"/> Kelley	<input type="checkbox"/> Olivarez	<input type="checkbox"/> _____	
	<input type="checkbox"/> Losew	<input type="checkbox"/> Shirkey	<input type="checkbox"/> _____	
	<input type="checkbox"/> Shen			
	<input type="checkbox"/> Vinson			

- Note & Return
- Handle
- All Staff
- Comment
- Signature
- Library
- Information
- Files
- Type

REMARKS _____

T9-105

THE CITY OF WICHITA
OFFICE OF Park Board

DATE April 28, 1986

TO Tim Cain, Administrative Supervisor
FROM Frank E. Smith, Director

SUBJECT Street Easement - 5' Strip
North Boundary Orchard Park
RE: Memory Lane Twin Homes Addition

Attached is a Street Eastment which was approved by the Board of Park Commissioners at its meeting this date.

The Easement provides a 5' strip of land from the north boundary of Orchard Park for the purpose of additional street right-of-way.



Frank E. Smith, Director
Board of Park Commissioners

FES/lrb
Att:

