

D-1425 - Larry and Valerie Spikes grants a utility easement located in an area north of Central and west of Gatewood.

POSTED 1-23-87  
128

# ACTION

	DATE
S/D COMMITTEE	<u>1/29/87</u>
M.A.P.C.	<u>2-5-87</u>
R.C.C./B.C.C.	<u>3-3-87</u>

approved

approved

Approved

DEDICATION REPORT AND PROGRESS

MAP NO. 6048 B  
 SEC. NO. 17  
 TWP. NO. 27S  
 RANGE 2E

CASE NO.: D-1425

ASSOCIATED CASE:

1. OFFER TO DEDICATE: Utility easement.

GENERALLY LOCATED: In an area north of Central and west of Gateway.

LEGALLY DESCRIBED AS:

A tract of land lying in the Southeast Quarter of Section 17, Township 27 South, Range 2 East of the 6th P.M., more particularly described as:

The east 5.00 feet of the west 25.00 feet and the south 5.00 feet of the north 25.00 feet of Lot 1, Block 1, Woodland Estates, an addition to Wichita, Sedgwick County, Kansas, said tract lying adjacent to the 20.00 foot utility easement as platted in said lot.

DEDICATED BY: Larry and Valerie Spikes

PURPOSE OF DEDICATION:

II. SKETCH.

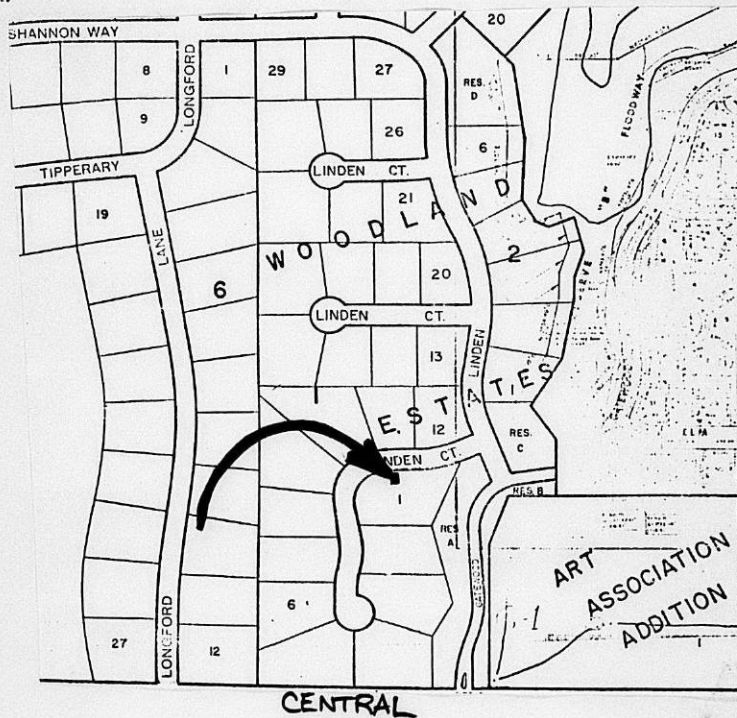

III. FILED 12/23/86  
 POSTED TO ATLAS \_\_\_\_\_  
 S/D COMM. ACTION 1/29/87 approved  
 M.A.P.C. ACTION 2-5-87 approved

B.C.C. ACTION 3-3-87 Approved  
 PLACED ON RECORD \_\_\_\_\_  
 CITY CLERKS NO. \_\_\_\_\_

Planning Agenda Item # \_\_\_\_\_

City of Wichita  
City Commission Meeting  
March 3, 1987

Agenda Report # \_\_\_\_\_

TO: Mayor and City Commissioners

SUBJECT: D-1425 - DEDICATION OF ADDITIONAL UTILITY EASEMENT, LOCATED  
IN AN AREA NORTH OF CENTRAL, WEST OF GATEWOOD.

INITIATED BY: Metropolitan Area Planning Department

AGENDA ACTION: Planning

-----  
MAPC Recommendation: Accept the dedication.

Background: Larry Spikes is dedicating this additional utility easement for a sanitary sewer project.

Financial Considerations: Bill the recording costs to:  
468-76-245-81604-000-000-001

Recommendations/Actions: Accept the dedication and record document.

PL/6206/5

Lot 2, Block 1, Woodland Estates  
8-76-225-8160E-000-000-001

EASEMENT

D-1425

THIS EASEMENT made this 23<sup>rd</sup> day of DECEMBER, 1986, by and between Larry B. and Valerie B. Spikes, of the first part and the City of Wichita, of the second part.

WITNESSETH: that the said first party, in consideration of the sum of One Dollar (\$1.00) and other valuable consideration, the receipt whereof is hereby acknowledged, do hereby grant and convey unto the said second party a perpetual right of way and easement for the purpose of constructing, maintaining and repairing their public utilities over, along and under the following described real estate situated in Sedgwick County, Kansas, to wit:

A tract of land lying in the Southeast Quarter of Section 17, Township 27 South, Range 2 East of the 6th P.M., more particularly described as:

The East 5.00 feet of the West 25.00 feet and the South 5.00 feet of the North 25.00 feet of Lot 1, Block 1, Woodland Estates, an addition to Wichita, Sedgwick County, Kansas, said tract lying adjacent to the 20.00 foot utility easement as platted in said lot.

And said second party is hereby granted the right to enter upon said premises at any time for the purpose of constructing, operating, maintaining and repairing their public utilities.

IN WITNESS WHEREOF: The said first party has signed these presents the day and year first written.

By: Larry B. Spikes  
Larry B. Spikes

By: Valerie B. Spikes  
Valerie B. Spikes

STATE OF KANSAS  
ss:  
SEDGWICK COUNTY

Personally appeared before me a notary public in and for the County and State aforesaid came Larry B. and Valerie B. Spikes, to me personally known to be the same person who executed the foregoing instrument of writing and said person duly acknowledged the execution thereof.

Dated at Wichita this 23<sup>rd</sup> day of December, 1986.

Debra J. Wilmore  
Notary Public  
Debra J. Wilmore

My Appointment Expires: 7-19-89

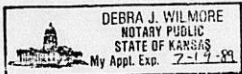

**THE CITY OF WICHITA**

**OFFICE OF** MAPD - Design Division

**DATE** January 5, 1987

**TO** Forrest Nagley, Senior Planner

**FROM** Mike Lindebak, City Engineer *ML*

**SUBJECT** Lateral 2, Main 24, WIS  
468 76 245 81604 000 000 001

Attached is a utility easement received in connection with the subject project.

Please place the attached instrument on the agenda for Subdivision Committee consideration. Upon approval by the City, I would appreciate a copy of the recorded instrument for our file.

/JLL:ms  
Attachment

*Larry and Valerie Spike grant a utility easement in an area north of Central and west of Gatewood.*

**RECEIVED**

JAN 06 1987

METROPOLITAN PLANNING

ROUTE  \_\_\_\_\_  
 \_\_\_\_\_

6048 B

17  
T375  
R2E

*For 1/29/87  
SID mly.*