

D-1505 - Cherry Creek Development, Inc.
dedicates right-of-way, located on the
east side of Webb Road, in an area
north of Pawnee.

posted 3-10-88

OK

KE

1015

ACTION

| | DATE |
|------------------|----------------|
| S/D COMMITTEE | <u>3/24/88</u> |
| M.A.P.C. | <u>3/31/88</u> |
| W.C.C./B. CO. C. | <u>4/20/88</u> |

Sent to Weber 4/1/88 for processing
through the G. Commission

FW

MAP NO. 6145 C
SEC. NO. 33
TWP. NO. 27S
RANGE 2E

DEDICATION REPORT AND PROGRESS

CASE NO.: D-1505

ASSOCIATED CASE: CoBZA 1-88
6 2-88

I. OFFER TO DEDICATE: Right-of-way.

GENERALLY LOCATED: On the east side of Webb Road, in an area north of Pawnee.

LEGALLY DESCRIBED AS:

The west fifty (50) feet of a tract in the SW $\frac{1}{4}$ of Section 33, Township 27 South, Range 2 East of the 6th P.M., Sedgwick County, Kansas, described as commencing at the southwest corner of said SW $\frac{1}{4}$; thence north along the west line of said SW $\frac{1}{4}$, 337 feet for a place of beginning; thence north along the west line of said SW $\frac{1}{4}$, 100 feet; thence east with a deflection angle to the right of 89° 58', 435.6 feet; thence south, parallel with the west line of said SW $\frac{1}{4}$, 100 feet; thence west 435.6 feet to the place of beginning.

DEDICATED BY: Cherry Creek Development, Inc.

PURPOSE OF DEDICATION:

Requirement of CoBZA 1-88 & 2-88.

II. SKETCH.

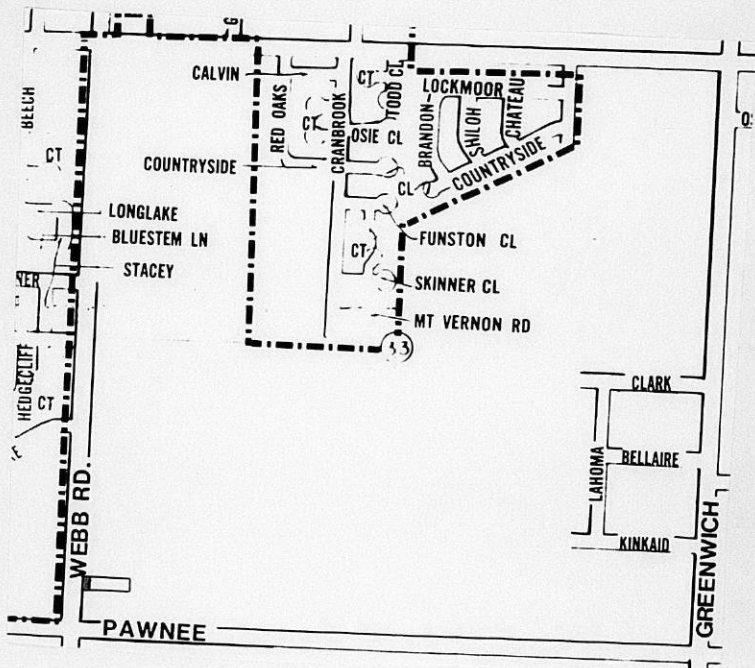

III. FILED 3/2/88
POSTED TO ATLAS
S/D COMM. ACTION 3/24/88 *approved*
M.A.P.C. ACTION 3/31/88 *approved*

B.C.C. ACTION _____
PLACED ON RECORD _____
CITY CLERKS NO. _____

WICHITA-SEDGWICK COUNTY
METROPOLITAN AREA PLANNING DEPARTMENT

Planning Jim W.
Forrest Louise
RECEIVED *DLH*
APR 4 3 21 PM '88
PUBLIC SERVICES

Date: April 1, 1988

TO: Jim Weber, Bureau of Public Services, Sedgwick County
FROM: Forrest L. Nagley, Senior Planner *FLN*
SUBJECT: Dedication Case D-1505

Attached is a dedication of additional right-of-way for Webb Road that was obtained as a condition of approval for two recent County Board of Zoning Appeal cases (Co. BZA 1-88 and 2-88). Please process the document through the County Commission.

Should you have any questions, please call.

FLN:dlk

Attachment

★ EXECUTED COPY ATTACHED FOR YOUR FILES.

DEDICATION DEED

KNOWN ALL MEN BY THESE PRESENTS:

That for and in consideration of the sum of One Dollar (\$1.00) and other good and valuable considerations, the receipt of which is hereby acknowledged, the undersigned, Cherry Creek Development, Inc.

being the owner _____ of the following described real estate in Sedgwick County, Kansas, to wit: The west fifty (50) feet of a tract in the SW $\frac{1}{4}$ of Section 33, Township 27 South, Range 2 East of the 6th P.M., Sedgwick County, Kansas, described as commencing at the Southwest corner of said SW $\frac{1}{4}$; thence north along the west line of said SW $\frac{1}{4}$, 337 feet for a place of beginning; thence north along the west line of said SW $\frac{1}{4}$, 100 feet; thence east with a deflection angle to the right of 89°58', 435.6 feet; thence south, parallel with the west line of said SW $\frac{1}{4}$, 100 feet; thence west 435.6 feet to the place of beginning.

Do hereby dedicate the above described real estate to the public for street or road purposes.

Executed this 24th day of February, 19 88.

ENTERED ON
TRANSFER RECORD
APR 22 1988
DON WRIGHT
COUNTY CLERK

Clifford A. Nies
Clifford A. Nies
Edythe S. Flynn
Edythe S. Flynn

STATE OF KANSAS)
SEDGWICK COUNTY) ss

BE IT REMEMBERED, That on this 24th day of February, 19 88, before me a Notary Public in and for the said County and State came Cherry Creek Development, Inc., Clifford A. Nies, President, and Edythe S. Flynn

IN WITNESS WHEREOF, I have hereunto subscribed my name and affixed my Notarial Seal, on day and year last above written.

MILDRED E. FRANZ
NOTARY PUBLIC
STATE OF KANSAS

Mildred E. Franz
NOTARY PUBLIC
Mildred E. Franz

My appointment expires February 3, 1991

SUBMITTED TO THE OFFICE OF COUNTY ENGINEER AND THE BOARD OF COUNTY COMMISSIONERS FOR APPROVAL ON April 20, 1988.

APPROVED BY

David C. Spears
David C. Spears, P.E.

Mark F. Schroeder
Mark F. Schroeder

DIRECTOR, BUREAU OF PUBLIC SERVICES/
COUNTY ENGINEER

CHAIRMAN

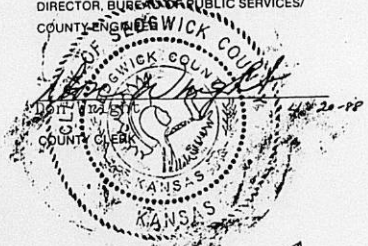

STATE OF KANSAS
SEDGWICK COUNTY
FILED FOR RECORD AT
8:00 A.M.

APR 22 1988
9 43062

NO. PAT KETTLER
REGISTER OF DEEDS

MICROFILMED
OF RECORD

County Clerk

*WILMOT-SEDFWICK COUNTY
METROPOLITAN AREA PLANNING DEPARTMENT*

Date: April 1, 1988

*TO: The Mayor, Bureau of Public Services, Sedgwick County
FROM: Forrest L. Hagley, Senior Planner
SUBJECT: Redication Case D-1805*

*Attached is a certification of additional right-of-way for Webb Road that was
submitted as a condition of approval for two recent County Board of Zoning
Appeals cases (i.e. RZA 1-88 and 2-88). Please process the document
through the County Commission.*

Should you have any questions, please call.

*FORREST L. HAGLEY
Senior Planner*

RECEIVED

D-1505

DEDICATION DEED

KNOWN ALL MEN BY THESE PRESENTS:

That for and in consideration of the sum of One Dollar (\$1.00) and other good and valuable considerations, the receipt of which is hereby acknowledged, the undersigned, Cherry Creek Development, Inc.

copy

being the owner _____ of the following described real estate in Sedgwick County, Kansas, to wit: The west fifty (50) feet of a tract in the SW $\frac{1}{4}$ of Section 33, Township 27 South, Range 2 East of the 6th P.M., Sedgwick County, Kansas, described as commencing at the Southwest corner of said SW $\frac{1}{4}$; thence north along the west line of said SW $\frac{1}{4}$, 337 feet for a place of beginning; thence north along the west line of said SW $\frac{1}{4}$, 100 feet; thence east with a deflection angle to the right of 89°58', 435.6 feet; thence south, parallel with the west line of said SW $\frac{1}{4}$, 100 feet; thence west 435.6 feet to the place of beginning.

Do hereby dedicate the above described real estate to the public for street or road purposes.

Executed this 24th day of February, 19 88.

Clifford A. Nies
Edythe S. Flynn

STATE OF KANSAS)
SEDGWICK COUNTY) ss

BE IT REMEMBERED, That on this 24th day of February, 19 88, before me a Notary Public in and for the said County and State came Cherry Creek Development, Inc., Clifford A. Nies, President, and Edythe S. Flynn

IN WITNESS WHEREOF, I have hereunto subscribed my name and affixed my Notarial Seal, on day and year last above written.

MILDRED E. FRANZ
NOTARY PUBLIC
STATE OF KANSAS

Mildred E. Franz
NOTARY PUBLIC
Mildred E. Franz

My appointment expires February 3, 1991

SUBMITTED TO THE OFFICE OF COUNTY ENGINEER AND THE BOARD OF COUNTY COMMISSIONERS FOR APPROVAL ON _____.

APPROVED BY

DIRECTOR, BUREAU OF PUBLIC SERVICES/
COUNTY ENGINEER

CHAIRMAN

COUNTY CLERK