

D-1509 - Gerald W. Fisher dedicates street right-of-way, located in an area just north of Maple Street, ON THE EAST SIDE of Kessler.

52170

ACTION

DATE 4/21/88

approved

S/D COMMITTEE

4/28/88

approved

M.A.P.C.

5/24/88

Approved

W.C.C./B-60. C.

D-1509 - Gerald W. Fisher dedicates
street right-of-way, located in an area
just north of Maple Street, **ON THE EAST
SIDE OF KESSLER.**

posted 4-14-88 KGL ✓

01179

MAP NO. 5247 C
 SEC. NO. 24
 TWP. NO. 27S
 RANGE 1W

DEDICATION REPORT AND PROGRESS

CASE NO.: D-1509

ASSOCIATED CASE:

Required by CID for issuance of a building permit

1. OFFER TO DEDICATE: Street right-of-way for Kessler Street.

GENERALLY LOCATED: In an area just north of Maple, on the east side of Kessler.

LEGALLY DESCRIBED AS:

The west 10 feet of a tract of land located in the SW $\frac{1}{4}$ section of Section 24, Township 27 South, Range 1 West of the 6th P.M. described as follows:

Beginning at a point 522 feet south of the southwest corner of Lot 8, Kessler's Park Addition, Sedgwick County, Kansas; thence south 50 feet parallel to the west line of said SW $\frac{1}{4}$, thence east 200 feet parallel to the south line of said SW $\frac{1}{4}$, thence north 50 feet parallel to the west line of said SW $\frac{1}{4}$, thence west 200 feet parallel to the south line of said SW $\frac{1}{4}$ to the point of beginning.

DEDICATED BY: Gerald W. Fisher

PURPOSE OF DEDICATION:

II. SKETCH.

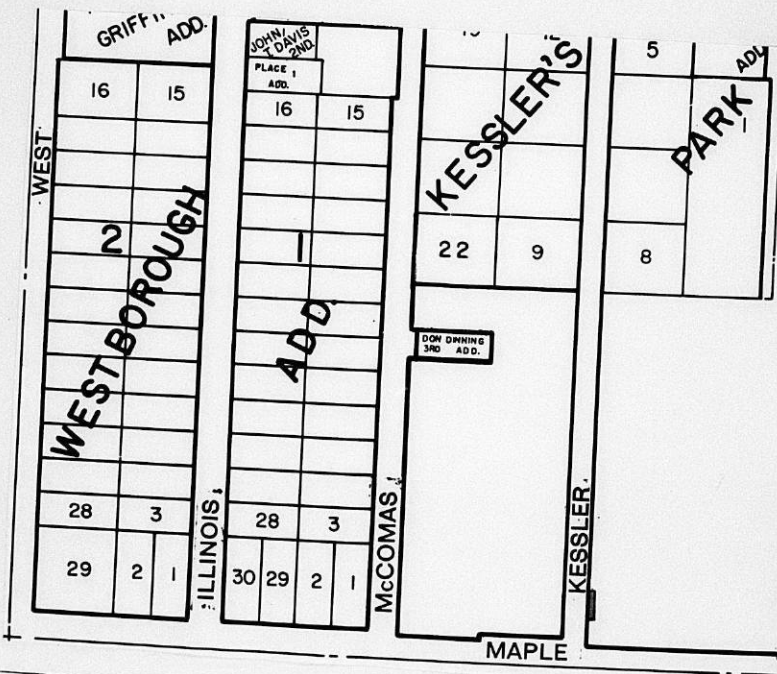

III. FILED _____
 POSTED TO ATLAS 4/3/88
 S/D COMM. ACTION 4/21/88
 M.A.P.C. ACTION _____

B.C.C. ACTION 5-24-88 *Approved*
 PLACED ON RECORD _____
 CITY CLERKS NO. _____

Planning Agenda Item # _____

City of Wichita
City Council Meeting
May 24, 1988

Agenda Report # _____

TO: Mayor and City Council Members

SUBJECT: D-1509 - DEDICATION OF ADDITIONAL STREET RIGHT-OF-WAY FOR
KESSLER STREET, LOCATED ON THE EAST SIDE OF KESSLER, IN AN
AREA NORTH OF MAPLE.

INITIATED BY: Metropolitan Area Planning Department

AGENDA ACTION: Planning

MAPC Recommendation: Accept the dedication. (unanimous)

Background: Gerald Fisher is dedicating this additional street right-of-way to satisfy a condition of approval for the issuance of a building permit.

Financial Considerations: Bill the recording costs to:
755-68-360-50000-295-000-000

Recommendations/Actions: Accept the dedication and record document.

PL/8528/5

DEDICATION

KNOW ALL MEN BY THESE PRESENTS:

That for and in consideration of the sum of One Dollar (\$1.00) and other good and valuable considerations, the receipt of which is hereby acknowledged, the undersigned, Gerald W. Fisher

being the owner of the following described real estate in Sedgwick County, Kansas, to wit:

The west 10 feet of a tract of land located in the SW $\frac{1}{4}$ section of Section 24, Township 27 South, Range 1 West of the 6th PM described as follows:

Beginning at a point 522 feet south of the southwest corner of Lot 8, Kessler's Park Addition, Sedgwick County, Kansas; thence south 50 feet parallel to the west line of said SW $\frac{1}{4}$, thence east 200 feet parallel to the south line of said SW $\frac{1}{4}$, thence north 50 feet parallel to the west line of said SW $\frac{1}{4}$, thence west 200 feet parallel to the south line of said SW $\frac{1}{4}$ to the point of beginning.

do hereby dedicate the above-described real estate to the public for street right-of-way purposes.

Executed this 3rd day of April, 1988.

Gerald W. Fisher

STATE OF KANSAS) SEDGWICK COUNTY) 55

BE IT REMEMBERED, that on this 3 day of April 1988, came Gerald W. Fisher

to me personally known to be the same person who executed the foregoing instrument and duly acknowledged the execution of the same.

IN WITNESS WHEREOF, I have hereunto subscribed my name and affixed my official seal, the day and year last above-written.

Submitted to the Wichita-Sedgwick County Metropolitan Area Planning Commission and the Board of Commissioners of the City of Wichita, Kansas, and approved by said Board of Commissioners of the City of Wichita, Kansas,

this _____
City Clerk

Marvin M. Hater
Notary Public

My Commission Expires: June 28, 1988



IMPORTANT MESSAGE

FOR FOREST NAGLEY
DATE 4-APRIL TIME _____ A.M.
P.M.

WHILE YOU WERE AWAY

MR. AS REQUESTED COPY OF
OF MEMO & SIGNED DEDICATION
PHONE NO. FOR STREET R.O.W.

TELEPHONED	PLEASE CALL HIM
CALLED TO SEE YOU	WILL CALL AGAIN
WANTS TO SEE YOU	RETURNED YOUR CALL

MESSAGE ON 230 S. KESSLER.
BUILDING PERMIT HAS BEEN
ISSUED THIS DATE

SIGNED Michael Bell, C.I.D.
Phone 2421

THE CITY OF WICHITA

OFFICE OF Central Inspection

DATE March 29, 1988

TO Jack Galbraith, Chief Planner of Current Plans

FROM Monty H. Robson, Superintendent of CID

MHR
SUBJECT Building Permit
203 S. Kessler
(Copy attached)
Subdivision regulations
Article 4, Part 6, 4-601

A request for a permit to erect an accessory structure at subject address has been submitted to CID.

The property cannot be exempt per Article 3, 3-105(F)(I) of the Subdivision Regulations. A 40' right-of-way exists on Kessler. Will the owner be required to plat or dedicate the right-of-way. A timely response will be appreciated.

MHR/MG/wgm
Attachment

*Need 10 more feet to meet
required half-street R.O.W.
Standard.*

*Dedication instrument
is attached.*

FEN

*East side of Kessler, in an area
north of Maple.*

*5247C
24
7275
R1W*

RECEIVED

MAR 30 1988

METROPOLITAN PLANNING

ROUTE _____

Bill Fisher Owner

~~203 S. Kessler~~
230

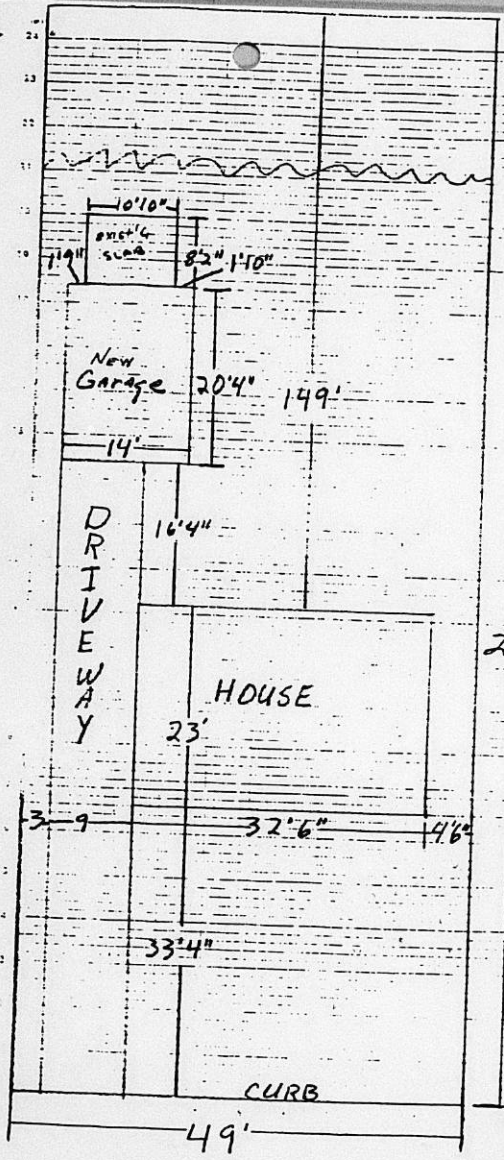

205'4"

LEGAL DESCRIPTION:

BEGINNING 522' SOUTH OF
THE SOUTHWEST CORNER OF
LOT 8, KESSLER PARK ADDITION;
SOUTH 150', EAST 200',
NORTH 50', WEST 200'
TO BEGINNING, SOUTHWEST
1/4 SECTION 24, 27-1W.

KESSLER