

City of Wichita
City Commission Meeting
February 18, 1986

Agenda Report # _____

TO: Mayor and City Commissioners

SUBJECT: V-1361 - VACATION OF PORTIONS OF HI-TECH INDUSTRIAL
PARK, LOCATED EAST OF ROCK ROAD, IN AN AREA NORTH OF
37TH STREET NORTH.

INITIATED BY: Metropolitan Area Planning Department

AGENDA ACTION: Planning

MAPC Recommendation: Approve vacation of portions of Hi-Tech Industrial Park.

Background: Woodlawn Development Company, c/o Classic Reality, 151 North Main, #300, Wichita, KS 67202, has requested this vacation to satisfy a requirement of the associated plat of Hi-tech Industrial Park Second Addition.

Analysis: The Planning Commission recommends the City Commission find: (1) that no private rights will be injured or endangered; and (2) the public will suffer no loss or inconvenience by granting by order the vacation, subject to:

1. Proper publication of notice of public hearing;
2. The absence of proper written protest filed with the City Clerk;
3. All proceedings being without cost to the City, County or any utility company; and
4. The applicant shall submit a signed Vacation Petition.

Legal Considerations: The City Clerk certifies as to proper notification and no filing of written protest.

Recommendations/Action: Close public hearing, approve vacation, authorize the Mayor to sign the Vacation Order, and record certified copy of Order, recording costs to be billed to owner.

BEFORE THE BOARD OF CITY COMMISSIONERS
OF THE CITY OF WICHITA, SEDGWICK COUNTY, KANSAS

IN THE MATTER OF THE VACATION OF A PORTION OF)
HI-TECH INDUSTRIAL PARK.)

GENERALLY LOCATED EAST OF ROCK ROAD, IN AN)
AREA NORTH OF 37TH STREET NORTH. (V-1361))

MORE FULLY DESCRIBED BELOW)

Approved by Board of Commissioners

this FEB 18 1986
STATE OF KANSAS
SEDGWICK COUNTY
FILED FOR RECORD AT
1:00 P.M.

MICROFILMED
OF RECORD

VACATION ORDER

Ed Peral
Deputy

FEB 21 1986
7 91129

PAT KETTLER
Register of Deeds

NOW on this 18th day of February, 1986, comes on for hearing the petition for vacation filed by Woodlawn Development Company, praying for the vacation of the following described portion of Hi-Tech Industrial Park, to-wit:

Beginning at the northwest corner of Hi-Tech Industrial Park, an addition to Wichita, Sedgwick County, Kansas; thence along the northerly line of said addition bearing N 89°15'45" E, 199.47 feet; thence S 33°55'43" E, 460.00 feet; thence S 0°44'15" E, 165.00 feet; thence N 89°16'40" E, 193.60 feet; thence S 65°37'15" W, 338.73 feet; thence S 21°52'45" E, 522.00 feet; thence S 30°49'53" W, 104.39 feet; thence N 85°44'15" W, 470.00 feet to a point on the east line of Rock Road as platted in said addition; thence northerly along said east line bearing N 0°44'15" W, 1220.68 feet to the point of beginning.

AND ALSO:

Beginning at the northeast corner of said Hi-Tech Industrial Park said point also being the beginning of a curve to the right; thence along said curve a distance of 35.06 feet, said curve having a radius of 315.00 feet, a chord bearing S 4°00'28" E, and a length of 35.04 feet; thence continuing along the east line of said addition bearing S 0°49'09" E, 99.77 feet; thence S 77°37'15" W, 806.49 feet; thence N 64°52'45" W, 360.00 feet; thence N 51°22'45" W, 222.06 feet to a point on the north line of said addition; thence easterly along said north line bearing N 89°16'40" E, 1283.41 feet to the point of beginning. (V-1361)

The City Commission, after being duly and fully informed as to fully understand the true nature of this petition and the propriety of granting the same, makes the following findings:

1. That due and legal notice has been given by publication as required by law, by publication in the Daily Record of notice of this vacation proceeding for consecutive weeks on FEB 5 & 12, 1986.
2. No private rights will be injured or endangered by the vacation of the above-described portion of Hi-Tech Industrial Park, and the public will suffer no loss or inconvenience thereby.
3. In justice to the petitioner(s) the prayer of the petition ought to be granted.
4. No written objection to said vacation has been filed with the City Clerk by any owner or adjoining owner who would be a proper party to the petition.
5. The vacation of the portion of Hi-Tech Industrial Park described herein should be approved.

IT IS, THEREFORE, BY THE BOARD OF CITY COMMISSIONERS, on this 18th day of February, 1986, ordered that the above-described portion of Hi-Tech Industrial Park Addition is hereby vacated. IT IS FURTHER ORDERED that the City Clerk shall certify a copy of this order to the Register of Deeds of Sedgwick County.

ATTEST:
Donald C. Cisick
Donald C. Cisick, City Clerk

R. C. Brown
R. C. Brown, Mayor

Approved as to Form:
John Dekker
John Dekker, Director of Law

City Clerk

10000

ROCK

37th St. No.

RES A
(FLOODWAY)

HI-TECH

DUBLIN

INDUSTRIAL

TARA

PARK

COMOTARA ST.

NORTH
POINT
INDUSTRIAL
PARK

RESERVE 'C'

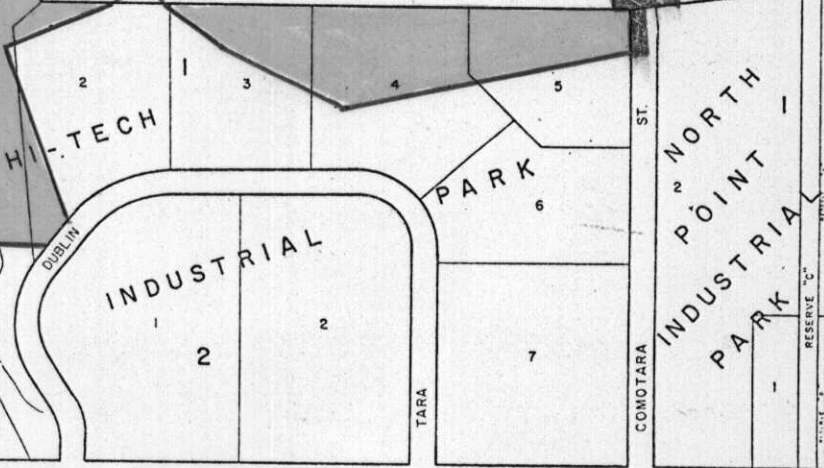

The vacation of this
Street R.O.W. was
deleted from vac.
request.