



METROPOLITAN AREA PLANNING
DEPARTMENT
CITY HALL — TENTH FLOOR
455 NORTH MAIN STREET
WICHITA, KANSAS 67202-1688
(316) 268-4561

May 26, 1989

Baughman Company
315 S. Ellis
Wichita, KS 67211

Re: V-1608 - Request to vacate platted emergency access and utility easements, located in an area west of Maize Road and north of Central

Dear Gentlemen:

At the May 25, 1989, meeting of the Metropolitan Area Planning Commission, the above-referenced vacation request was approved subject to the conditions recommended by the Subdivision Committee and stated in our May 19, 1989, letter. This case will be scheduled for final public hearing before the Wichita City Council after all conditions in our letter of May 19, 1989, have been completed.

If you have any questions about this matter, please call.

Sincerely,

R. Timothy Bickhaus
Associate Planner

RTB:ksk

Enclosure

cc: Floyd D. DeWitt, etux, 3930 W. 29th St. So., Suite 5,
Wichita, KS 67217
Mike Lindebak, City Engineer

SEDGWICK COUNTY



METROPOLITAN AREA PLANNING
DEPARTMENT

CITY HALL — TENTH FLOOR
455 NORTH MAIN STREET
WICHITA, KANSAS 67202-1688
(316) 268-4561

May 19, 1989

Baughman Company
315 S. Ellis
Wichita, KS 67211

Re: V-1608 - Request to vacate platted emergency access and
utility easements, located in an area west of Maize Road
and north of Central

Dear Gentlemen:

At the regular meeting of the Subdivision Committee of the
Metropolitan Area Planning Commission, Thursday, May 18, 1989,
the above-captioned vacation request was considered. The action
of the Committee was to recommend that this vacation be approved
subject to:

- A. Any relocation of utilities necessitated by this vacation
shall be at the sole expense of the applicant.
- B. The applicant shall grant substitute utility easements and an
emergency access easement to replace those being vacated by
this case. This easement has been submitted, however; the
substitute easement legal description shall be corrected as
requested by City Engineering.
- C. The applicant shall provide a letter from Multi-Media
Cablevision stating that satisfactory arrangements have been
made with regard to any relocation of utilities in the
easement.

This matter will be forwarded to the Planning Commission for its
consideration on Thursday, May 25, 1989 at 1:30 p.m.

If you have any questions, please call.

Sincerely,

R. Timothy Bickhaus
Associate Planner

RTB:svm

cc: Floyd D. DeWitt, etux, 3930 W. 29th St. So., Suite 5,
Wichita, KS 67217
Mike Lindebak, City Engineer

FILE COPY

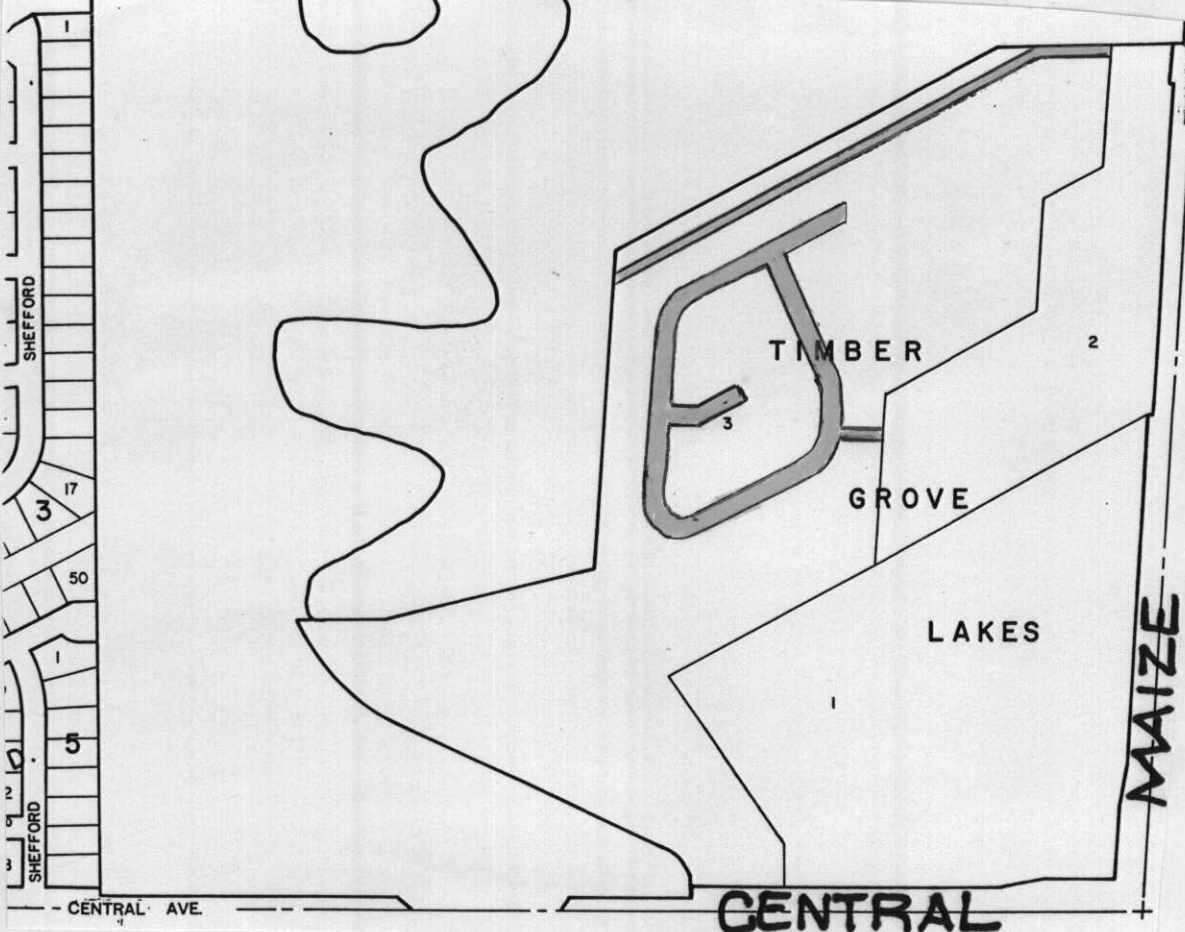

SHEFFORD

1

17

3

50

1

5

SHEFFORD

1
2
3

CENTRAL AVE.

TIMBER

2

3

GROVE

LAKES

1

MAIZE RD.

MAIZE

CENTRAL