

Planning Agenda Item # _____

City of Wichita
City Council Meeting
January 8, 1990

Agenda Report # _____

TO: Mayor and City Council Members

SUBJECT: PUBLIC HEARING V-1689 - REQUEST TO VACATE PLATTED MINIMUM
BUILDING PAD ELEVATIONS.
(District #2)

INITIATED BY: Metropolitan Area Planning Department

AGENDA ACTION: Planning

Staff Recommendation: Approve vacation of minimum building pads.

MAPC Recommendation: Approve vacation of minimum building pads.
(unanimous)

Background: The applicant is seeking a vacation of minimum building pads because ground elevations and structures located in this area are at least one foot or higher than, or outside the area affected by, the 100 year flood. The City Engineering Department has indicated its approval of the vacation. The vacation request has been reviewed and approved by the Planning Commission, subject to conditions.

Legal Considerations: The City Clerk needs to certify as to proper notification and no filing of written protest.

Recommendations/Action: Close public hearing, approve vacation; authorize the Mayor to sign the Vacation Order; and record certified copy of Order, recording costs to be billed to:

150029-2909

Approved & Accepted By City Council
JAN 8 1991

BEFORE THE CITY COUNCIL OF THE
CITY OF WICHITA, SEDGWICK COUNTY, KANSAS

IN THE MATTER OF THE VACATION OF)
PLATTED MINIMUM BUILDING PAD ELEVATIONS)
(V-1689))
GENERALLY LOCATED NORTH OF 29TH STREET)
NORTH AND EAST OF WOODLAWN)
MORE FULLY DESCRIBED BELOW)

FILED IN DEEDS BOOK
SEDGWICK COUNTY
FILED FOR RECORD AT
8:00 AM

FEB 7 91 1118829

W. J. LER
REGISTER OF DEEDS

W. J. Ler
Register of Deeds

MICROFILMED
OF RECORD

VACATION ORDER

NOW on this 8th day of January, 1991, comes on for hearing the petition for vacation filed by Joe Lee, praying for the vacation of the following described minimum building pad elevations, to-wit:

Vacation of minimum building pad elevations as platted on part of Lot 1, Allen's Farm, an Addition to Wichita, Sedgwick County, Kansas, legally described as:

A tract of land lying in the southwest quarter, Section 31, Township 26 South, Range 2 East of the 6th P.M., Sedgwick County, Kansas, more particularly described as follows:

Beginning at the southeast corner of Lot 1 Allens Farm, an addition to Wichita, Sedgwick County, Kansas; thence S 88°55'01"W, 104.00 feet along the south line of said Lot 1 thence; N01°14'30"W, 149.96 feet; thence; N21°30'00"W, 101.61 feet; thence N48°05'48"E, 80.75 feet; thence N41°14'30"W, 125.12 feet; thence N18°45'30"E, 63.86 feet; thence N61°14'30"W, 77.26 feet; thence S28°45'30"W, 75.77 feet; thence N 71°25'00"W, 150.06 feet; thence S62°21'45"W, 147.95 feet; thence N75°25'16"W, 74.77 feet; thence N26°09'04"W, 185.21 feet; thence S61°31'35"W, 94.98 feet; thence N 24°15'10"W, 158.76 feet to the north line of said Lot 1; thence N88°55'01"E, 100.95 feet along the north line of said Lot , to a point on a curve to the left; thence along said curve 129.71 feet, said curve having a central angle of 30°00'00", a radius of 247.73 feet, and a long chord of 128.23 feet, bearing N73°55'01"E; thence N58°55'01"E, 90.00 feet to a point on a curve to the right; thence along said curve 69.61 feet, said curve having a central angle of 30°00'00", a radius of 132.94 feet, and a long chord of 68.81 feet, bearing N73°55'01"E; thence

8.00
ck

City Clerk

Vacation Order
V-1689
Page 2 of 2

N88°55'01"E, 233.93 feet to a point on a curve to the right; thence along said curve 67.45 feet, said curve having a central angle of 44°50'29", a radius of 86.18 feet, and a long chord of 65.74 feet, bearing S68°39'44"E; thence S46°14'30"E, 172.86 feet to a point on a curve to the right; thence along said curve 67.32 feet, said curve having a central angle of 45°00'00", a radius of 85.71 feet, and a long chord of 65.60 feet, bearing S23°44'30"E; thence S01°14'30"E, 589.46 feet to the point of beginning.

The City Council, after being duly and fully informed as to fully understand the true nature of this petition and the propriety of granting the same, makes the following findings:

1. That due and legal notice has been given by publication as required by law, by publication in the Daily Reporter of notice of this vacation proceeding for consecutive weeks on 12/21/90 & 12/28/90.
2. No private rights will be injured or endangered by the vacation of the above-described minimum building pad elevations, and the public will suffer no loss or inconvenience thereby.
3. In justice to the petitioner(s), the prayer of the petition ought to be granted.
4. No written objection to said vacation has been filed with the City Clerk by any owner or adjoining owner who would be a proper party to the petition.
5. The vacation of the minimum building pad elevations described herein should be approved.

IT IS, THEREFORE, BY THE CITY COUNCIL, on this 8th day of January, 1991, ordered that the above-described minimum building pad elevation is hereby vacated. IT IS FURTHER ORDERED that the City Clerk shall certify a copy of this order to the Register of Deeds of Sedgwick County.

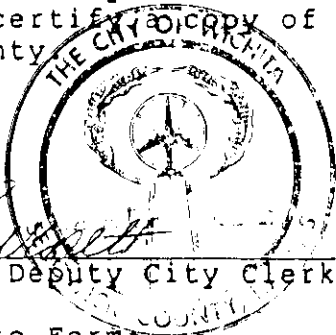

ATTEST:

Pat Burnett
Pat Burnett, Deputy City Clerk

Approved as to Form:

Thomas Powell
Thomas Powell, Director of Law

Bob Knight
Bob Knight, Mayor

State of Kansas)
Sedgwick County) ss
City of Wichita)
I, Pat Burnett, Deputy City Clerk of the City of Wichita, Kansas, do hereby certify that the document to which this is attached is a true and correct copy of the original as the same appears to me the City Clerk.
Given under my hand and seal of the City of Wichita, Kansas, this JAN 8 1991
Pat Burnett Deputy City Clerk



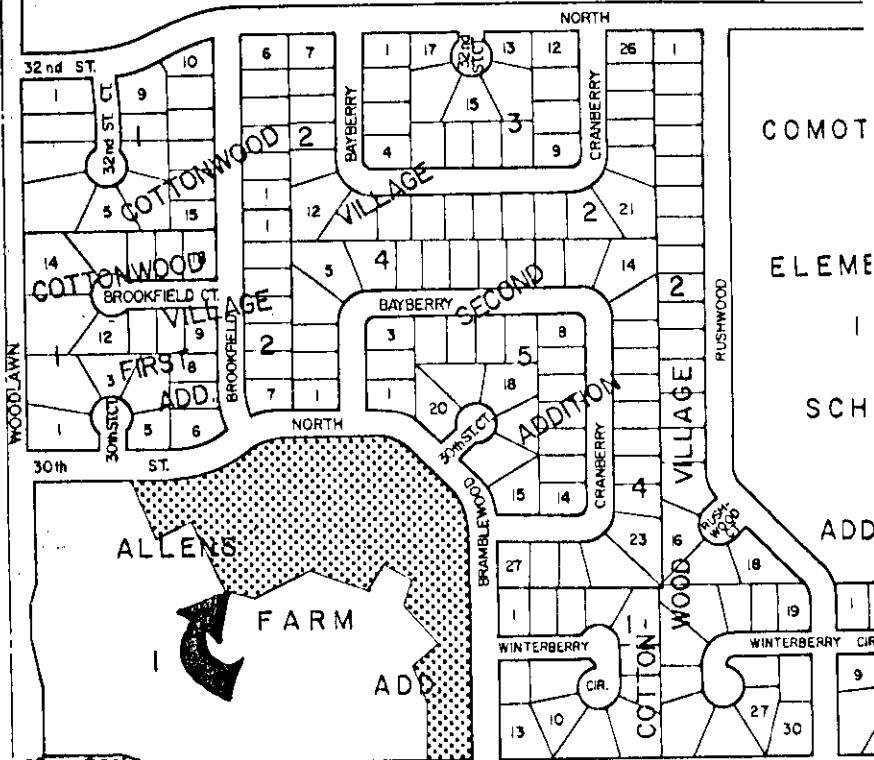

32nd ST.

NORTH

32nd ST. CT.

COTTONWOOD VILLAGE

BAYBERRY VILLAGE

COTTONWOOD VILLAGE

BROOKFIELD CT.

VILLAGE

BAYBERRY

SECOND ADDITION

FIRST ADD.

NORTH

30th ST. CT.

CRANBERRY VILLAGE

RUSHWOOD

COMOT

ELEM

SCH

ADD

ALLENS

FARM

ADD

BRAMBLEWOOD

WINTERBERRY

CIR.

WOOD

WINTERBERRY CIR

29th St. No.